

EXIST. CURVE DATA
 PI STA. = 85+82.72
 Δ = 11° 26' 00" (RT)
 D = 1° 15' 00"
 R = 4,584.09'
 T = 458.90'
 L = 914.75'
 E = 22.91'
 P.C. STA. = 81+23.82
 P.T. STA. = 90+38.58
 e = 2.5%
 ATTAIN SUPER
 STA. 80+86 TO STA. 81+60
 REMOVE SUPER
 STA. 90+01 TO STA. 90+75

PROP. S.E. DATA
 e = 2.5%
 T.R. = 40'
 S.E. RUN = 66'

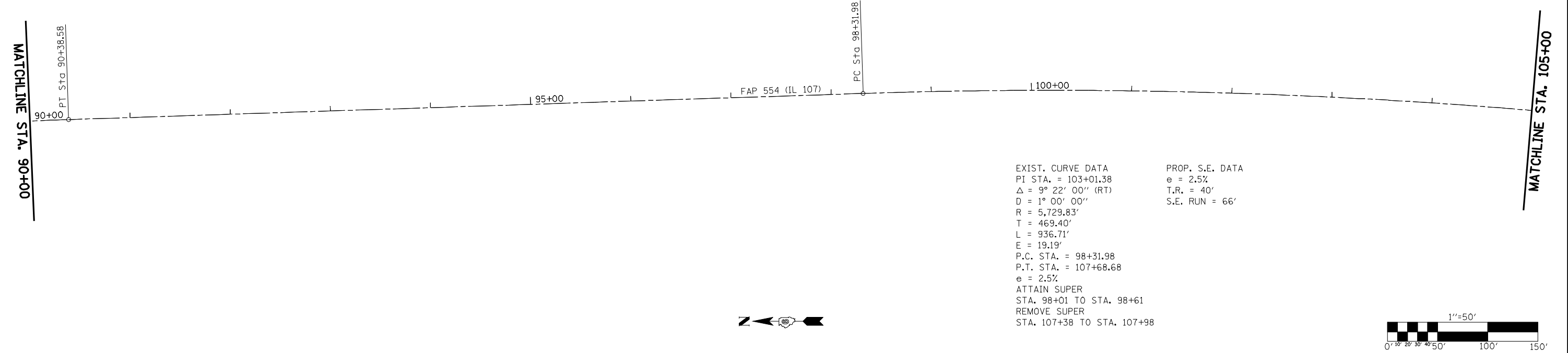
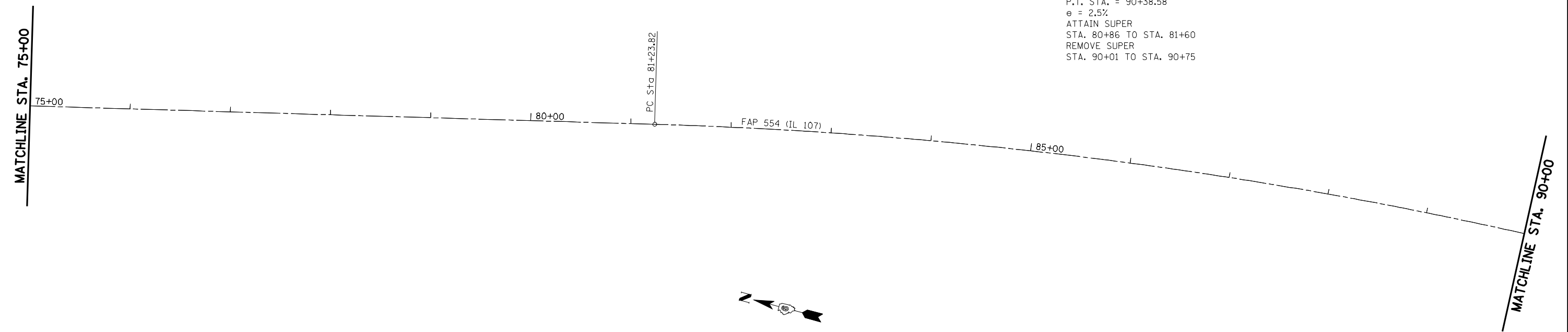

EXIST. CURVE DATA
 PI STA. = 103+01.38
 Δ = 9° 22' 00" (RT)
 D = 1° 00' 00"
 R = 5,729.83'
 T = 469.40'
 L = 936.71'
 E = 19.19'
 P.C. STA. = 98+31.98
 P.T. STA. = 107+68.68
 e = 2.5%
 ATTAIN SUPER
 STA. 98+01 TO STA. 98+61
 REMOVE SUPER
 STA. 107+38 TO STA. 107+98

PROP. S.E. DATA
 e = 2.5%
 T.R. = 40'
 S.E. RUN = 66'

FILE NAME = e:\pwwork\PIWIDOT\LAUGHLINRL\0200040\672C37-shr-plan.dgn	USER NAME = laughlinr1	DESIGNED -	REVISED -
Johnson, Depp & Quisenberry CONSULTING ENGINEERS Springfield, Illinois	PLOT SCALE = 100.0000' / IN. PLOT DATE = Apr-08-2010 03:18:48PM	DRAWN -	REVISED -
		CHECKED -	REVISED -
		DATE -	REVISED -

**STATE OF ILLINOIS
 DEPARTMENT OF TRANSPORTATION**

PLAN SHEET FAP 554 (ILLINOIS 107)

SCALE: 1" = 50' SHEET NO. OF SHEETS STA. 75+00 TO STA. 105+00

F.A.P. RTE.	SECTION	COUNTY	TOTAL SHEETS	SHEET NO.
554	16(RS-6) & 18(RS-6)	BROWN	49	18
CONTRACT NO. 72C37				
ILLINOIS FED. AID PROJECT				