

EXIST. CURVE DATA
 PI STA. = 261+52.84
 Δ = 27° 40' 00" (LT)
 D = 1° 30' 00"
 R = 3,819.84'
 T = 940.60'
 L = 1,844.50'
 E = 114.10'
 P.C. STA. = 252+12.24
 P.T. STA. = 270+56.74
 e = 2.5%
 ATTAIN SUPER
 STA. 251+66 TO STA. 252+56
 REMOVE SUPER
 STA. 270+11 TO STA. 271+01

PROP. S.E. DATA
 e = 2.5%
 T.R. = 40'
 S.E. RUN = 66'

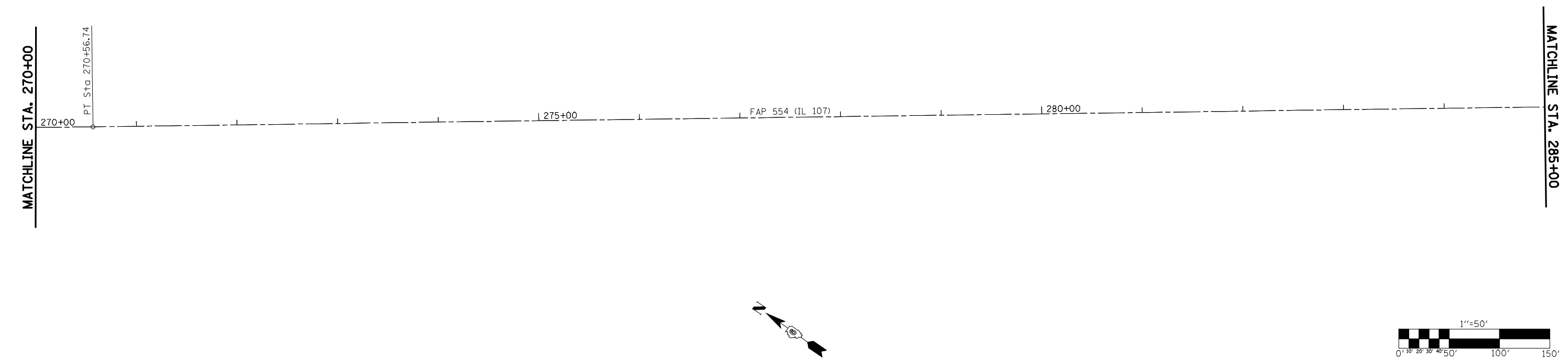
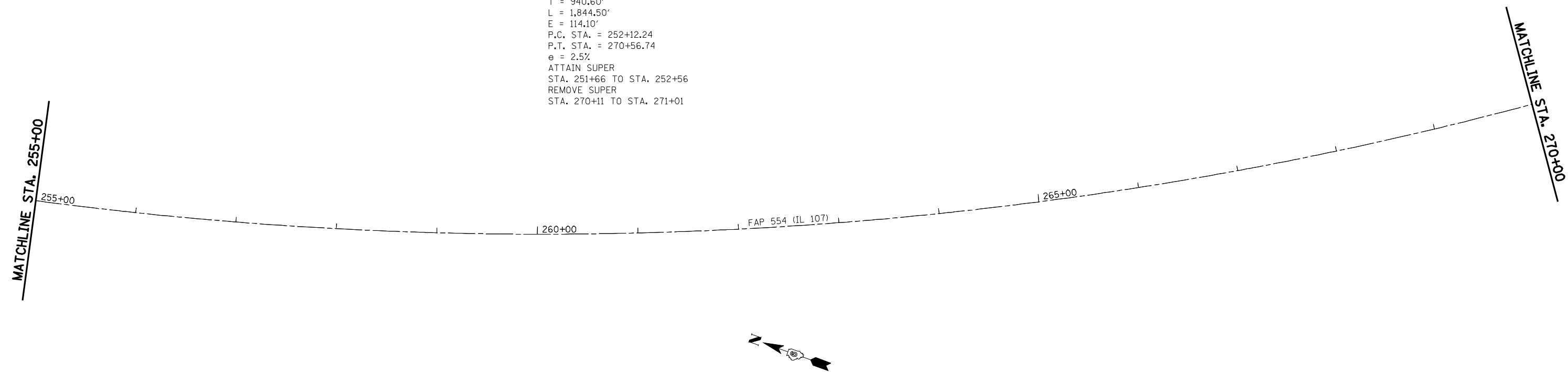

FILE NAME = e:\pwwork\pwidot\LAUGHLINRL\0200040\672C37-shr-plan.dgn	USER NAME = laughlinr1	DESIGNED -	REVISED -
Johnson, Depp & Quisenberry CONSULTING ENGINEERS Springfield, Illinois	PLOT SCALE = 100.0000' / IN. PLOT DATE = Apr-08-2010 03:19:26PM	DRAWN -	REVISED -
		CHECKED -	REVISED -
		DATE -	REVISED -

**STATE OF ILLINOIS
 DEPARTMENT OF TRANSPORTATION**

PLAN SHEET FAP 554 (ILLINOIS 107)

SCALE: 1" = 50' SHEET NO. OF SHEETS STA. 255+00 TO STA. 285+00

F.A.P. RTE.	SECTION	COUNTY	TOTAL SHEETS	SHEET NO.
554	16(RS-6) & 18(RS-6)	BROWN	49	24
CONTRACT NO. 72C37				
ILLINOIS FED. AID PROJECT				