

STATE OF ILLINOIS
DEPARTMENT OF TRANSPORTATION
DIVISION OF HIGHWAYS

**PROPOSED
HIGHWAY PLANS**

F.A.P. ROUTE 506 (IL. 96)
SECTION 123RS-5

ROADWAY RESURFACING SMART
HANCOCK COUNTY

C-96-034-09

F.A.P. RTE.	SECTION	COUNTY	TOTAL SHEETS	SHEET NO.
506	123RS-5	HANCOCK	14	1
		ILLINOIS	CONTRACT NO. 72C55	

FOR INDEX OF SHEETS AND HIGHWAY STANDARDS, SEE SHEET NO. 2

CURRENT TRAFFIC DATA

ADT 2600 (2009)
350 TRUCKS (13%)

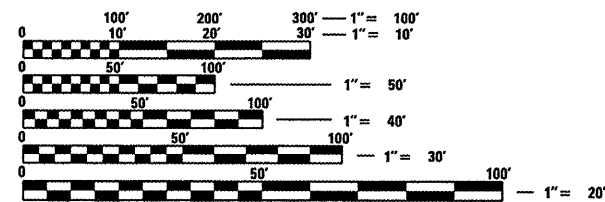
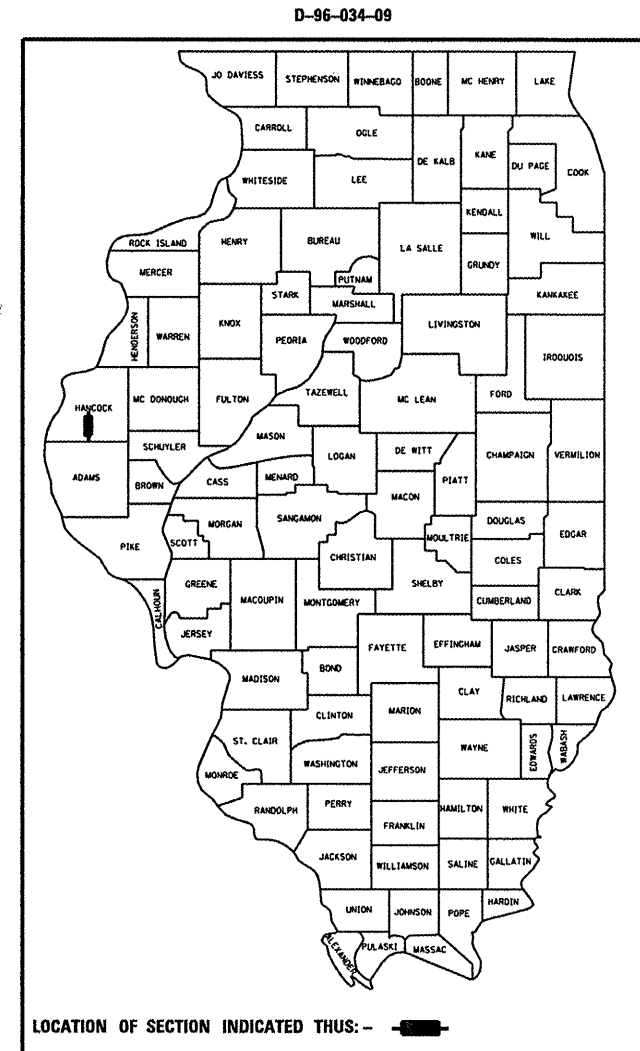

FULL SIZE PLANS HAVE BEEN PREPARED USING STANDARD ENGINEERING SCALES. REDUCED SIZED PLANS WILL NOT CONFORM TO STANDARD SCALES. IN MAKING MEASUREMENTS ON REDUCED PLANS, THE ABOVE SCALES MAY BE USED.

J.U.L.I.E.
JOINT UTILITY LOCATION INFORMATION FOR EXCAVATION
1-800-892-0123
OR 811

SQUAD LEADER: MARK DUST (217) 785-0597
PROJECT MANAGER: JOHN NEGANGARD (217) 782-6990

CONTRACT NO. 72C55

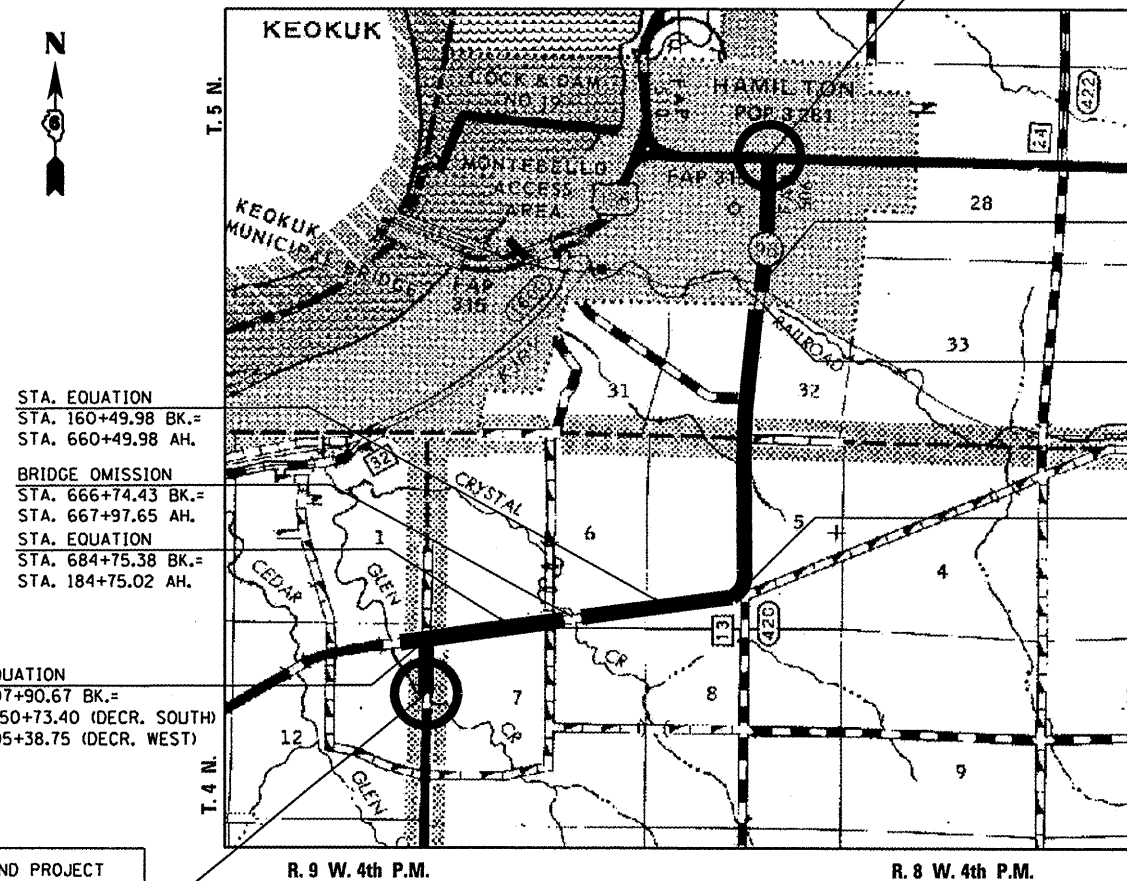

STA. EQUATION
STA. 160+49.98 BK.=
STA. 660+49.98 AH.

BRIDGE OMISSION
STA. 666+74.43 BK.=
STA. 667+97.65 AH.
STA. EQUATION
STA. 684+75.38 BK.=
STA. 184+75.02 AH.

STA. EQUATION
STA. 207+90.67 BK.=
STA. 1050+73.40 (DECR. SOUTH)
STA. 205+38.75 (DECR. WEST)

END PROJECT
STA. 1036+00.00
@ F.A.P. 506

BEGIN PROJECT
STA. 2+50.00
@ F.A.P. 506

STA. EQUATION
STA. 30+80.00 BK.=
STA. 30+77.60 AH.

OMISSION
STA. 34+00.00 TO
STA. 42+40.00

STA. EQUATION
STA. 128+91.79 BK.=
STA. 131+32.29 AH.

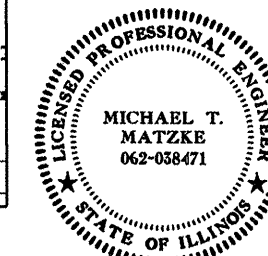

Michael T. Matzke
SIGNATURE
April 6, 2010
DATE
LIC. EXP. DATE: 11/30/2011

GROSS LENGTH = 22,635.00 FT. = 4.287 MILE
NET LENGTH = 22,079.47 FT. = 4.182 MILE

STATE OF ILLINOIS
DEPARTMENT OF TRANSPORTATION
DIVISION OF HIGHWAYS

SUBMITTED April 8 2010
Ry 2 Dmb
DEPUTY DIRECTOR OF HIGHWAYS, REGION ENGINEER

May 7 2010
Scott E. Stitt, P.E. /sl
ENGINEER OF DESIGN AND ENVIRONMENT

May 7 2010
Christine M. Reed /sl
DIRECTOR OF HIGHWAYS, CHIEF ENGINEER

**PRINTED BY THE AUTHORITY
OF THE STATE OF ILLINOIS**