

PRELIMINARY STAGE - SUGGESTED CONSTRUCTION SEQUENCE

REMOVE EXISTING BITUMINOUS SHOULDERS ALONG ALL FOUR QUADRANTS OF S.N. 084-0088 AS SHOWN IN THE PRE-STAGE PLANS. PROPOSED WIDTHS ARE CALLED OUT ON THE SHEETS. PLACE "MAX WIDTH" SIGNING AT THE REQUIRED LOCATIONS SHOWN IN THESE PLANS. SET UP STAGE 1 TRAFFIC CONTROL UTILIZING THESE PLANS IN CONJUNCTION WITH HIGHWAY STANDARD 701321. PLACE TEMPORARY CONCRETE BARRIER AND PAVEMENT MARKINGS (STOP BARS, LANE LINES, ETC.) IN ACCORDANCE TO THESE PLANS. INSTALL TEMPORARY SIGNALIZATION AND MICROWAVE DETECTION SYSTEMS AT THE LOCATIONS CALLED OUT ON THESE PLANS.

STAGE I - SUGGESTED CONSTRUCTION SEQUENCE

PERFORM STAGE 1 JOINT REMOVAL AND CONSTRUCTION FOR STRUCTURE (S.N. 084-0088).

STAGE II - SUGGESTED CONSTRUCTION SEQUENCE

FOLLOWING THE COMPLETION OF STAGE 1 CONSTRUCTION, RELOCATE TEMPORARY CONCRETE BARRIER WALL AND PLACE TEMPORARY PAVEMENT MARKING IN ACCORDANCE TO THESE PLANS. PERFORM STAGE 2 JOINT REMOVAL AND CONSTRUCTION FOR S.N. 084-0088.

TRAFFIC STAGING NOTES

SIGNS STATING "SIGNALS AHEAD" SHALL BE ERECTED DURING STAGE CONSTRUCTION BY THE CONTRACTOR AT LOCATIONS AS DIRECTED BY THE ENGINEER. THESE SIGNS ARE INCIDENTAL TO THE COST OF THE CONTRACT. THIS TRAFFIC CONTROL PLAN SHALL BE USED IN CONJUNCTION WITH STANDARD 701321 AND AS DIRECTED BY THE ENGINEER. ALL WORK REQUIRED TO SET UP, MAINTAIN, AND REMOVE TRAFFIC CONTROL AS DETAILED IN THESE PLANS SHALL BE INCLUDED IN THE COST FOR "TRAFFIC CONTROL AND PROTECTION, STANDARD 701321 (SPECIAL)". THE CONTRACTOR SHALL PLACE MAX WIDTH SIGNS BEFORE IMPLEMENTING ANY STAGE TRAFFIC CONTROL. THESE SIGNS SHALL BE INCLUDED IN THE COST OF "TRAFFIC CONTROL AND PROTECTION, STANDARD 701321 (SPECIAL)". TEMPORARY SIGNALING, TEMPORARY BARRIER WALL REFLECTORS, SHALL BE INSTALLED IN ACCORDANCE WITH STANDARD 701321 OR AS DIRECTED BY THE ENGINEER. THE CONTRACTOR SHALL NOTIFY DISTRICT 6 TRAFFIC SECTION OF THE BUREAU OF OPERATIONS (PH. 785-5836) AT LEAST ONE WEEK PRIOR TO IMPLEMENTING STAGE TRAFFIC CONTROL. THE CONTRACTOR SHALL NOTIFY THE DISTRICT 6 TRAFFIC SECTION OF THE BUREAU OF OPERATIONS (PH. 558-6523) AT LEAST THREE DAYS PRIOR TO ACTIVATING THE TEMPORARY TRAFFIC SIGNALS.

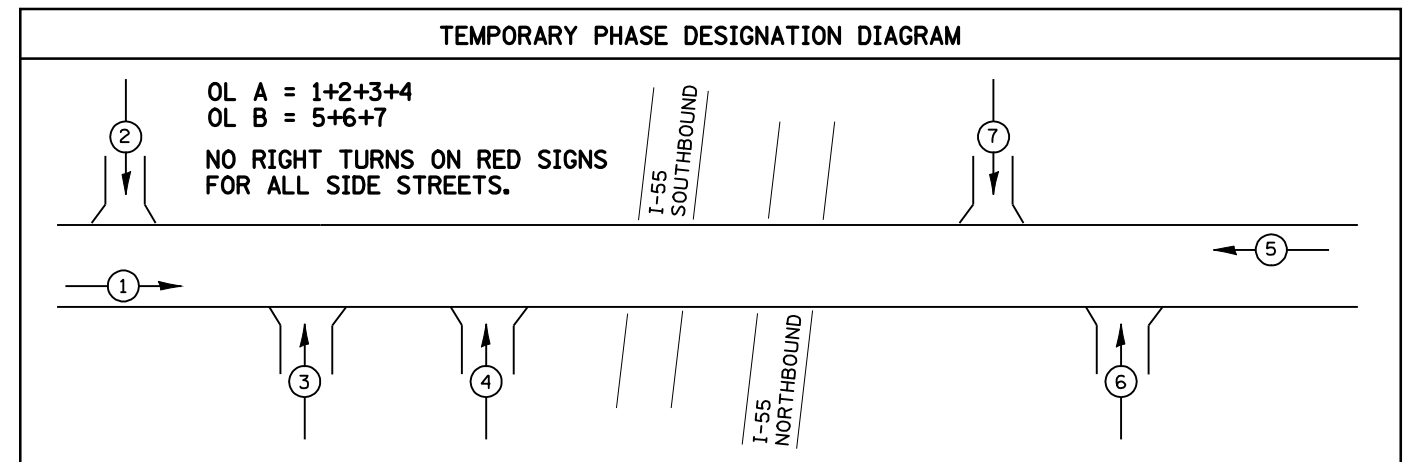
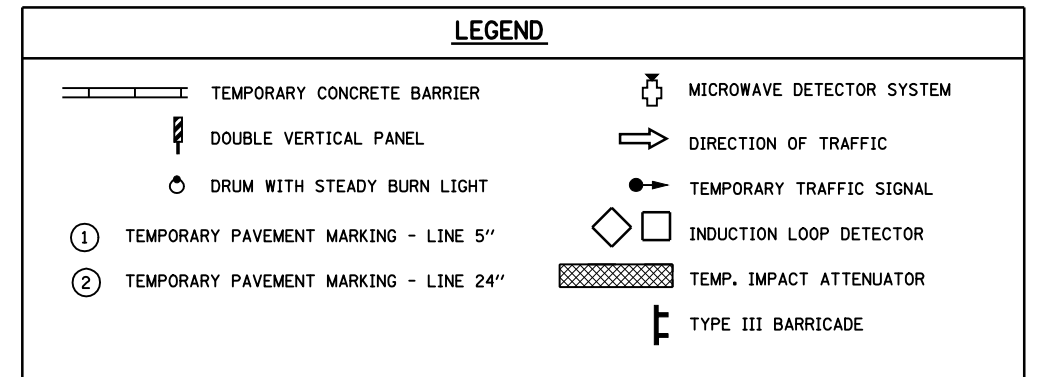

FILE NAME =	USER NAME = laughlinr1	DESIGNED -	REVISED -	STATE OF ILLINOIS DEPARTMENT OF TRANSPORTATION	STAGE II TRAFFIC CONTROL SN 084-0088				F.A.I. RTE.	SECTION	COUNTY	TOTAL SHEETS	SHEET NO.
et:\pwork\pwork\LAUGHLINR1\0176540\0672043-sht-stage2-SN88.dgn		DRAWN -	REVISED -		55	84-2(RS-3)	SANGAMON	156	72				
PLOT SCALE = 100.0000' / IN.		CHECKED -	REVISED -		CONTRACT NO. 72D43								
PLOT DATE = Apr-29-2010 07:41:45AM		DATE -	REVISED -		ILLINOIS FED. AID PROJECT								
					SCALE:	SHEET NO.	OF SHEETS	STA.	TO STA.				