

EXISTING STRUCTURE : SN 084-0102 IS A FOUR SPAN, PRE-CAST, PRE-STRESSED, CONCRETE MULTI-BEAM STRUCTURE WITH OPEN-STUB ABUTMENTS. HAS AN OVERALL LENGTH OF 222.5 FEET, MEASURED FROM BACK TO BACK OF ABUTMENTS, AND A MEASURED BRIDGE ROADWAY WIDTH OF 24.2 FEET. IT CARRIES RIDGELY ROAD OVER FAI 55 AND IS LOCATED 0.4 MILE SOUTH OF THE SANGAMON AVENUE INTERCHANGE IN SANGAMON COUNTY.

THIS IMPROVEMENT INCLUDES PLACING CONTROLLED LOW STRENGTH MATERIAL AND RIPRAP.

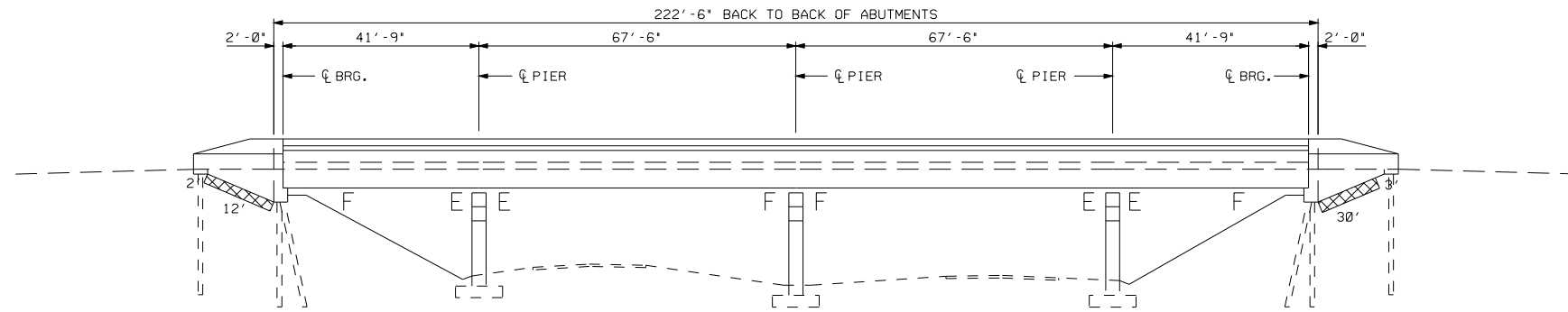

ELEVATION

BILL OF MATERIALS

PAY CODE	ITEM	UNITS	QUANTITY
59300100	CONTROLLED LOW STRENGTH MATERIAL	CU YD	40
28100205	STONE RIPRAP CLASS A3	TON	8

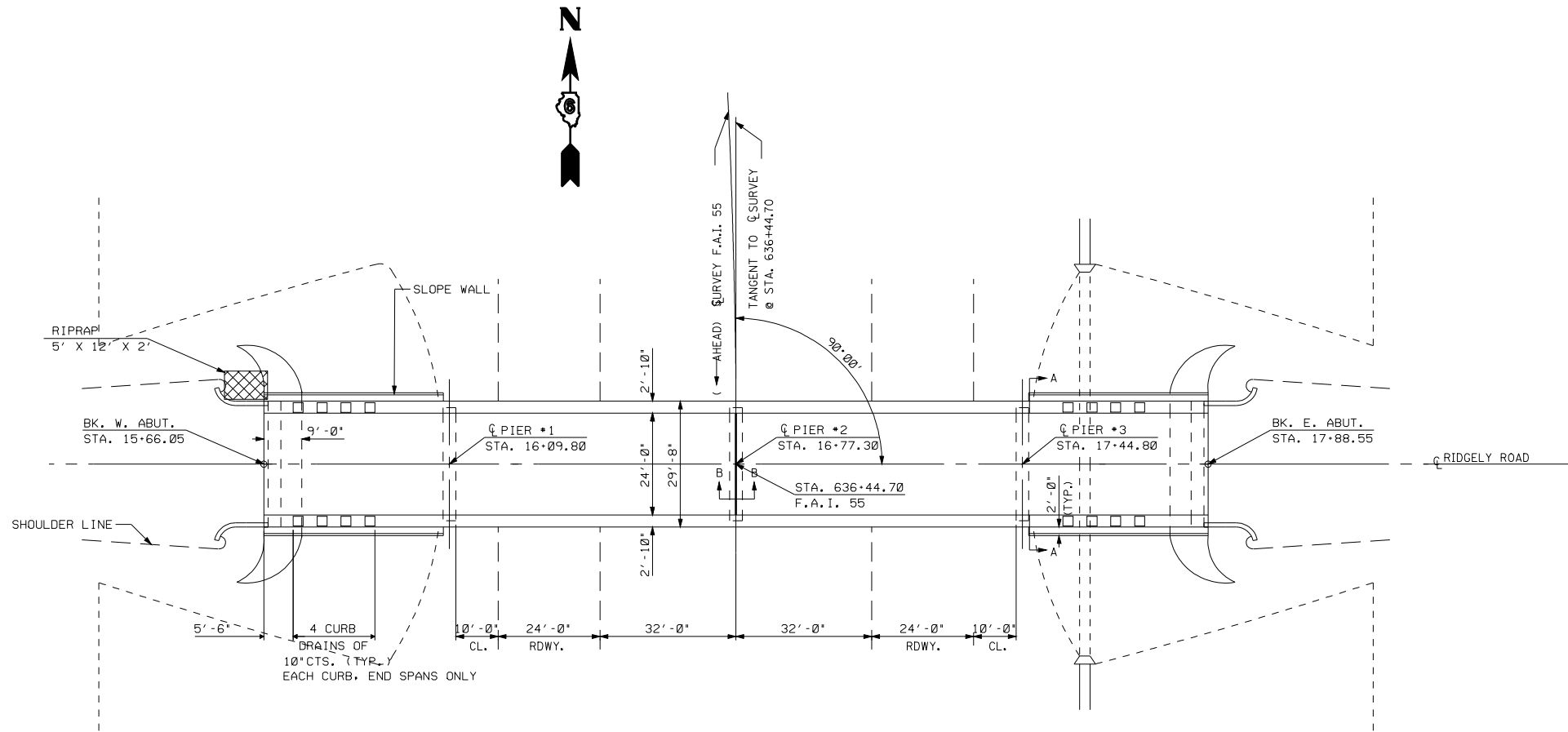

PLAN

FILE NAME =	USER NAME = laughlinr1	DESIGNED -	REVISED -	<b>STATE OF ILLINOIS DEPARTMENT OF TRANSPORTATION</b>	<b>BRIDGE DETAILS SN 084-0102</b>			F.A.I. RTE.	SECTION	COUNTY	TOTAL SHEETS	SHEET NO.
et:\pw\work\PWIDOT\LAUGHLINRL\0176540\0672043-sht-brdgdetail.dgn	DRAWN -	REVISED -	55					84-2(RS-3)	SANGAMON	156	155	
PLOT SCALE = 100.0000' / IN.	CHECKED -	REVISED -	CONTRACT NO. 72D43									
PLOT DATE = Apr-29-2010 07:49:03AM	DATE -	REVISED -	ILLINOIS FED. AID PROJECT									
				SCALE:	SHEET NO.	OF	SHEETS	STA.	TO	STA.		