

STATE OF ILLINOIS
 DEPARTMENT OF TRANSPORTATION
 DIVISION OF HIGHWAYS

**PROPOSED
 HIGHWAY PLANS**

VARIOUS ROUTES
 SECTION BDGE DECK SEALING 2010

BRIDGE DECK SEALING
 ADAMS AND PIKE COUNTIES

C-96-174-10

F.A. RTE.	SECTION	COUNTY	TOTAL SHEETS	SHEET NO.
*	BDGE DECK SEALING 2010	**	9	1
ILLINOIS CONTRACT NO. 72D46				

* VARIOUS ROUTES
 ** ADAMS, PIKE

FOR INDEX OF SHEETS, SEE SHEET NO. 2

D-96-174-10

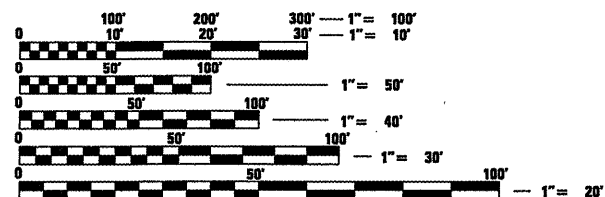
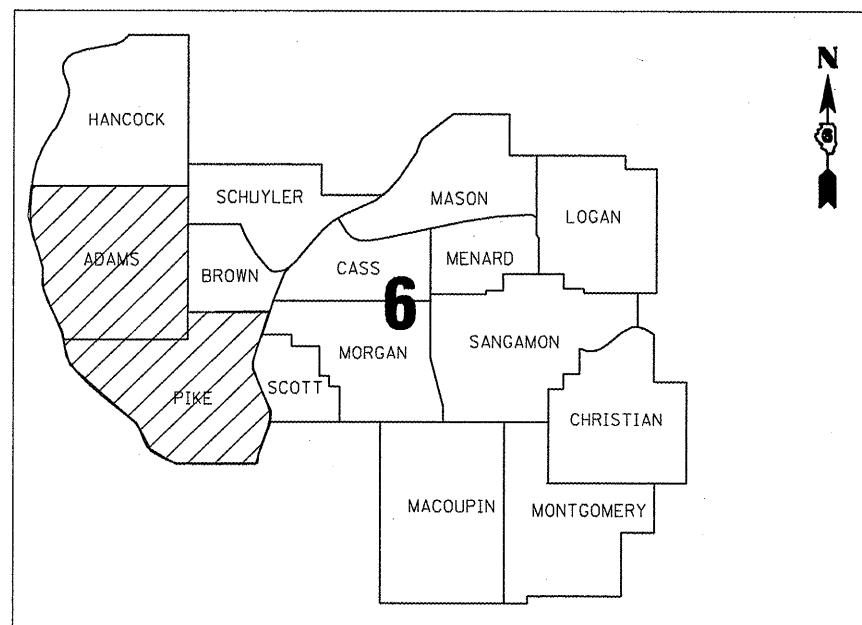
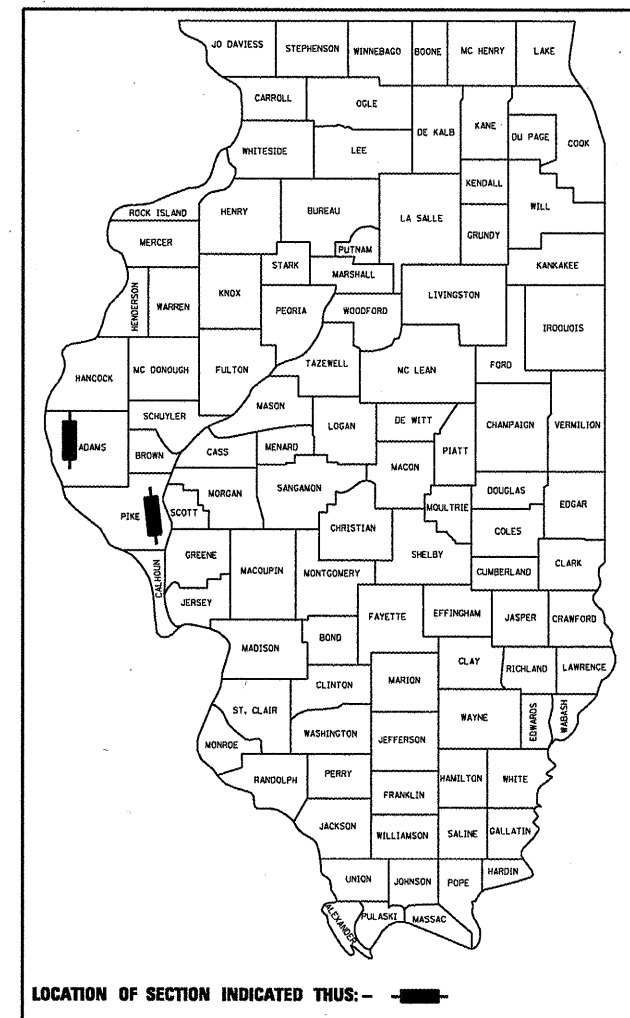

FULL SIZE PLANS HAVE BEEN PREPARED USING STANDARD ENGINEERING SCALES. REDUCED SIZED PLANS WILL NOT CONFORM TO STANDARD SCALES. IN MAKING MEASUREMENTS ON REDUCED PLANS, THE ABOVE SCALES MAY BE USED.

J.U.L.I.E.
 JOINT UTILITY LOCATION INFORMATION FOR EXCAVATION
 1-800-892-0123
 OR 811

PROJECT ENGINEER SAL MADONIA 217-782-4761
 TEAM MANAGER KEN ANDERSON 217-524-7546

CONTRACT NO. 72D46

STATE OF ILLINOIS
 DEPARTMENT OF TRANSPORTATION
 DIVISION OF HIGHWAYS

SUBMITTED March 11 2010
Roger E. Dinkler
 DEPUTY DIRECTOR OF HIGHWAYS, REGION ENGINEER

May 7 2010
Scott E. Stitt, P.E. /s/
 ACTING ENGINEER OF DESIGN AND ENVIRONMENT

May 7 2010
Christine M. Reed /s/
 DIRECTOR OF HIGHWAYS, CHIEF ENGINEER

**PRINTED BY THE AUTHORITY
 OF THE STATE OF ILLINOIS**

INDEX OF SHEETS

- 1 COVER SHEET
- 2 INDEX, GENERAL NOTES, STANDARDS
- 3 SUMMARY OF QUANTITIES
- 4 SCHEDULE OF QUANTITIES
- 5-8 BRIDGE LOCATION MAPS
- 9 BRIDGE PLAN SHEETS

HIGHWAY STANDARDS

701001-02
 701006-03
 701101-02
 701106-02
 701201-03
 701400-04
 701406-05
 701901-01

GENERAL NOTES

THE CONCRETE SEALER SHALL BE APPLIED TO THE ENTIRE TOP SURFACE OF THE DECK, INCLUDING THE INSIDE FACES AND TOPS OF THE PARAPETS.

DISTRICT SIX	
EXAMINED	<u>Oil Walker</u> 2010 <u>3/1</u>
OPERATIONS ENGINEER	
EXAMINED	<u>MARCH 3</u> 20 <u>10</u>
<u>Jimmy L. D.</u> PROGRAM IMPLEMENTATION ENGINEER	
EXAMINED	<u>March 5</u> 20 <u>10</u>
<u>DRML</u> PROGRAM DEVELOPMENT ENGINEER	

• VARIOUS ROUTES
 •• ADAMS, PIKE

CONCRETE SEALER

LOCATION	DECK LENGTH (FT)	DECK WIDTH (FT)	PARAPET LT (FT)	PARAPET RT (FT)	AREA (SQ FT)	TRAFFIC CONTROL & PROTECTION
ADAMS COUNTY						
STRUCTURE NO.	FACILITY CARRIED	LOCATION				
0010002	IL 61/94	0.5 MI N IL 61/94 SPLIT	26	29	3.77 3.77 950	701201
0010007	IL 96	IN URSA, 0.5 M S IL 61	86	33	0.00 0.00 2,838	701201
0010008	IL 96	2 M S IL 61 IN URSA	107.5	42.5	3.77 3.77 5,379	701201
0010010	US 24	0.05 M N 12TH ST	132.3	66	3.77 3.77 9,729	701201
0010011	US 24 (3RD ST)	1.5 M N IL 104/BROADWAY	430.1	35.4	3.77 3.77 18,468	701201
0010014	IL 57	JUST N 12TH ST	42.9	32.5	0.00 0.00 1,394	701201
0010024	ILL 104 WB	2.2 MI E I-172/IL 104	168	38.6	3.77 3.77 7,752	701406
0010031	ILL 96	3.4 MI N JCT IL 104/96	27.2	32.6	0.00 0.00 887	701201
0010032	IL 96/24TH ST	0.6 M N LOCUST-QUINCY	44	39.5	3.77 3.77 2,070	701406
0010047	ILL 104	I-172/ IL 104	269	70.5	3.77 3.77 20,993	701406
0010050	FAI 172 SB	1.5 MI S - I172/US 24	288.3	38.5	3.77 3.77 13,273	701406
0010051	FAI 172 NB	1.5 MI S - I172/US 24	288.3	38.5	3.77 3.77 13,273	701406
0010052	IL 96	1.4 M N MARCELLINE	303	30.8	3.77 3.77 11,617	701201
0010068	US 24 WB	W EDGE DWNTWN QUINCY	4508.3	32	3.77 3.77 178,258	701406
0010070	ILL 104 EB	2.2 MI E I-172/IL 104	175	40	3.77 3.77 8,320	701406
0010072	ILL 94	1.6 S GOLDEN	99.5	32	3.77 3.77 3,934	701201
0010073	ILL 96	1.7 MI SE PAYSON	190.5	32	3.77 3.77 7,532	701201
0010074	IL 96	1.6 MI CH 41 IN LIMA	78.5	32	3.77 3.77 3,104	701201
0010075	IL 96	0.4 M S MARCELLINE	71	32	3.77 3.77 2,807	701201
0010076	IL 96	1.3 M N IL 61 IN URSA	105.3	32	3.77 3.77 4,164	701201
0010077	IL 61	1.1 M W IL 94	100	35	3.77 3.77 4,254	701201
0010078	IL 61	0.2 M E LORAINE RD	133.5	35	3.77 3.77 5,679	701201
0010080	I-172 & ILL 336 SB	US 24 & IL 336 JCT	164	40	3.77 3.77 7,797	701406
0010081	I-172 & ILL 336 NB	US 24 & IL 336 JCT	164	40	3.77 3.77 7,797	701406
0010084	FAP 733	0.3 MI E MENDON	228.6	65.3	3.77 3.77 16,651	701201
0010502	IL 106	1.4 MI SE I-172/IL 96	266.2	31.5	3.77 3.77 10,392	701201
0010503	ILL 96	2.1 MI S ILL 104-96	82	39.4	3.77 3.77 3,849	701201
PIKE COUNTY						
STRUCTURE NO.	FACILITY CARRIED	LOCATION				
0750012	IL 107	.14 M S 104	169.6	28.6	0.00 0.00 4,851	701201
0750013	IL 107	1.8 M S MAINE - PERRY	127.2	33	0.00 0.00 4,198	701201
0750020	US 54	2.9 M SW OF IL 96	56	43.9	3.77 3.77 2,881	701201
0750022	US 54	5.2 M SW OF IL 96	33	44.5	0.00 0.00 1,469	701201
0750028	IL 104	0.1M E ADAMS CO LINE	180	31.2	0.00 0.00 5,616	701201
0750033	IL 104	1.2 M W IL 99	47.1	32	3.77 3.77 1,862	701201
0750045	IL96	1.6 M SE US 54 - ATLAS	44	32	3.77 3.77 1,740	701201
0750047	IL 96	1 M SE PLEASANT HILL	251.2	32	3.77 3.77 9,932	701201
0750048	IL 96	1.3 M SE OF PT HILL	420	32	3.77 3.77 16,607	701201
0750075	IL 96	1 M NW PLEASANT HILL	179	36	3.77 3.77 7,794	701201
0750112	IL 107	IL 107 INTERCHANGE	210	66	3.77 3.77 15,443	701201
0750119	FAI 72 WB	4.7 MI W IL 100	345	40	3.77 3.77 16,401	701406
0750120	I-72 WB	4.4 M W IL 100 INTCHG	345	40	3.77 3.77 16,401	701406
0750121	I-72 WB	4.1 M W IL 100 INTCHG	265	40	3.77 3.77 12,598	701406
0750128	IL 104	0.2 M E IL 99	135	36	3.77 3.77 5,878	701201
0750129	IL 99	0.1 M N IL 104	109.2	32	3.77 3.77 4,318	701201
0750135	ILL 100	0.4 MI N PIKE CO LINE	166	32	3.77 3.77 6,564	701201
0750140	IL 100	AT PEARL	170	32	3.77 3.77 6,722	701201
TOTAL					514,436	

* VARIOUS ROUTES
** ADAMS, PIKE

FILE NAME *	USER NAME = laughlinr1	DESIGNED -	REVISED -	STATE OF ILLINOIS DEPARTMENT OF TRANSPORTATION	SCHEDULE OF QUANTITIES				F.A. RTE.	SECTION	COUNTY	TOTAL SHEETS	SHEET NO.
c:\pvc_work\PIVDDOT\LAUGHLINRL\0181014\072046-shr-schedule.dgn		DRAWN -	REVISED -		SCALE:	SHEET NO.	OF	SHEETS	STA.	TO STA.	**	9	4
PLOT SCALE = 100.0000 ' / IN.		CHECKED -	REVISED -		CONTRACT NO. 72D46								
PLOT DATE = Mar-12-2010 01:18:08PM		DATE -	REVISED -		ILLINOIS FED. AID PROJECT								

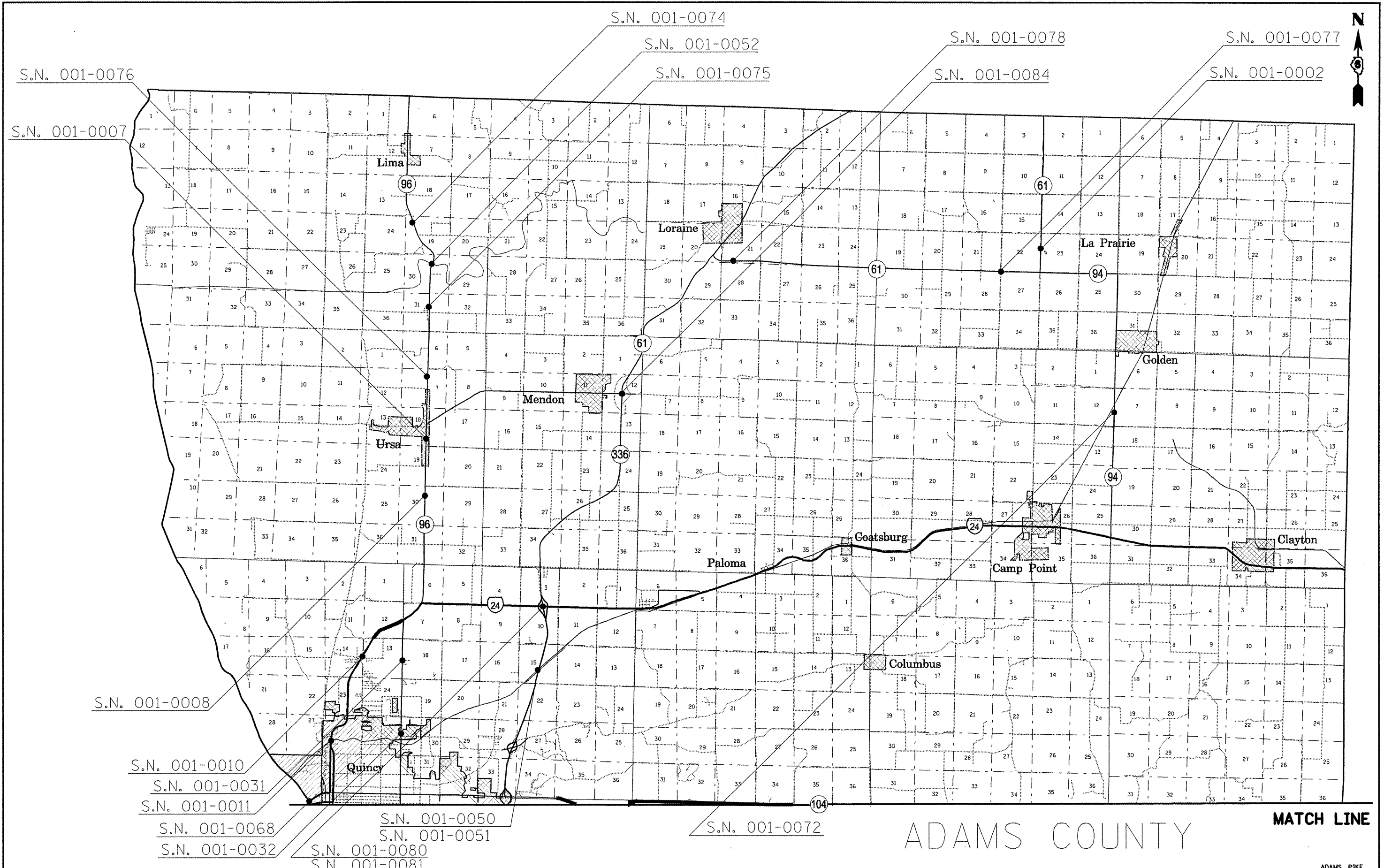

FILE NAME =	USER NAME = laughlin1	DESIGNED -	REVISED -
c:\pwwork\PMIDOT\LAUHLIN\0101014\0972046-shr-bridgelocationMap.dgn		DRAWN -	REVISED -
PLOT SCALE = 24000.0000 / IN.		CHECKED -	REVISED -
PLOT DATE = Mon-12-2010 01:01:11PM		DATE -	REVISED -

**STATE OF ILLINOIS
DEPARTMENT OF TRANSPORTATION**

ADAMS COUNTY BRIDGE LOCATION MAP			
SCALE:	SHEET NO.	OF SHEETS	STA. TO STA.

F.A. RTE.	SECTION	COUNTY	TOTAL SHEET NO.
•	BDGE DECK SEALING 2010	**	9 5
			CONTRACT NO. 72046
ILLINOIS FED. AID PROJECT			

ADAMS, PIKE

S.N. 001-0070

S.N. 001-0024

S.N. 001-0047

S.N. 001-0503

MATCH LINE

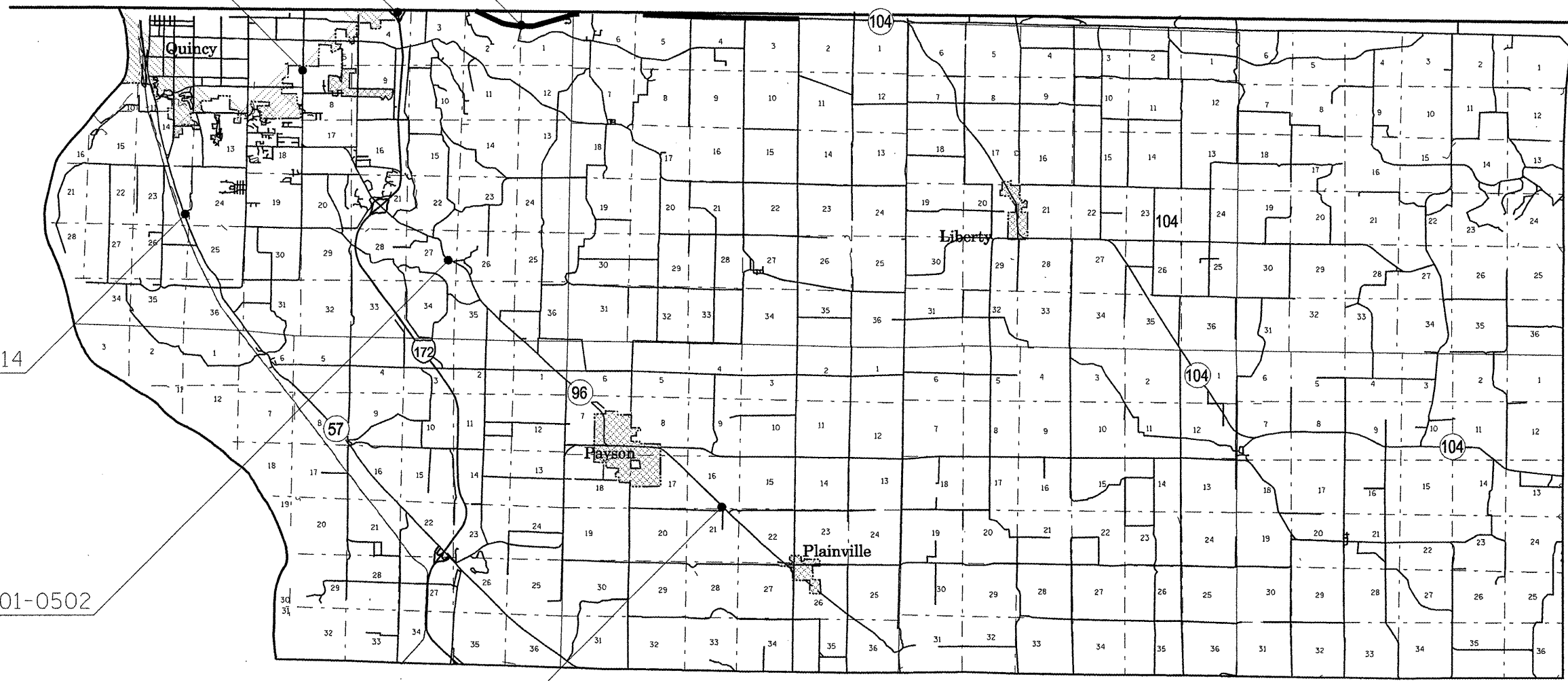

S.N. 001-0014

S.N. 001-0502

S.N. 001-0073

ADAMS COUNTY

• VARIOUS ROUTES
•• ADAMS, PIKE

FILE NAME = c:\pwwork\FWIDOT\LAUGHLIN\ld0181014\072046-shr-BridgeLocationMap.dgn	USER NAME = laughlinr	DESIGNED - DRAWN -	REVISED - REVISED -	STATE OF ILLINOIS DEPARTMENT OF TRANSPORTATION	ADAMS COUNTY BRIDGE LOCATION MAP				F.A. RTE.	SECTION	COUNTY	TOTAL SHEETS	SHEET NO.
PLOT SCALE = 24000.0000' / IN.	CHECKED -	REVISED -	REVISED -		SCALE:	SHEET NO.	OF SHEETS	STA.	TO STA.	• BDGE DECK SEALING 2010	••	9	6
PLOT DATE = Mar-12-2010 01:18:14PM	DATE -	REVISED -	REVISED -		CONTRACT NO. 72D46								
ILLINOIS FED. AID PROJECT													

S.N. 075-0129 S.N. 075-0128

S.N. 075-0012

S.N. 075-0033

S.N. 075-0028

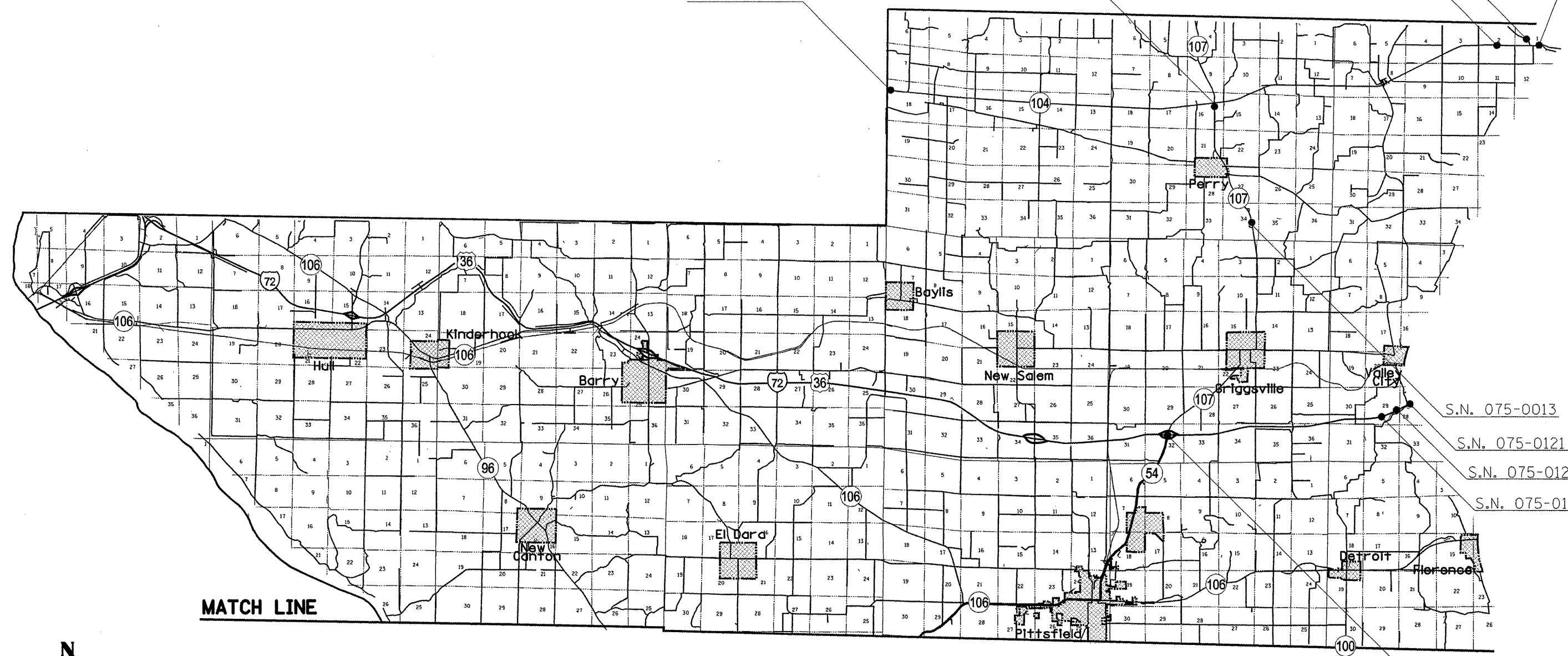

MATCH LINE



PIKE COUNTY

- VARIOUS ROUTES
- ** ADAMS, PIKE

FILE NAME = c:\pwwork\PIWIDOT\LAUGHLINRL\d0181014\06	USER NAME = laughlinr1 72D46-shr-BrigdeLocationMap.dgn	DESIGNED - DRAWN -	REVISED - REVISED -
PLOT SCALE = 24000.0000' / IN.	CHECKED -	REVISED -	REVISED -
PLOT DATE = Mar-12-2010 01:18:16PM	DATE -	REVISED -	REVISED -

**STATE OF ILLINOIS
DEPARTMENT OF TRANSPORTATION**

**PIKE COUNTY
BRIDGE LOCATION MAP**

SCALE: SHEET NO. OF SHEETS STA. TO STA.

F.A. RTE.	SECTION	COUNTY	TOTAL SHEETS	SHEET NO.
•	BIDGE DECK SEALING 2010	**	9	7
CONTRACT NO. 72D46				
ILLINOIS FED. AID PROJECT				

MATCH LINE

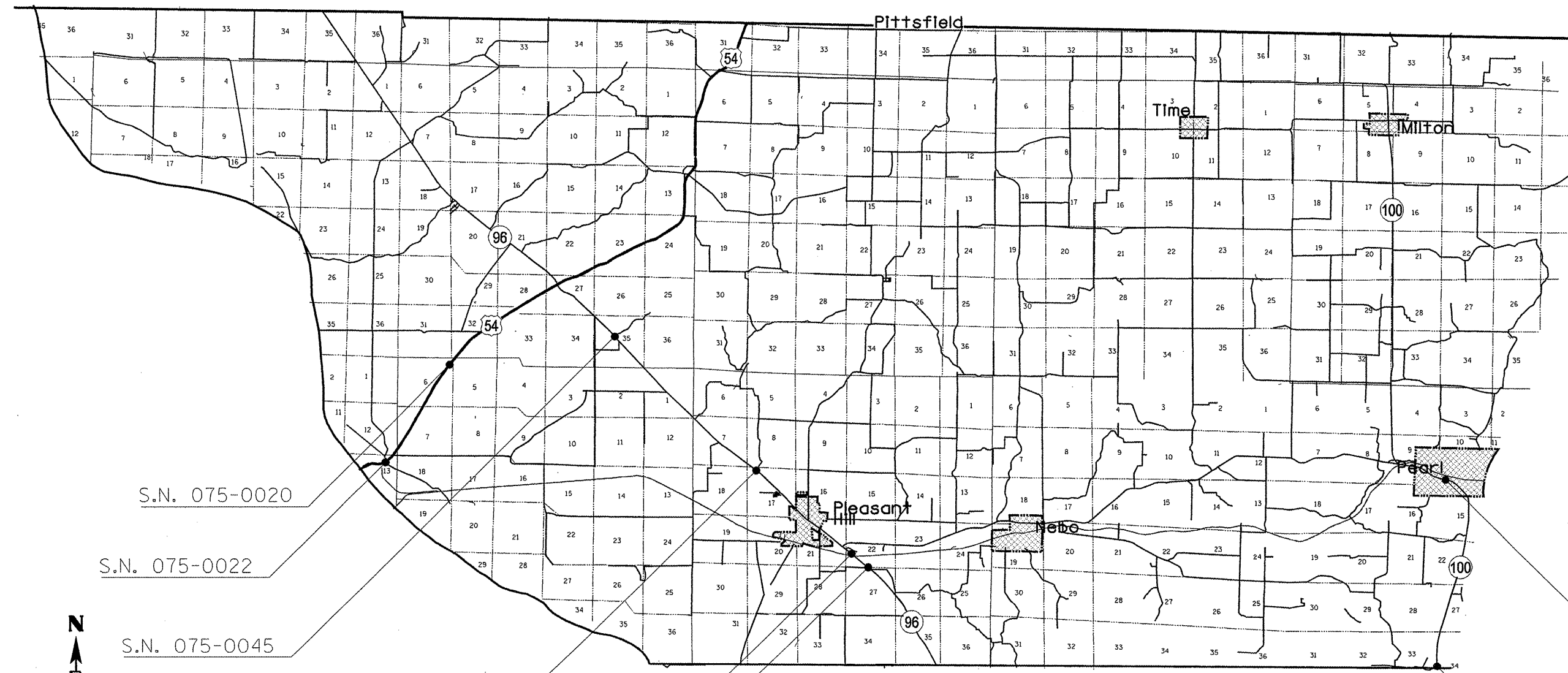

S.N. 075-0020

S.N. 075-0022

S.N. 075-0045

S.N. 075-0075

S.N. 075-0047

S.N. 075-0048

S.N. 075-0140

S.N. 075-0135

PIKE COUNTY

FILE NAME =		USER NAME = laughlinc1		DESIGNED -		REVISED -		STATE OF ILLINOIS DEPARTMENT OF TRANSPORTATION		PIKE COUNTY BRIDGE LOCATION MAP			F.A. RTE.		SECTION		COUNTY		TOTAL SHEETS		SHEET NO.		
es:\pwwork\VPWIDOT\LAUGHLIN\10181014\072046-shr*BridgeLocationMap.dgn		DRAWN -		REVISED -		PLOT SCALE = 24000.0000' / IN.							CHECKED -		REVISED -		•		BDGE DECK SEALING 2010		**		9
PLOT DATE = Mar-12-2010 01:18:19PM		DATE -		REVISED -																			
										SCALE:		SHEET NO.		OF SHEETS		STA.				TO STA.			
																				CONTRACT NO. 72046		ILLINOIS FED. AID PROJECT	

ADAMS, PIKE

LIMITS OF BRIDGE DECK SEALING
END TO END OF DECK

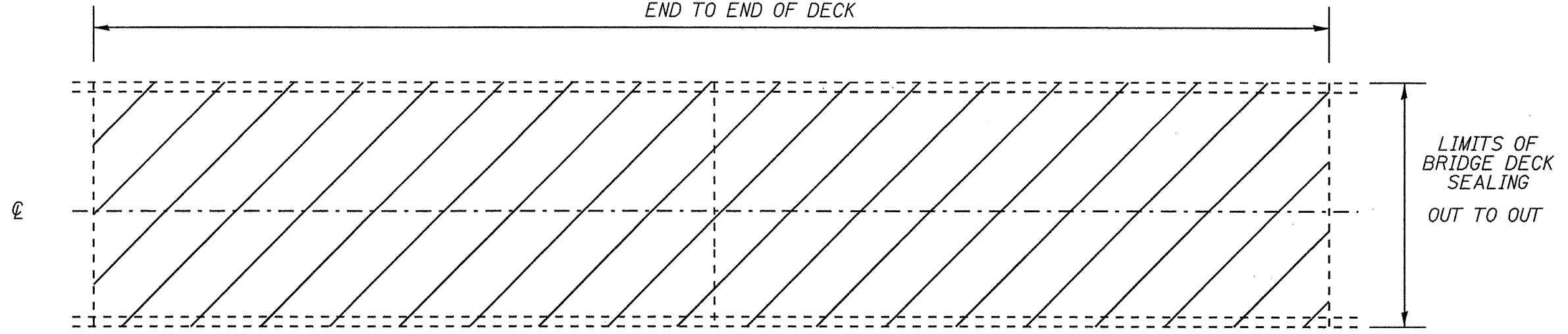

PLAN VIEW

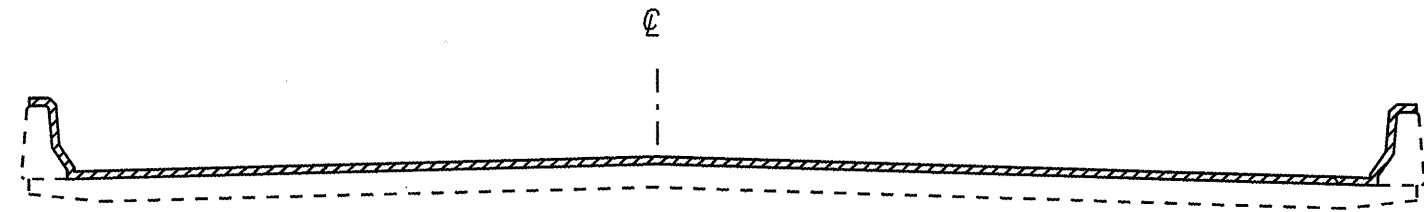

CROSS SECTION
WITH PARAPET

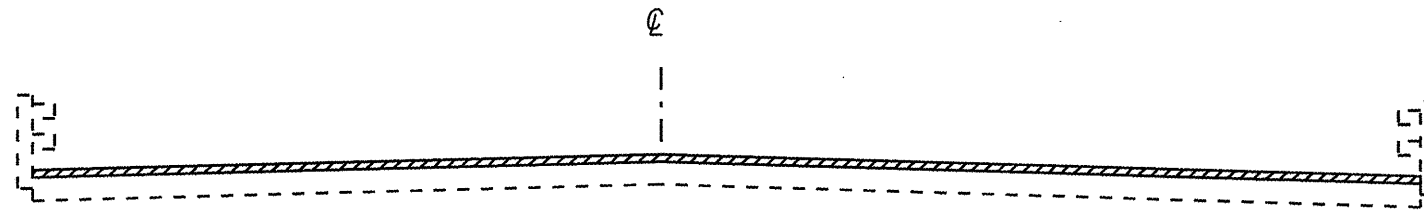

CROSS SECTION
WITH BRIDGE RAIL

NOTE: BRIDGE APPROACH PAVEMENT
SHALL NOT BE SEALED

NOT TO SCALE

 AREA TO BE SEALED

FILE NAME = c:\pwwork\PM\DOT\LAUGHLIN\RL\08181014\08	USER NAME = laughlinr1	DESIGNED -	REVISED -	STATE OF ILLINOIS DEPARTMENT OF TRANSPORTATION	PLAN AND PROFILE OF BRIDGE DECK AND PARAPET	F.A. RTE.	SECTION	COUNTY	TOTAL SHEETS	SHEET NO.	
	72D46sh-plot.dgn	DRAWN -	REVISED -			VAR	BDGE DECK SEALING 2010	VARIOUS	9	9	
	PLOT SCALE = 100.0000' / IN.	CHECKED -	REVISED -			CONTRACT NO. 72D46					
	PLOT DATE = Mar-12-2010 01:18:21PM	DATE -	REVISED -			ILLINOIS FED. AID PROJECT					
				SCALE:	SHEET NO.	OF	SHEETS	STA.	TO STA.		