

Distance from A6 to Controller = +/-1940'

NOTE: ALL DELINEATOR POST WITH CHEVRONS IN CIRCUIT "A" (6 TOTAL) ARE EXISTING.

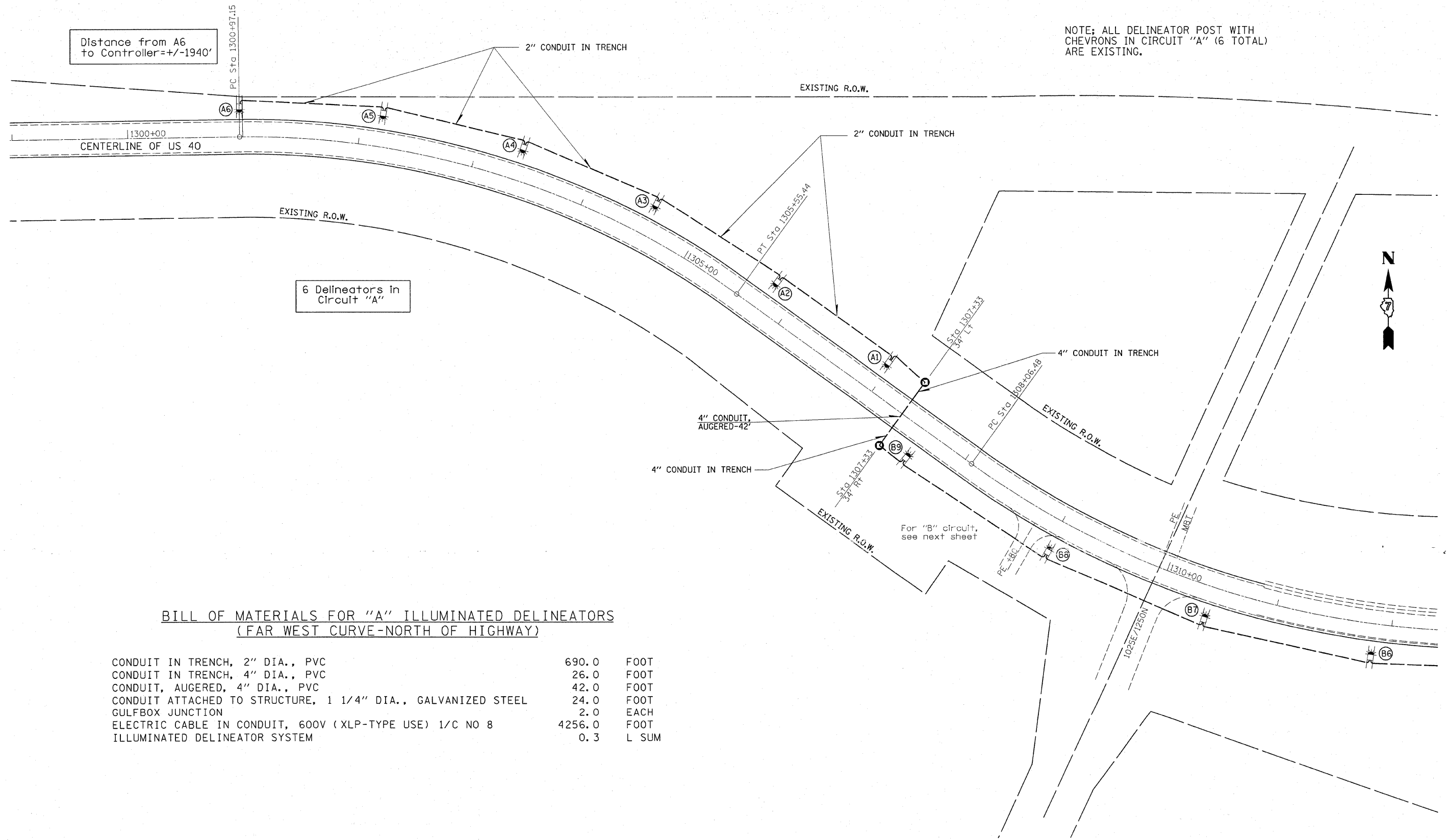

6 Delineators in Circuit "A"

**BILL OF MATERIALS FOR "A" ILLUMINATED DELINEATORS
(FAR WEST CURVE-NORTH OF HIGHWAY)**

CONDUIT IN TRENCH, 2" DIA., PVC	690.0	FOOT
CONDUIT IN TRENCH, 4" DIA., PVC	26.0	FOOT
CONDUIT, AUGERED, 4" DIA., PVC	42.0	FOOT
CONDUIT ATTACHED TO STRUCTURE, 1 1/4" DIA., GALVANIZED STEEL	24.0	FOOT
GULFBOX JUNCTION	2.0	EACH
ELECTRIC CABLE IN CONDUIT, 600V (XLP-TYPE USE) 1/C NO 8	4256.0	FOOT
ILLUMINATED DELINEATOR SYSTEM	0.3	L SUM

FILE NAME =	USER NAME = swartzw	DESIGNED -	REVISED -	STATE OF ILLINOIS DEPARTMENT OF TRANSPORTATION	ILLUMINATED DELINEATOR SYSTEM CIRCUIT "A" PLAN LAYOUT			F.A.S. RTE.	SECTION	COUNTY	TOTAL SHEETS	SHEET NO.	
c:\pwork\pwork\SWARTZRW\dms54414\07	4317-ght-Geometrios.dgn	DRAWN -	REVISED -		SCALE: 1"=40'	SHEET NO. 2 OF 4 SHEETS	STA. 1301+00 TO STA. 1307+50	2796	(L,K)RS-2	EFFINGHAM	58	42	
	PLOT SCALE = 48,0000 "/ IN.	CHECKED -	REVISED -										
	PLOT DATE = 3/17/2010	DATE -	REVISED -										
											CONTRACT NO. 74317		
											ILLINOIS FED. AID PROJECT		