

Note: Trim existing long. reinf. to accommodate new joint opening (typ.)

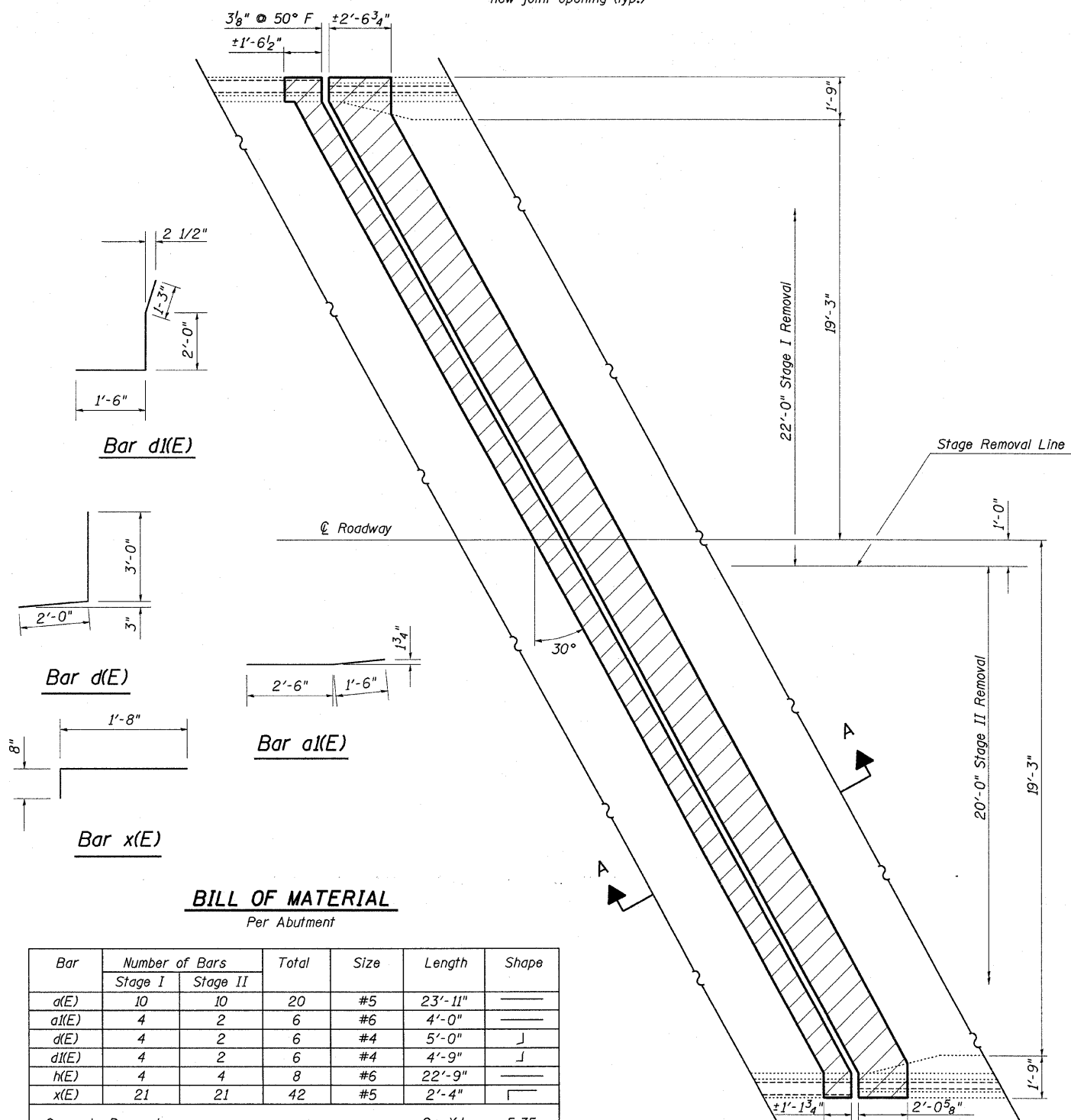

**EXISTING PARTIAL PLAN**  
(South Abutment shown; North Abutment similar by rotation)

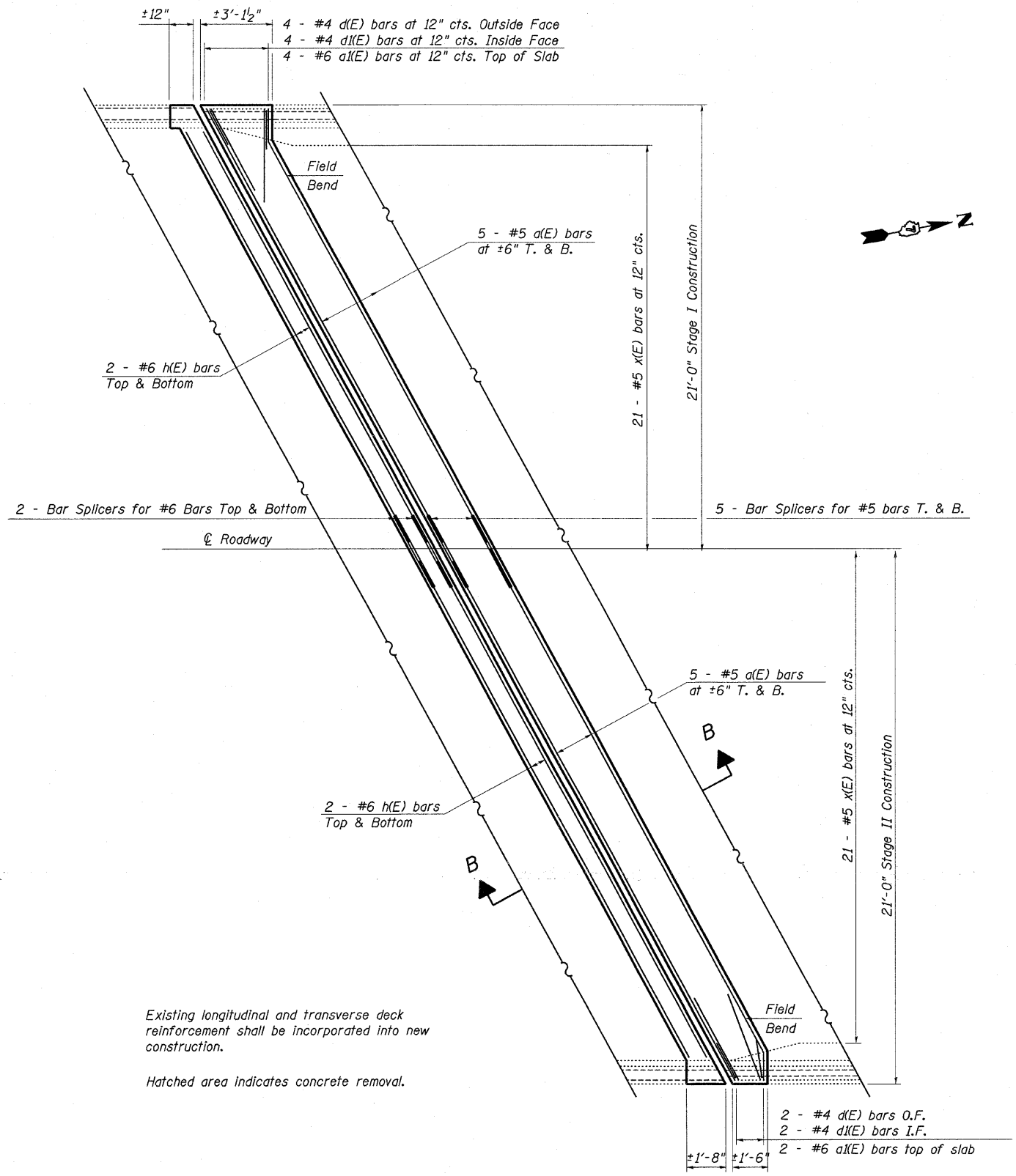

**PROPOSED PARTIAL PLAN**  
(South Abutment shown; North Abutment similar by rotation)

**BILL OF MATERIAL**  
Per Abutment

Bar	Number of Bars		Total	Size	Length	Shape
	Stage I	Stage II				
a(E)	10	10	20	#5	23'-11"	—
a1(E)	4	2	6	#6	4'-0"	—
d(E)	4	2	6	#4	5'-0"	J
d1(E)	4	2	6	#4	4'-9"	J
h(E)	4	4	8	#6	22'-9"	—
x(E)	21	21	42	#5	2'-4"	—
Concrete Removal				Cu. Yd.	5.35	
Reinforcement Bars (Epoxy Coated)				Lbs.	950	
Concrete Superstructure				Cu. Yd.	6.1	