

STATE OF ILLINOIS
DEPARTMENT OF TRANSPORTATION

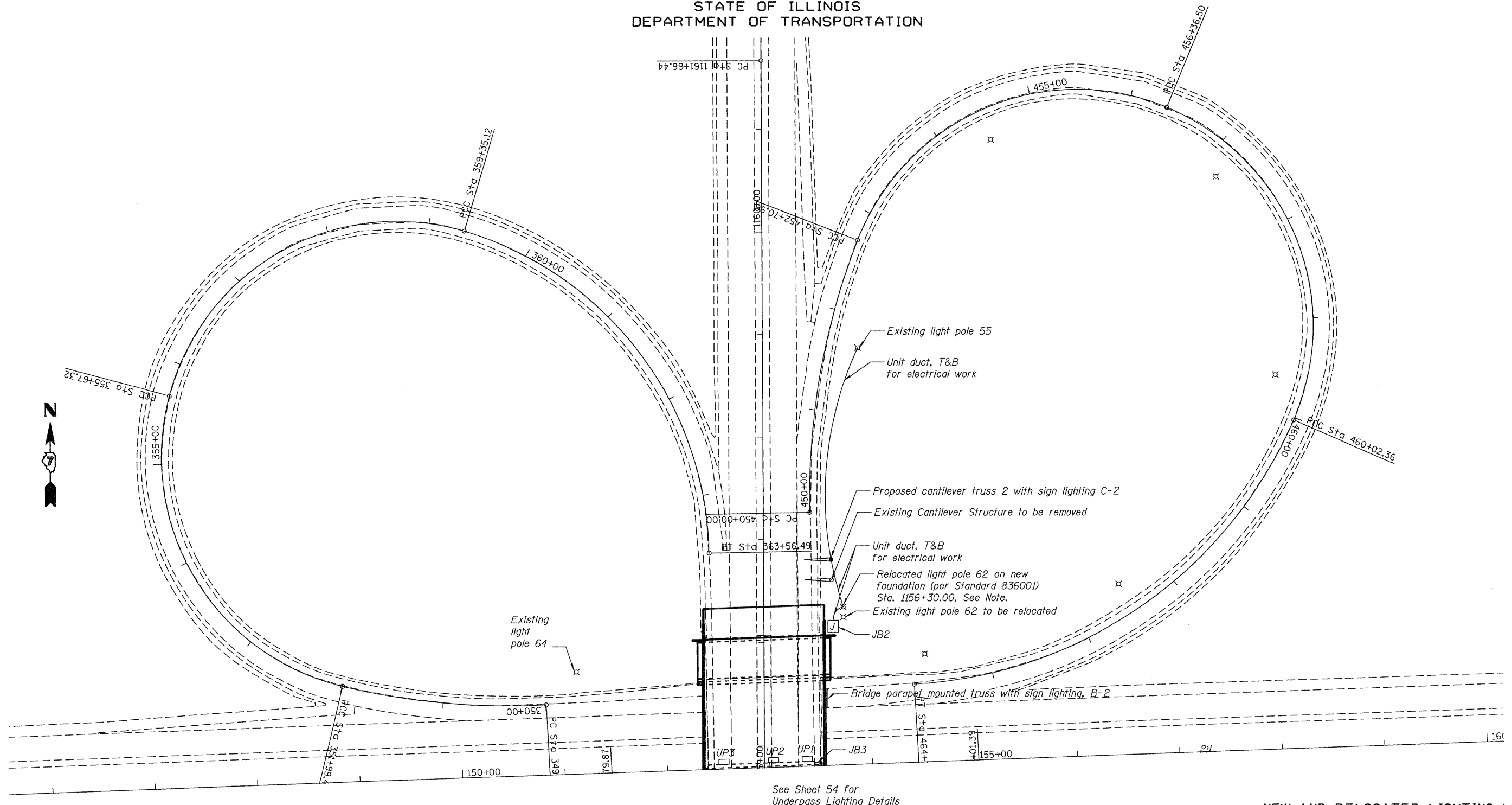

See Sheet 54 for
Underpass Lighting Details

Note: 30' offset from edge of pavement on all relocated light poles.
Proposed light pole foundation anchor bolts to match existing
diameter, spacing, and projection length. Field verify prior
to ordering materials.

NEW AND RELOCATED LIGHTING LOCATIONS
NORTHERN RAMPS
US 51 OVER I-72
F.A.P. RTE. 322 - SEC. (58-64HB-1)B-1
MACON COUNTY
STA. 1154+77.78
SN 058-0136

**THOUVENOT,
WADE &
MOERCHEN, INC.**
SWANSEA • WATERLOO • EDWARDSVILLE • CARBONDALE • ST. CHARLES

CORPORATE OFFICE
4940 Old Collinsville Road
Swansea, Illinois 62226
Tel: 618.624.4488
Fax: 618.624.6688



SHEET NO. 2
9 SHEETS

F.A.P. RTE.	SECTION	COUNTY	TOTAL SHEETS	SHEET NO.
322	(58-64HB-1)B-1	MACON	149	52
FED. ROAD DIST. NO.			ILLINOIS FED. AID PROJECT	
			CONTRACT NO. 74387	

Printed by: mschwartzjohn 5/12/2010 9:17:54 AM