

STATE OF ILLINOIS
DEPARTMENT OF TRANSPORTATION

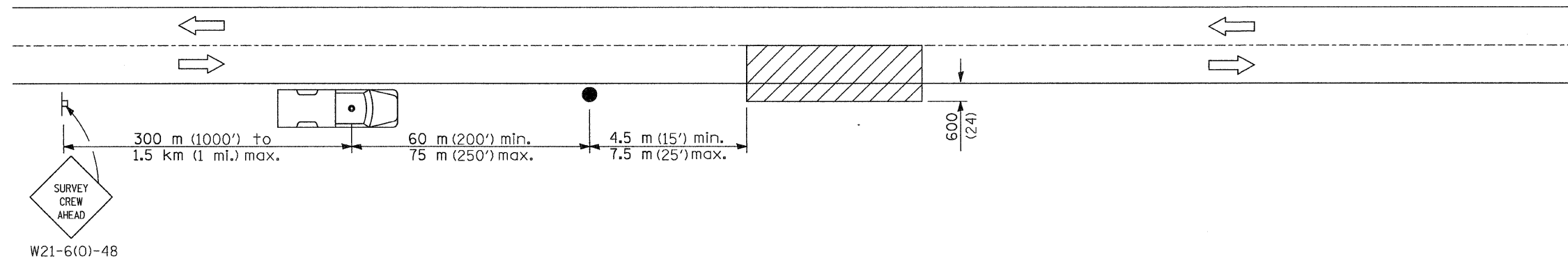

SYMBOLS

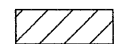

Work area



Sign on portable or permanent support

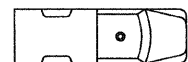

Truck with flashing amber light and dual emergency flashers



Flagger with traffic control sign

TYPICAL APPLICATIONS
Utility operations

**DETAIL FOR
NIGHTTIME LIGHTING INSPECTION
US 51 OVER I-72
F.A.P. RTE. 322 - SEC. (58-64HB-1)B-1
MACON COUNTY
STA. 1154+77.78
SN 058-0136**

All dimensions are in millimeters (inches)
unless otherwise shown.

**THOUVENOT,
WADE &
MOERCHEN, INC.**
CORPORATE OFFICE
4940 Old Collinsville Road
Swansea, Illinois 62226
Tel: 618.624.4488
Fax: 618.624.6688
SWANSEA • WATERLOO • EDWARDSVILLE • CARBONDALE • ST. CHARLES



SHEET NO. 9
9 SHEETS

F.A.P. RTE.	SECTION	COUNTY	TOTAL SHEETS	SHEET NO.
322	(58-64HB-1)B-1	MACON	149	59
CONTRACT NO. 74387				
FED. ROAD DIST. NO. - ILLINOIS FED. AID PROJECT				