

DATE \_\_\_\_\_  
 BY \_\_\_\_\_  
 SURVEYED \_\_\_\_\_  
 PLOTTED \_\_\_\_\_  
 TEMPLATE \_\_\_\_\_  
 NOTE BOOK \_\_\_\_\_  
 AREAS CHECKED \_\_\_\_\_  
 NO. \_\_\_\_\_

DATE \_\_\_\_\_  
 BY \_\_\_\_\_  
 ORIGINAL SURVEY \_\_\_\_\_  
 PLOTTED \_\_\_\_\_  
 TEMPLATE \_\_\_\_\_  
 NOTE BOOK \_\_\_\_\_  
 AREAS CHECKED \_\_\_\_\_  
 NO. \_\_\_\_\_

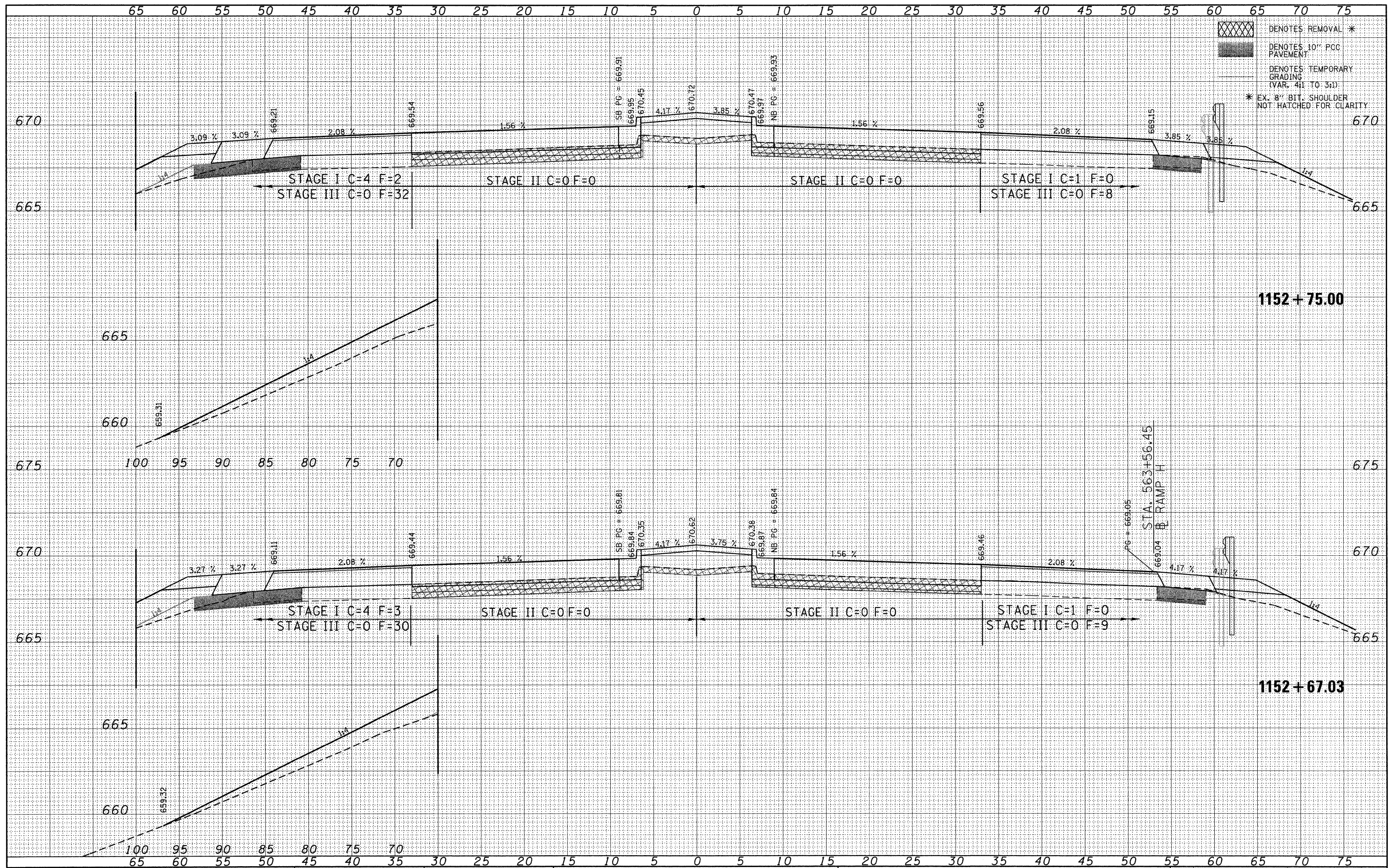

DENOTES REMOVAL \*  
 DENOTES 10" PCC PAVEMENT  
 DENOTES TEMPORARY GRADING (VAR. 4:1 TO 3:1)  
 \* EX. 8" BIT. SHOULDER NOT HATCHED FOR CLARITY

FILE NAME = P:\080276\US 51 over I-72\4-CADD\4.2-TR\SHEETS	USER NAME = jheger	DESIGNED - JWS	REVISED -	<b>STATE OF ILLINOIS</b> <b>DEPARTMENT OF TRANSPORTATION</b>	<b>CROSS SECTIONS</b> <b>US 51 CROSS SECTIONS</b>		F.A.P. RTE. 322	SECTION (58-64HB-1)B-1	COUNTY MACON	TOTAL SHEETS 149	SHEET NO. 132	
PLOT SCALE = 5.0000' / in.	DATE = 3/12/2010	DRAWN - JWS	REVISED -		SCALE: 1" = 5"	SHEET NO. 18 OF 35 SHEETS	STA. 1152+67.03 TO STA. 1152+75.00	CONTRACT NO. 74387		ILLINOIS FED. AID PROJECT		
		CHECKED - SJK	REVISED -									
		DATE = 3/12/2010	REVISED -									