

PRE-STAGE I CONSTRUCTION SHALL CONSIST OF:

1. THE REMOVAL OF THE EXISTING SHOULDERS ON THE LEFT SIDE OF IL 4 CENTER LINE FROM STA 786+00.0 TO CH 18 AND FROM CH 18 TO STA 805+00.0.
2. THE CONSTRUCTION OF THE PAVEMENT WIDENING ON THE NORTH AND SOUTH CORNERS OF THE STRUCTURE AND THE WIDENING AT CH 18 AS SHOWN ON THE PLAN.
3. TRAFFIC CONTROL SHALL BE IN ACCORDANCE WITH TRAFFIC CONTROL AND PROTECTION, STANDARD 701326.

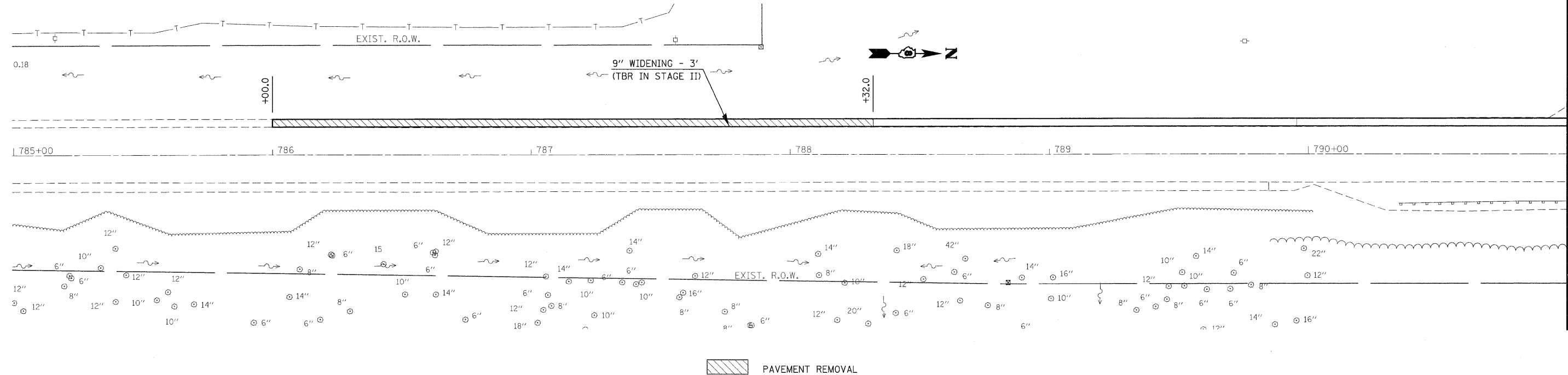

MATCHLINE 791+00.00

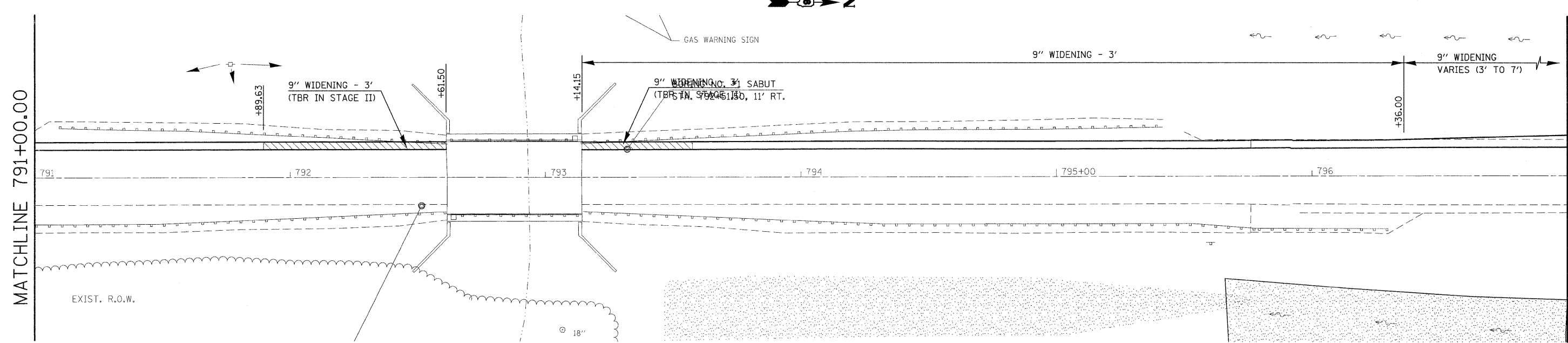

MATCHLINE 791+00.00

MATCHLINE 797+00.00

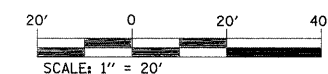

FILE NAME =	USER NAME = gelnh	DESIGNED -	REVISED -
c:\pw\work\PWIDOT\GELINH\dms52514\stg00	Re.dgn	DRAWN -	REVISED -
	PLOT SCALE = 20.0000' / IN.	CHECKED -	REVISED -
	PLOT DATE = 1/22/2010	DATE -	REVISED -

**STATE OF ILLINOIS  
DEPARTMENT OF TRANSPORTATION**

**SUGGESTED PRE-STAGE I CONSTRUCTION  
AND TRAFFIC CONTROL**

SCALE: 1" = 20'    SHEET NO. 1 OF 2 SHEETS    STA. 785+00.00 TO STA. 797+00.00

F.A.P. RTE.	SECTION	COUNTY	TOTAL SHEETS	SHEET NO.
682	21BR, 21-I-1	RANDOLPH	77	17
CONTRACT NO. 76126				
ILLINOIS FED. AID PROJECT				