

PART OF THE SE 1/4 OF SECTION 12 AND THE NE 1/4 OF SECTION 13, T4S, R6W, OF THE 3RD PM,
ALSO PART OF THE SW 1/4 OF SECTION 7 AND THE NW 1/4 OF SECTION 18, T4S, R5W, OF THE 3RD PM,
RANDOLPH COUNTY, ILLINOIS

BEARINGS SHOWN HEREON ARE BASED ON SURVEY CONTROL DATA AS PROVIDED BY THE ILLINOIS DEPARTMENT OF TRANSPORTATION.

SECTION	COUNTY	TOWNSHIP	RANGE
21-1-1	Randolph	77	36
STA. 798+38.53	TO STA. 805+00.00		

LEGEND

- EXISTING CENTERLINE
- EXISTING RIGHT OF WAY LINE
- EXISTING EASEMENT LINE
- PROPOSED CENTERLINE
- PROPOSED RIGHT OF WAY LINE
- PROPOSED TEMPORARY EASEMENT LINE
- PROPOSED PERMANENT EASEMENT LINE
- SECTION LINE
- QUARTER SECTION LINE
- QUARTER QUARTER SECTION LINE
- PROPERTY (DEED) LINE
- APL
- APPARENT PROPERTY LINE
- MEASURED DIMENSION
- COMPUTED DIMENSION
- RECORDED DIMENSION
- FOUND IRON PIPE OR IRON ROD AT CORNER UNLESS OTHERWISE NOTED
- SET 5/8 INCH IRON ROD AT CORNER UNLESS OTHERWISE NOTED
- PERMANENT SURVEY MONUMENT, I.D.O.T. STD. 66701 (TO BE SET BY OTHERS)
- CUT CROSS FOUND OR SET
- SAME OWNERSHIP
- EXISTING BUILDING

- STAKING OF PROPOSED RIGHT OF WAY. SET 3/4 INCH METAL ROD WITH DIVISION OF HIGHWAY SURVEY MARKER TO MONUMENT THE POSITION SHOWN, IDENTIFIED BY INSCRIPTION DATA AND SURVEYORS REGISTRATION NUMBER.
- M STAKING OF PROPOSED RIGHT OF WAY IN CULTIVATED AREAS. SET 3/4 INCH METAL ROD WITH DIVISION OF HIGHWAY SURVEY MARKER 20 INCHES BELOW GROUND SURFACE TO MONUMENT THE POSITION SHOWN, IDENTIFIED BY INSCRIPTION DATA AND SURVEYORS REGISTRATION NUMBER.

STATE OF ILLINOIS)
COUNTY OF) 55

I, TERRY J. FELDMANN, AN ILLINOIS PROFESSIONAL LAND SURVEYOR, CERTIFY THAT I HAVE SURVEYED THE PLAT OF HIGHWAY SHOWN HEREON AND THAT THIS PROFESSIONAL SERVICE CONFORMS TO THE CURRENT ILLINOIS MINIMUM STANDARDS FOR A BOUNDARY SURVEY FOR THE PROPOSED PARCELS TO BE ACQUIRED BY THE STATE OF ILLINOIS, DEPARTMENT OF TRANSPORTATION, SHOWN HEREON.

DATED 10-17-2006

TERRY J. FELDMANN, PLS NO. 2973
LICENSE EXPIRATION DATE: 11/30/2008

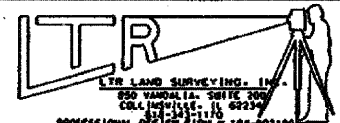

ILLINOIS DEPARTMENT OF TRANSPORTATION
PLAT OF HIGHWAYS
FAP ROUTE 682 (IL 4)
SECTION 21-1-1
RANDOLPH COUNTY
JOB NO. R-98-009-04

STATION 798+38.53 TO STATION 805+00.00
SCALE: 1" = 50'

COMPLETION DATE OF FIELD WORK PERFORMED
LAND SURVEY: AUGUST 12, 2004
RIGHT OF WAY STAKING: FEBRUARY 1, 2005

SHEET 1 IS A COVER SHEET

NO.	DATE	DESCRIPTION	BY

COORDINATES SHOWN HEREON ARE BASED ON SURVEY CONTROL DATA AS PROVIDED BY THE ILLINOIS DEPARTMENT OF TRANSPORTATION.

STATION	OFFSET	NORTH	EAST
797+22.66	78.10' RT	554,730.3800	2,429,832.6880
800+50.74	78.18' RT	555,058.4590	2,429,832.0520
800+82.25	100.24' LT	555,089.5860	2,429,653.5660
801+32.76	61.79' RT	555,140.4430	2,429,815.4900
801+48.26	100.24' LT	555,155.5930	2,429,653.4210
802+66.32	61.82' RT	555,214.0000	2,429,815.2310
803+06.32	61.83' RT	555,314.0000	2,429,815.1530
803+78.81	61.85' RT	555,386.4920	2,429,815.0130
807+06.93	45.47' RT	555,714.5810	2,429,797.9220
807+09.49	100.13' LT	555,716.8190	2,429,652.3160
807+09.48	42.83' LT	555,716.9330	2,429,709.6160
795+00.00	100.00' LT	554,507.3350	2,429,655.0696
798+38.53	0.00	554,846.0809	2,429,754.3358
805+00.00	0.00	555,507.5493	2,429,752.9028
801+15.65	0.00	555,123.2010	2,429,753.7350
802+86.38	0.00	555,293.9290	2,429,753.3650
102+20.28	0.00	555,119.1960	2,429,533.4920
102+14.89	0.00	555,291.7340	2,429,968.2450
102+20.28	31.60' LT	555,087.5998	2,49,534.0866
102+20.28	34.40' RT	555,153.5889	2,429,532.8666
102+14.89	21.00' LT	555,312.7354	2,429,968.4595
102+14.89	19.00' RT	555,272.7371	2,429,968.0509
NE Cor. Sec. 13, 4S, 6W		555,124.2530	2,429,753.5930
NW Cor. Sec. 18, 4S, 5W		555,293.9090	2,429,753.7000
NE Cor. Sec. 18, 4S, 5W		555,263.9360	2,435,237.3130
E 1/4 Cor. Sec. 12, 4S, 6W		557,762.5860	2,429,745.0560
S 1/4 Cor. Sec. 12, 4S, 6W		555,079.2790	2,427,047.6810
E 1/4 Cor. Sec. 13, 4S, 6W		552,483.5910	2,429,757.0160

Bruce G. and Nancy A. Cowell
(BK. 710, PG. 327)

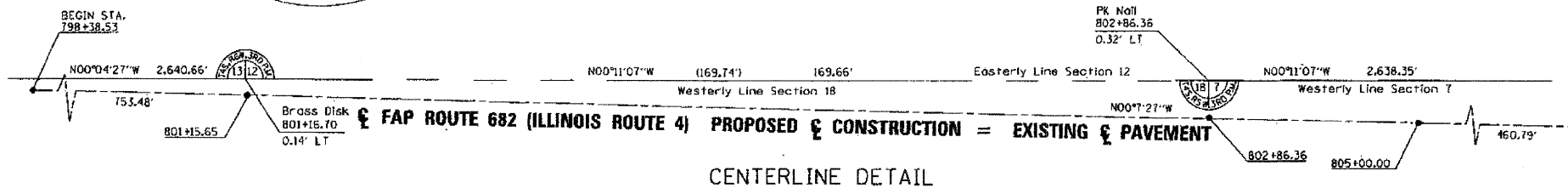
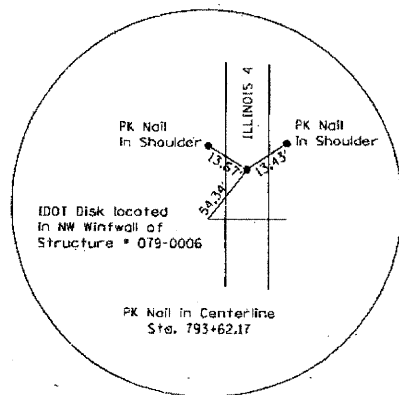

Peabody Coal Company
a Delaware Corp.
(BK. 235, PG. 100)

Robert D. and Esther Craig
(BK. 201, PG. 69)

Bruce G. and Nancy A. Cowell
(BK. 710, PG. 334)

DATE: TIME:
DATE: TIME:
DATE: TIME:
DATE: TIME:

PLOT DATE: DATE-TIME