

F.A.P. RTE.	SECTION	COUNTY	TOTAL SHEETS	SHEET NO.
310	MADISON		662	40
STA. 123+00		TO STA. 185+00		
FED. ROAD DIST. NO. 8		ILLINOIS FED. AID PROJECT		
CONTRACT NO. 76311				

F.A.P. 310 310-4 PI STA. = 124+63.18 $\Delta = 6^\circ 11' 43''$ (LT) $D = 1^\circ 00' 23''$ $R = 5,692.58'$ $T = 308.07'$ $L = 615.53'$ $E = 8.33'$ $e = 3.20\%$ $T.R. = 45.00'$ $S.E. RUN = 144.00'$ $P.C. STA. = 121+55.12$ $P.T. STA. = 127+70.65$	F.A.P. 310 310-5 PI STA. = 139+88.75 $\Delta = 23^\circ 14' 37''$ (RT) $D = 1^\circ 44' 47''$ $R = 3,280.83'$ $T = 674.76'$ $L = 1,330.96'$ $E = 68.67'$ $e = 4.80\%$ $T.R. = 40.00'$ $S.E. RUN = 216.00'$ $P.C. STA. = 133+14.00$ $P.T. STA. = 146+44.95$	F.A.P. 310 310-6 PI STA. = 160+96.28 $\Delta = 8^\circ 26' 25''$ (LT) $D = 1^\circ 29' 08''$ $R = 3,856.80'$ $T = 284.59'$ $L = 568.16'$ $E = 10.49'$ $e = 4.30\%$ $T.R. = 42.00'$ $S.E. RUN = 195.00'$ $P.C. STA. = 158+11.69$ $P.T. STA. = 163+79.84$	F.A.P. 310 310-7 PI STA. = 168+25.32 $\Delta = 17^\circ 30' 00''$ (LT) $D = 1^\circ 58' 47''$ $R = 2,894.31'$ $T = 445.48'$ $L = 884.02'$ $E = 34.08'$ $e = 5.20\%$ $T.R. = 40.00'$ $S.E. RUN = 234.00'$ $P.C. STA. = 163+79.84$ $P.T. STA. = 172+63.86$	LAGEMANN ROAD L-1 PI STA. = 16+23.15 $\Delta = 26^\circ 48' 44''$ (LT) $D = 7^\circ 09' 43''$ $R = 800.00'$ $T = 190.68'$ $L = 374.37'$ $E = 22.41'$ $e = 8.00\%$ $T.R. = 33.00'$ $S.E. RUN = 176.00'$ $P.C. STA. = 14+32.48$ $P.T. STA. = 18+06.84$	LAGEMANN ROAD L-2 PI STA. = 21+68.22 $\Delta = 7^\circ 54' 01''$ (RT) $D = 2^\circ 36' 16''$ $R = 2,200.00'$ $T = 151.91'$ $L = 303.35'$ $E = 5.24'$ $e = 5.00\%$ $T.R. = 33.00'$ $S.E. RUN = 110.00'$ $P.C. STA. = 20+16.31$ $P.T. STA. = 23+19.66$
---	---	--	---	---	---

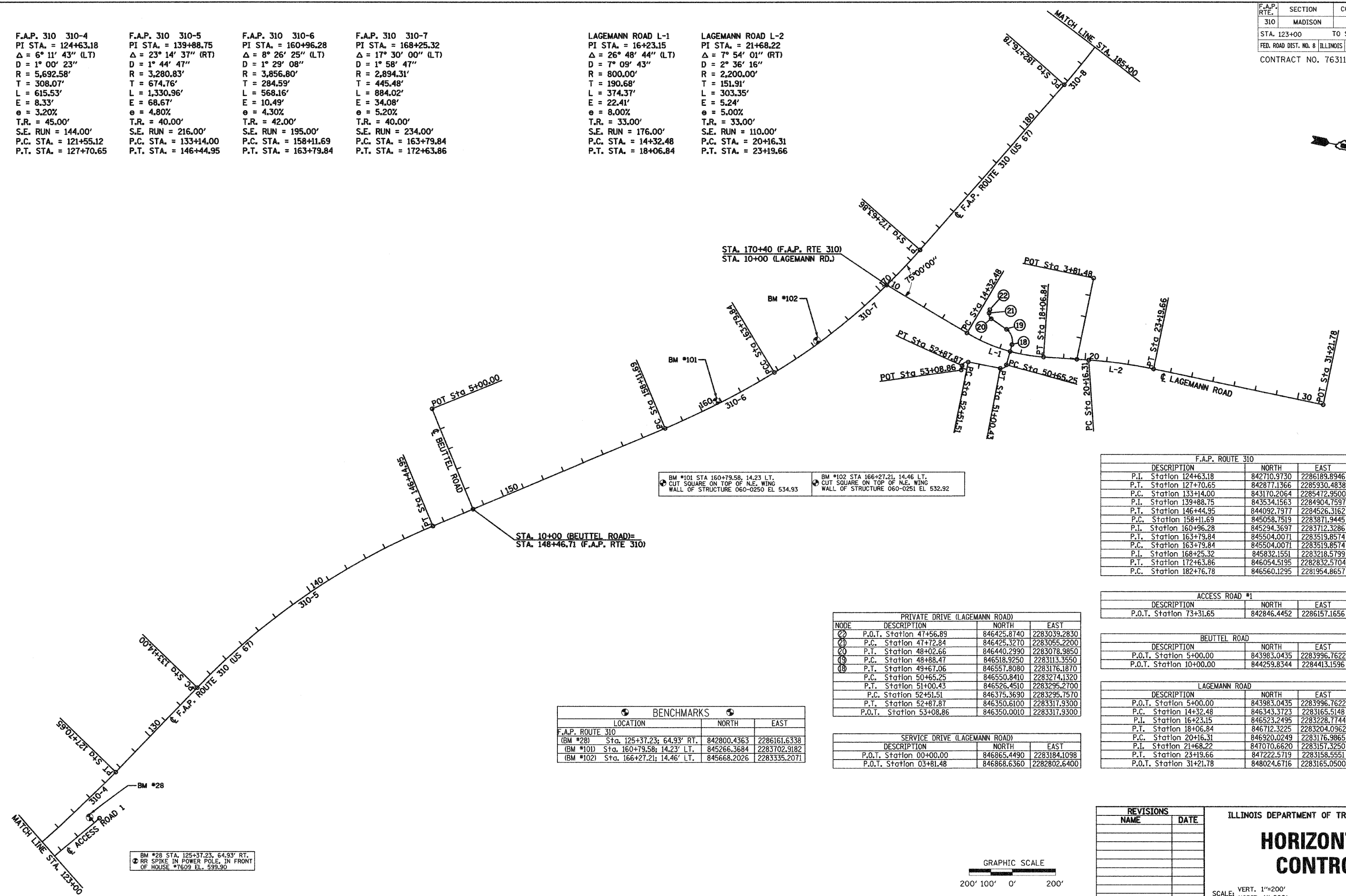

BM #101 STA 160+79.58, 14.23 LT. CUT SQUARE ON TOP OF N.E. WING WALL OF STRUCTURE 060-0250 EL 534.93

BM #102 STA 166+27.21, 14.46 LT. CUT SQUARE ON TOP OF N.E. WING WALL OF STRUCTURE 060-0251 EL 532.92

BM #28 STA. 125+37.23, 64.93' RT. RR SPIKE IN POWER POLE, IN FRONT OF HOUSE #7609 EL. 539.90

F.A.P. ROUTE 310		
DESCRIPTION	NORTH	EAST
P.I. Station 124+63.18	842710.9730	2286189.8946
P.T. Station 127+70.65	842877.1366	2285930.4838
P.C. Station 133+14.00	843170.2064	2285472.9500
P.I. Station 139+88.75	843534.1563	2284904.7597
P.T. Station 146+44.95	844092.7977	2284526.3162
P.C. Station 158+11.69	845058.7519	2283871.9445
P.I. Station 160+96.28	845294.3697	2283712.3286
P.T. Station 163+79.84	845504.0071	2283519.8574
P.C. Station 163+79.84	845504.0071	2283519.8574
P.I. Station 168+25.32	845832.1551	2283218.5799
P.T. Station 172+63.86	846054.5195	2282832.5704
P.C. Station 182+76.78	846560.1295	2281954.8657

ACCESS ROAD #1		
DESCRIPTION	NORTH	EAST
P.O.T. Station 73+31.65	842846.4452	2286157.1656

BEUTTEL ROAD		
DESCRIPTION	NORTH	EAST
P.O.T. Station 5+00.00	843983.0435	2283996.7622
P.O.T. Station 10+00.00	844259.8344	2284413.1596

LAGEMANN ROAD		
DESCRIPTION	NORTH	EAST
P.O.T. Station 5+00.00	843983.0435	2283996.7622
P.C. Station 14+32.48	846343.3723	2283165.5148
P.I. Station 16+23.15	846523.2495	2283228.7744
P.T. Station 18+06.84	846712.3225	2283204.0962
P.C. Station 20+16.31	846920.0249	2283176.9865
P.I. Station 21+68.22	847070.6620	2283157.3250
P.T. Station 23+19.66	847222.5719	2283158.5551
P.O.T. Station 31+21.78	848024.6716	2283165.0500

PRIVATE DRIVE (LAGEMANN ROAD)			
NODE	DESCRIPTION	NORTH	EAST
22	P.O.T. Station 47+56.89	846425.8740	2283039.2830
21	P.C. Station 47+72.84	846425.3270	2283055.2200
20	P.T. Station 48+02.66	846440.2990	2283078.9850
19	P.C. Station 48+88.47	846518.9250	2283113.3550
18	P.T. Station 49+67.06	846557.8080	2283176.1870
	P.C. Station 50+65.25	846550.8410	2283274.1320
	P.T. Station 51+00.43	846526.4510	2283295.2700
	P.C. Station 52+51.51	846375.3690	2283295.7570
	P.T. Station 52+87.87	846350.6100	2283317.9300
	P.O.T. Station 53+08.86	846350.0010	2283317.9300

SERVICE DRIVE (LAGEMANN ROAD)			
DESCRIPTION	NORTH	EAST	
P.O.T. Station 00+00.00	846865.4490	2283184.1098	
P.O.T. Station 03+81.48	846868.6360	2282802.6400	

BENCHMARKS			
LOCATION	NORTH	EAST	
F.A.P. ROUTE 310			
(BM #28) Sta. 125+37.23; 64.93' RT.	842800.4363	2286161.6338	
(BM #101) Sta. 160+79.58; 14.23' LT.	845266.3684	2283702.9182	
(BM #102) Sta. 166+27.21; 14.46' LT.	845668.2026	2283335.2071	

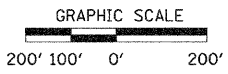

REVISIONS	
NAME	DATE

ILLINOIS DEPARTMENT OF TRANSPORTATION

HORIZONTAL CONTROL

SCALE: VERT. 1"=200'
 HORIZ. 1"=200'
 DATE: 09-04-09

DRAWN BY: JWC
 CHECKED BY: JMR