

F.A. RTE.	SECTION	COUNTY	TOTAL SHEETS	SHEET NO.
310	60-16	MADISON	662	87
STA. 207+40		TO STA. 240+00		
FED. ROAD DIST. NO. 8 ILLINOIS FED. AID PROJECT				
CONTRACT NO. 76311				

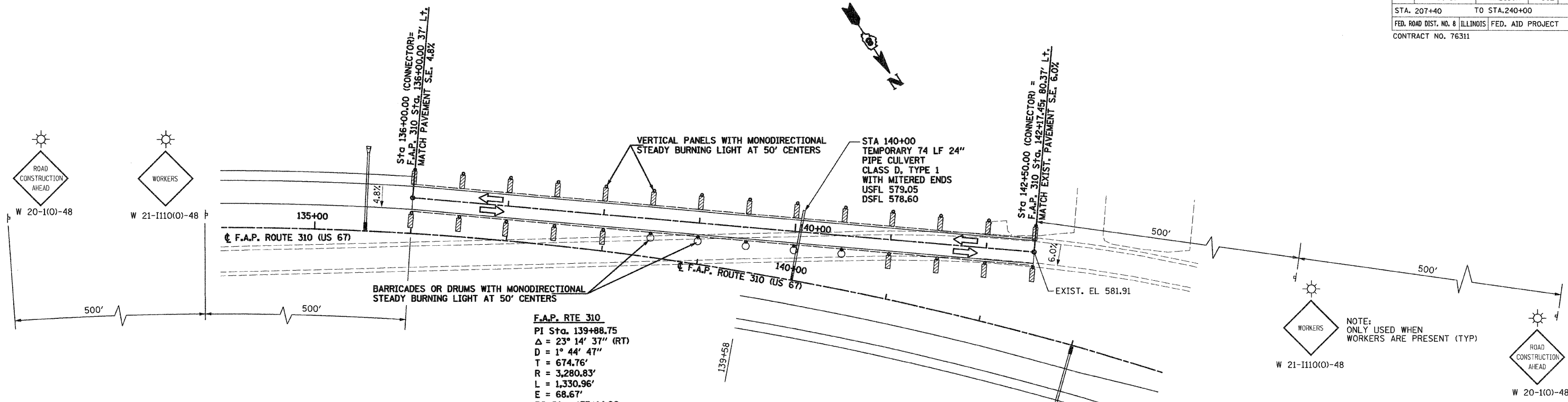

F.A.P. RTE 310
 PI Sta. 139+88.75
 $\Delta = 23^\circ 14' 37''$ (RT)
 $D = 1^\circ 44' 47''$
 $T = 674.76'$
 $R = 3,280.83'$
 $L = 1,330.96'$
 $E = 68.67'$
 PC Sta. 133+14.00
 PT Sta. 146+44.95
 SE RATE = 4.8%
 SE ATTAINED:
 Sta. 131+30.00 TO Sta. 133+86.00
 Sta. 145+72.95 TO Sta. 148+28.95

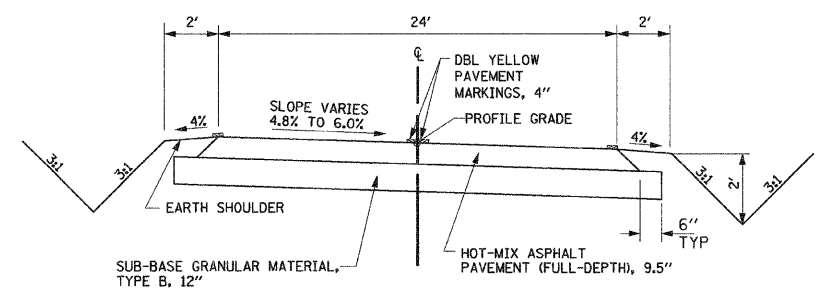

TYPICAL TANGENT SECTIONS FOR CONNECTOR

- SYMBOLS**
- Sign
 - Barricade or drum with monodirectional steady burning light
 - Vertical panel with Monodirectional Steady Burning Lights
 - Type III barricade with Flashers
 - Flashing Light
 - Arrow Board
 - Directional Indicator Barricades

ADDITIONAL SIGNING AND TRAFFIC CONTROL SHALL BE IN ACCORDANCE WITH TRAFFIC CONTROL AND PROTECTION, SPECIAL I (SEE SHEET 94 FOR DETAILS)

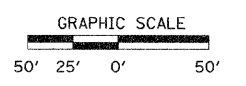
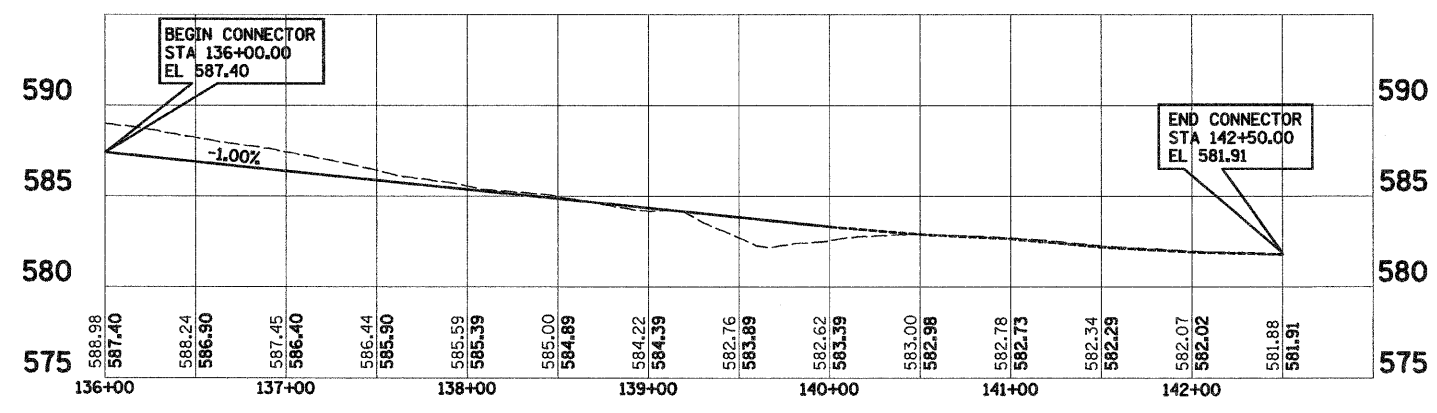

REVISIONS	
NAME	DATE

ILLINOIS DEPARTMENT OF TRANSPORTATION

CONNECTOR DETAIL NO. 1

SCALE: VERT. _____
 HORIZ. _____
 DATE: 09-04-09

DRAWN BY: T.W.C.
 CHECKED BY: J.J.C.