

F.A. RTE.	SECTION	COUNTY	TOTAL SHEETS	SHEET NO.
310	60-16	MADISON	662	93

STA. 207+40 TO STA. 240+00  
 FED. ROAD DIST. NO. 8 ILLINOIS FED. AID PROJECT  
 CONTRACT NO. 76311

**CROSS OVER CURVE DATA**  
 PI STA. = 2+95.72  
 $\Delta = 22^\circ 18' 19''$  (RT)  
 $D = 3^\circ 49' 11''$   
 $R = 1,500.00'$   
 $T = 295.72'$   
 $L = 583.95'$   
 $E = 28.87'$   
 $e = 5.9\%$   
 $T.R. = 42$   
 $S.E. RUN = 158$   
 P.C. STA. = 0+00.00  
 P.T. STA. = 5+83.95

PI Sta. 215+34.35  
 $\Delta = 45^\circ 06' 44''$  (RT)  
 $D = 2^\circ 45' 01''$   
 $T = 865.32'$   
 $R = 2,083.30'$   
 $L = 1,640.30'$   
 $E = 172.56'$   
 PC Sta. 206+69.03  
 PT Sta. 223+09.32  
 S.E. RATE 5.9%  
 S.E. ATTAINED  
 Sta. 204+52.03 TO Sta. 207+58.03  
 Sta. 222+20.32 TO Sta. 225+26.32

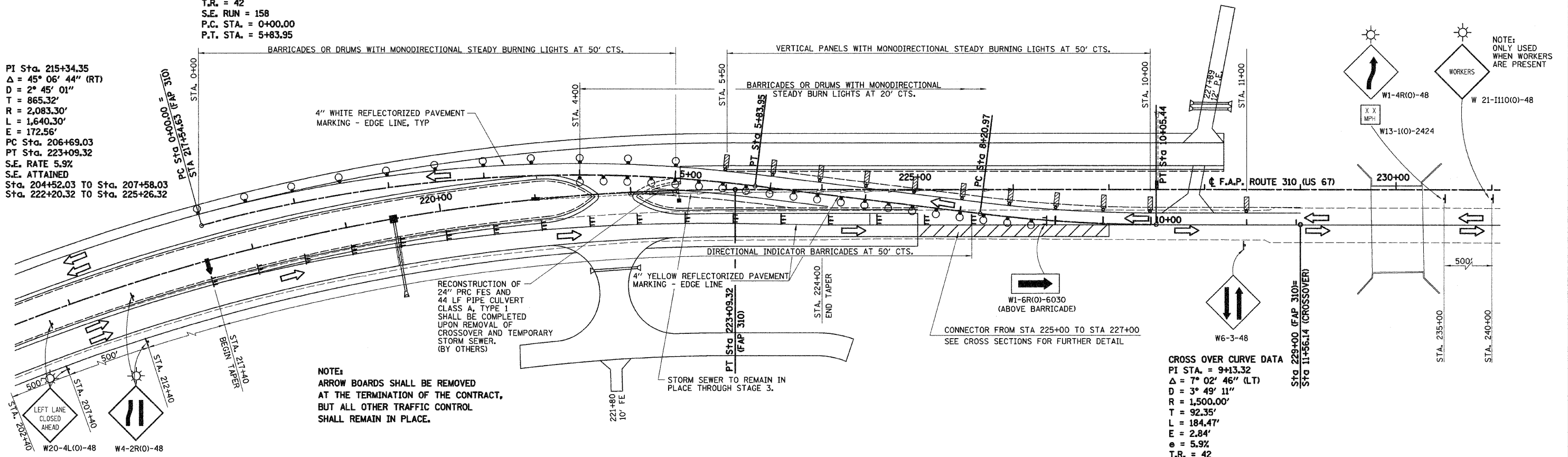

**NOTE:**  
 ARROW BOARDS SHALL BE REMOVED AT THE TERMINATION OF THE CONTRACT, BUT ALL OTHER TRAFFIC CONTROL SHALL REMAIN IN PLACE.

**CROSS OVER CURVE DATA**  
 PI STA. = 9+13.32  
 $\Delta = 7^\circ 02' 46''$  (LT)  
 $D = 3^\circ 49' 11''$   
 $R = 1,500.00'$   
 $T = 92.35'$   
 $L = 184.47'$   
 $E = 2.84'$   
 $e = 5.9\%$   
 $T.R. = 42$   
 $S.E. RUN = 158$   
 P.C. STA. = 8+20.97  
 P.T. STA. = 10+05.44

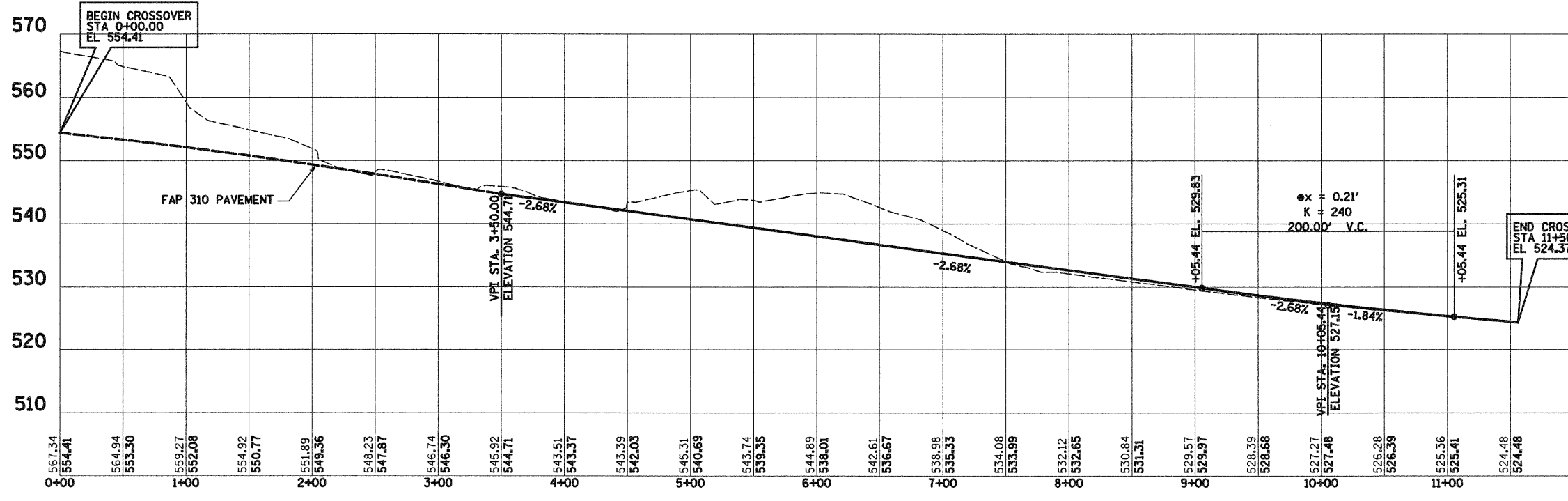

**TRAFFIC CONTROL AND PROTECTION (SPECIAL) LOCATION 2**

- Sign
- Barricade or drum with monodirectional steady burning light
- Vertical panel with Monodirectional Steady Burning Lights
- Type III barricade with Flashers
- Flashing Light
- Arrow Board
- Directional Indicator Barricades

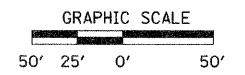

ILLINOIS DEPARTMENT OF TRANSPORTATION

# CROSS OVER DETAIL NO. 4 STAGE 3

SCALE: VERT. DATE: 09-04-09  
 DRAWN BY: T.W.C.  
 CHECKED BY: J.J.C.

REVISIONS	
NAME	DATE