

DATE: 6/23/11
 BY: J.C. MARR
 SURVEYED: []
 PLOTTED: []
 CHECKED: []
 REVISIONS: []
 NO. OF WAY CHECKED: []
 CADD FILE NAME: []

DATE: []
 BY: []
 SURVEYED: []
 PLOTTED: []
 CHECKED: []
 REVISIONS: []
 NO. OF WAY CHECKED: []
 STRUCTURE NOTATION: CPWD

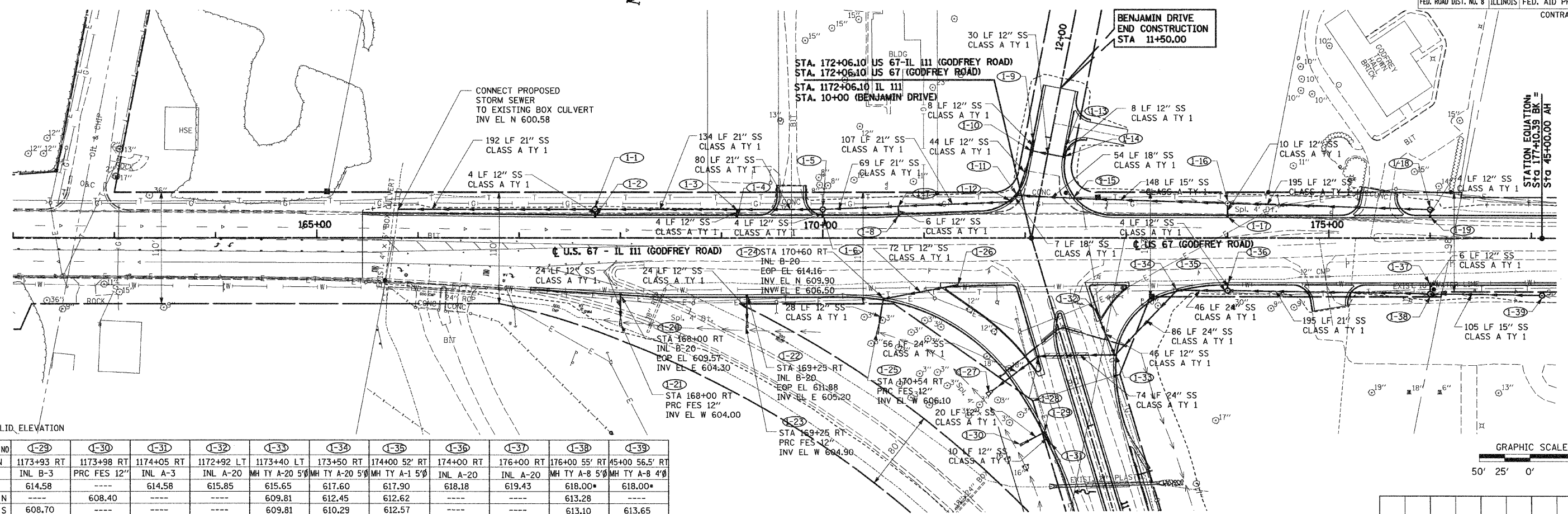

* GRATE/LID, ELEVATION

STRUCTURE NO	I-29	I-30	I-31	I-32	I-33	I-34	I-35	I-36	I-37	I-38	I-39
STATION	1173+93 RT	1173+98 RT	1174+05 RT	1172+92 LT	1173+40 LT	173+50 RT	174+00 52' RT	174+00 RT	176+00 RT	176+00 55' RT	45+00 56.5' RT
TYPE	INL B-3	PRC FES 12"	INL A-3	INL A-20	MH TY A-20 5'	MH TY A-20 5'	MH TY A-1 5'	INL A-20	INL A-20	MH TY A-8 5'	MH TY A-8 4'
EOP EL	614.58	---	614.58	615.85	615.65	617.60	617.90	618.18	619.43	618.00*	618.00*
INV EL N	---	608.40	---	---	609.81	612.45	612.62	---	---	613.28	---
INV EL S	608.70	---	---	---	609.81	610.29	612.57	---	---	613.10	613.65
INV EL E	610.34	---	---	611.77	---	---	---	614.18	615.43	---	---
INV EL W	---	---	610.44	---	610.90	---	614.08	---	---	615.33	---

STRUCTURE NO	I-1	I-2	I-3	I-4	I-5	I-6	I-7	I-8	I-9	I-10	I-11	I-12	I-13	I-14	I-15	I-16	I-17	I-18	I-19	I-26	I-27	I-28	
STATION	167+75 28' LT	167+75 LT	169+15 LT	169+15 LT	170+00 28' LT	170+00 LT	170+75 LT	170+75 LT	10+94 LT	10+84 LT	171+92.85 LT	171+86.20 LT	10+94 RT	10+84 RT	172+47.5 LT	174+00 34' LT	174+00 34' LT	176+00 28' LT	176+00 LT	171+33 RT	1173+41 RT	1173+20 RT	
TYPE	MH TY A-1 5'	INL A-20	RCP TEE	INL B-20	MH TY A-1 5'	INL A-20	RCP TEE	INL B-20	INL A-3	INL B-3	MH TY A-3 5'	MH TY A-3 5'	INL A-20	INL B-3	MH TY A-20 4'	MH TY A-8 4'	INL A-20	MH TY A-1 4'	INL A-20	INL B-15	PRC FES 24"	MH TY A-20 5'	
EOP EL	609.80*	609.32	21"x12"	611.95	613.90*	613.37	21"x12"	614.50	615.72	615.40	615.40	615.69	615.72	615.70	615.70	616.50*	618.18	619.20*	619.43	615.31	---	615.48	
INV EL N	604.42	---	---	---	608.47	---	---	---	---	---	611.05	---	---	---	611.62	612.42	---	615.35	---	---	607.70	609.63	
INV EL S	602.53	---	---	---	606.58	---	---	---	---	---	609.05	---	---	611.64	611.24	612.15	---	615.35	---	610.65	---	607.90	
INV EL E	605.22	---	---	---	609.27	---	---	---	611.59	611.49	611.05	---	611.74	---	614.08	---	---	615.35	---	---	---	---	---
INV EL W	---	605.32	---	606.25	---	609.37	---	609.18	---	611.49	611.23	610.94	---	611.64	---	---	614.18	---	615.43	---	---	---	---

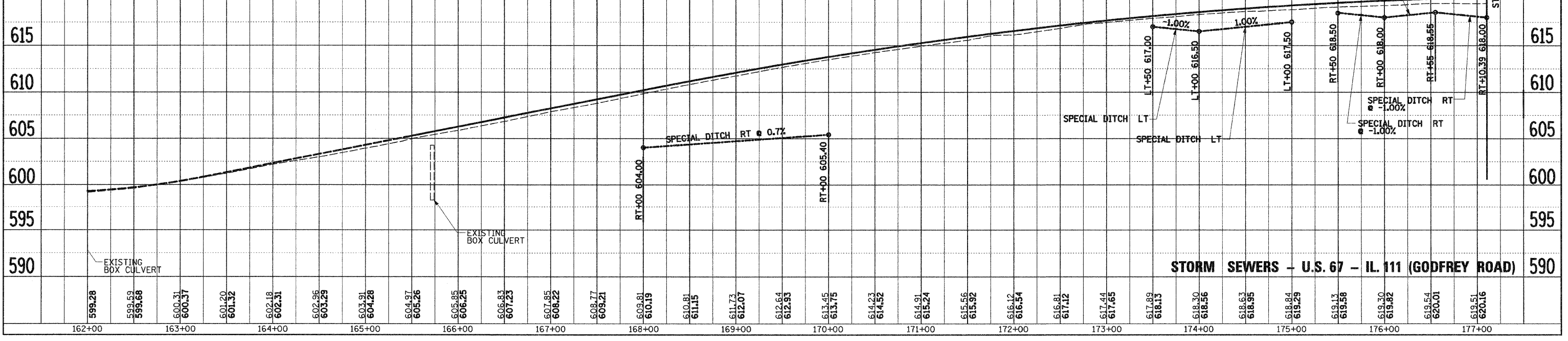
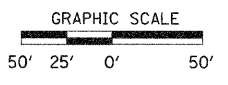

STORM SEWERS - U.S. 67 - IL 111 (GODFREY ROAD)