

STATIONING ALONG US 67	OFFSET TO EOP	EDGE OF PAVT ELEV	STATIONING ALONG ACCESS ROAD 2	OFFSET TO EOP
	FEET	FEET		FEET
48+21.00	20.00 LT	619.53	10+20.00	65.00 LT
48+40.47	24.00 LT	619.30	10+23.95	45.53 LT
48+56.87	35.17 LT	619.06	10+35.17	29.13 LT
48+67.60	51.88 LT	618.83	10+51.88	18.40 LT
48+71.00	70.00 LT	618.62	10+70.00	15.00 LT

STATIONING ALONG US 67	OFFSET TO EOP	EDGE OF PAVT ELEV	STATIONING ALONG ACCESS ROAD 2	OFFSET TO EOP
	FEET	FEET		FEET
49+51.00	18.00 LT	619.16	10+18.00	65.00 RT
49+31.53	21.95 LT	619.03	10+21.95	45.53 RT
49+15.13	33.17 LT	618.89	10+33.17	29.13 RT
49+04.40	49.88 LT	618.76	10+49.88	18.40 RT
49+01.00	68.00 LT	618.64	10+68.00	15.00 RT

STATIONING ALONG US 67	OFFSET TO EOP	EDGE OF PAVT ELEV	STATIONING ALONG ACCESS ROAD 3	OFFSET TO EOP
	FEET	FEET		FEET
49+51.00	42.00 RT	619.13	10+42.00	65.00 RT
49+31.53	45.95 RT	618.89	10+45.95	45.53 RT
49+15.13	57.17 RT	618.62	10+57.17	29.13 RT
49+04.40	73.88 RT	618.35	10+73.88	18.40 RT
49+01.00	92.00 RT	618.09	10+92.00	15.00 RT

STATIONING ALONG US 67	OFFSET TO EOP	EDGE OF PAVT ELEV	STATIONING ALONG ACCESS ROAD 3	OFFSET TO EOP
	FEET	FEET		FEET
48+21.00	44.00 RT	619.56	10+44.00	65.00 RT
48+40.47	47.95 RT	619.18	10+47.95	45.53 RT
48+56.87	59.17 RT	618.80	10+59.17	29.13 RT
48+67.60	75.88 RT	618.41	10+75.88	18.40 RT
48+71.00	94.00 RT	618.07	10+94.00	15.00 RT

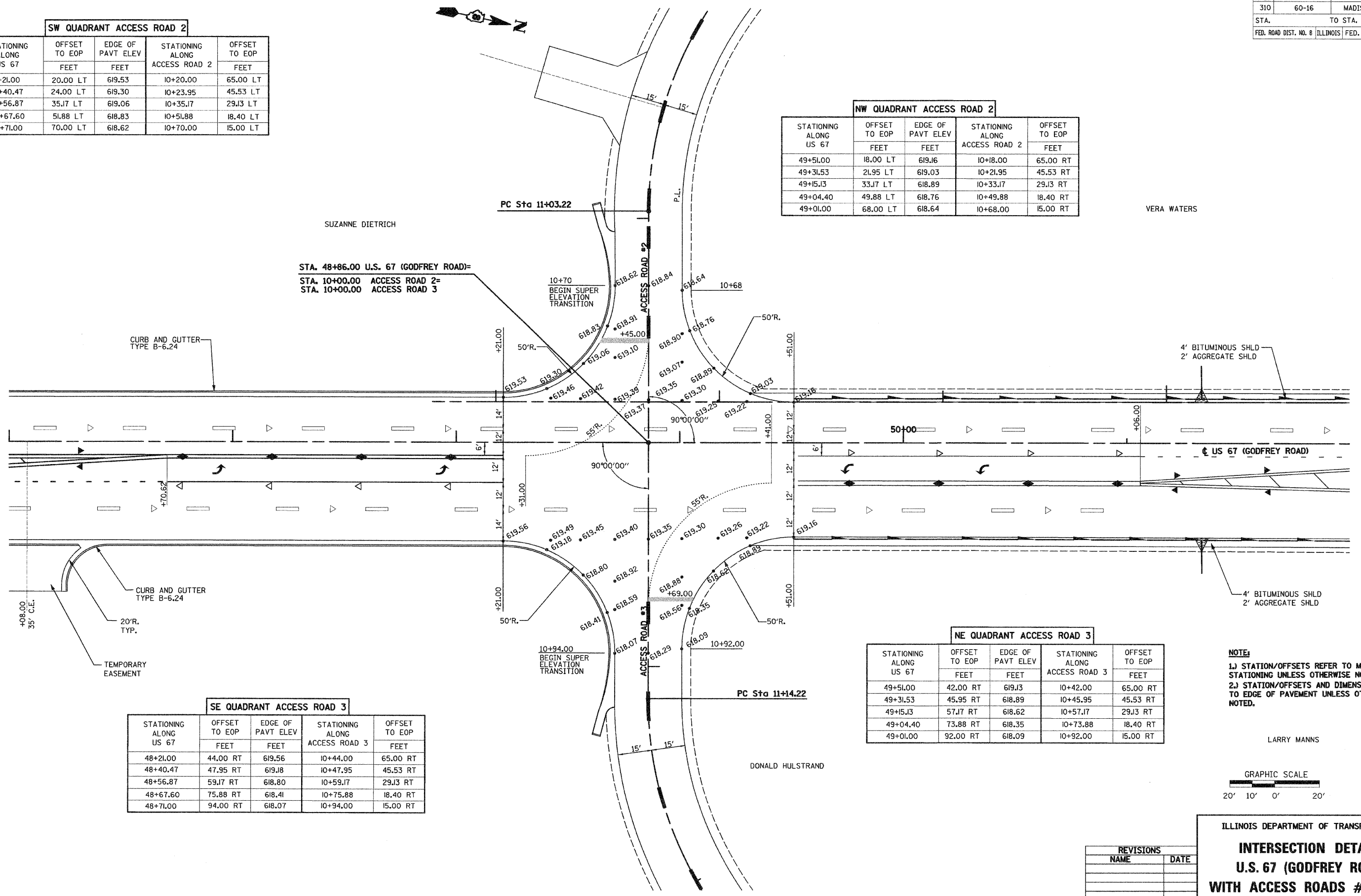

NOTE:
 1.) STATION/OFFSETS REFER TO MAINLINE STATIONING UNLESS OTHERWISE NOTED.
 2.) STATION/OFFSETS AND DIMENSIONS ARE TO EDGE OF PAVEMENT UNLESS OTHERWISE NOTED.

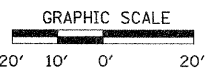

ILLINOIS DEPARTMENT OF TRANSPORTATION
INTERSECTION DETAILS
U.S. 67 (GODFREY ROAD)
WITH ACCESS ROADS #2 & #3

REVISIONS	
NAME	DATE

SCALE: VERT. _____
 HORIZ. _____
 DATE: 09-04-09
 DRAWN BY: T.W.C.
 CHECKED BY: J.J.C.