

F.A.P. RTE.	SECTION	COUNTY	TOTAL SHEETS	SHEET NO.
310	60-16	MADISON	662	166
STA. 57+00		TO STA. 110+00		
FED. ROAD DIST. NO. 8		ILLINOIS FED. AID PROJECT		
CONTRACT NO. 76311				

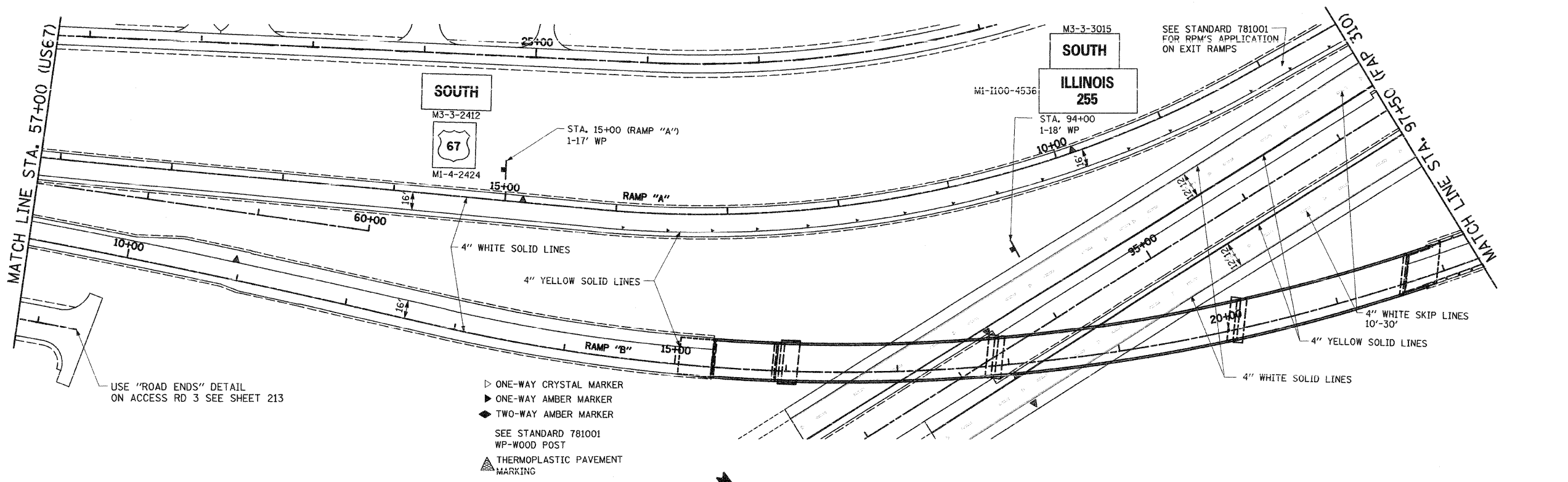

USE "ROAD ENDS" DETAIL ON ACCESS RD 3 SEE SHEET 213

- ▶ ONE-WAY CRYSTAL MARKER
- ▶ ONE-WAY AMBER MARKER
- ◆ TWO-WAY AMBER MARKER
- SEE STANDARD 781001 WP-WOOD POST
- ▲ THERMOPLASTIC PAVEMENT MARKING

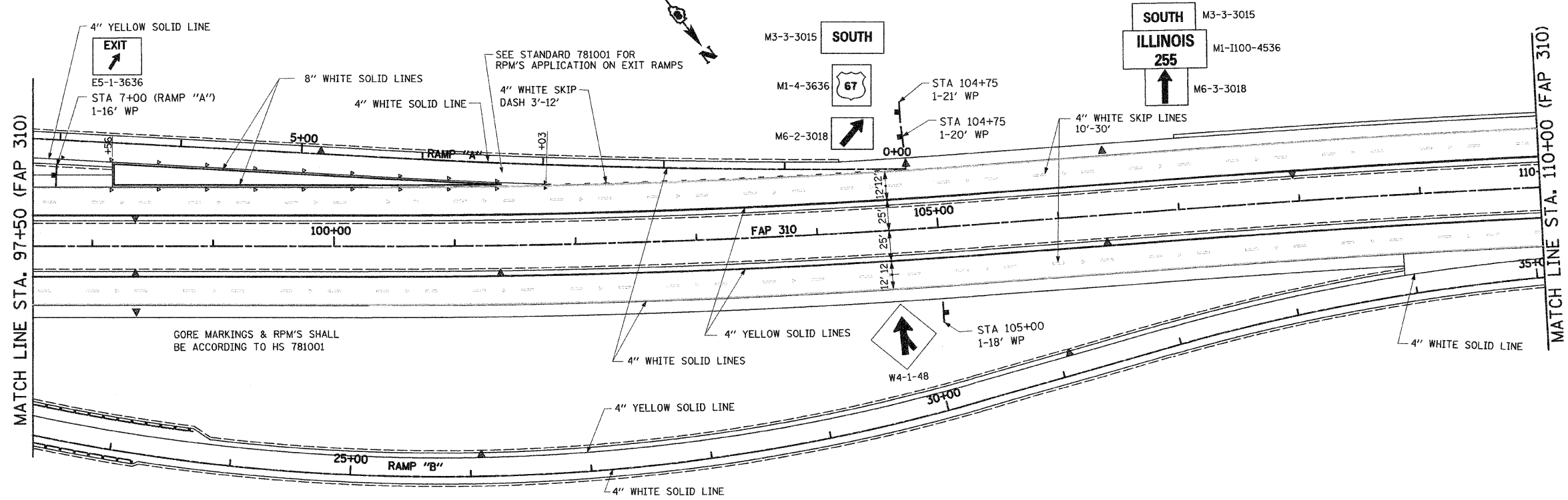

GORE MARKINGS & RPM'S SHALL BE ACCORDING TO HS 781001

REVISIONS	
NAME	DATE

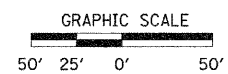

ILLINOIS DEPARTMENT OF TRANSPORTATION

SIGNING AND PAVEMENT MARKING PLANS

SCALE: VERT. _____
 HORIZ. _____
 DATE: 09-04-09

DRAWN BY: J.J.
 CHECKED BY: J.J.C.