

STATE OF ILLINOIS  
DEPARTMENT OF TRANSPORTATION

Notes:  
See sheet 12 of 21 for Sections C-C & D-D and View E-E.  
 $a_{10}(E)$ ,  $a_{11}(E)$ , and  $w_{10}(E)$  bar spacings measured parallel to  $\text{C}$  Rdwy.

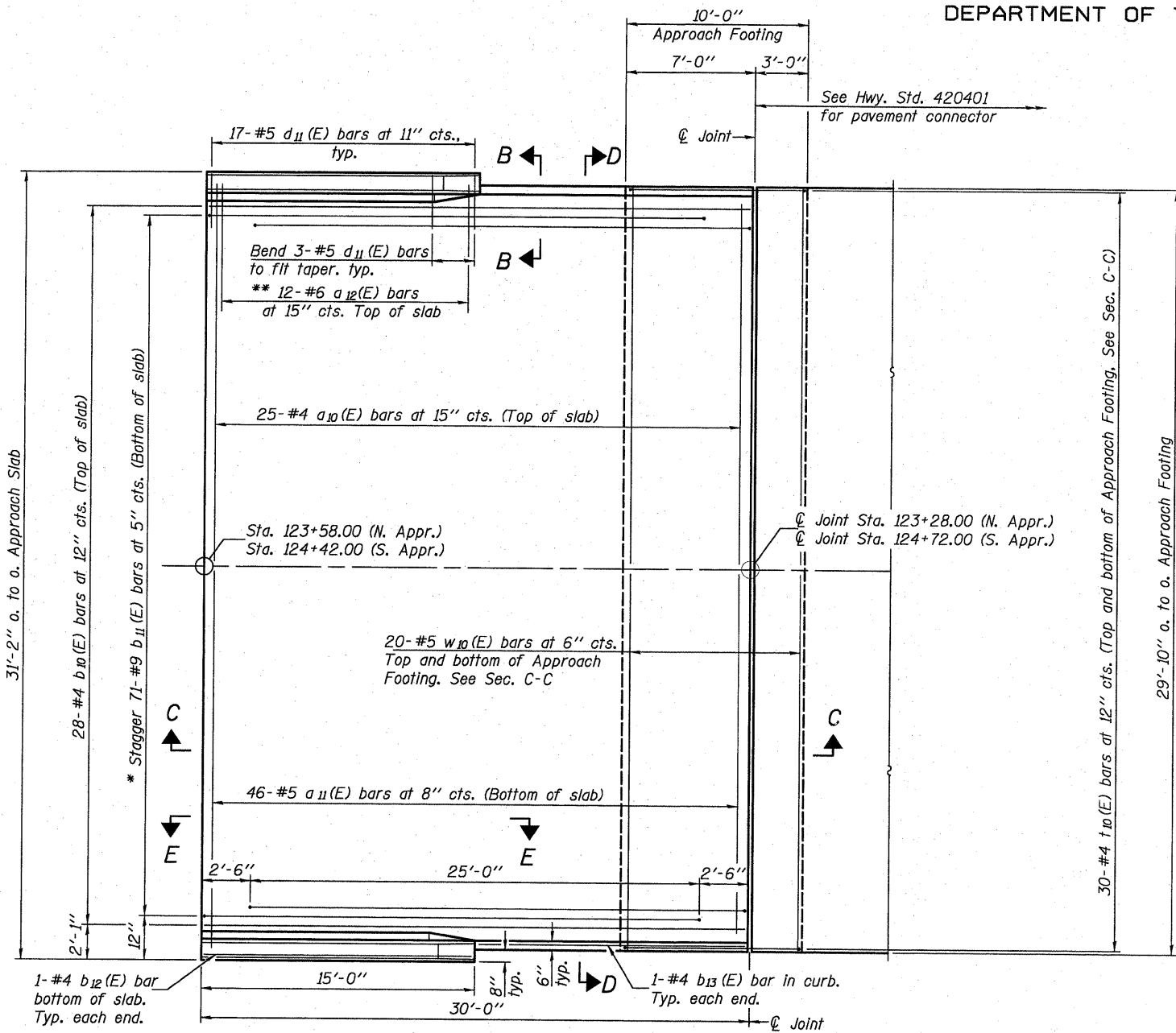

**PLAN**  $\blacktriangle$  N  
(South Approach shown, North Approach similar)

\* Tilt #9  $b_{11}(E)$  bars as required to maintain clearance.  
\*\* Alternate with  $a_{10}(E)$  bars, typ. ea. parapet.

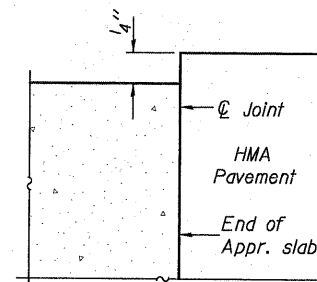

**DETAIL A**

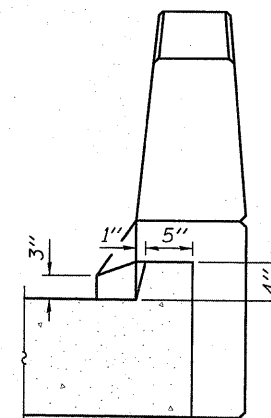

**VIEW B-B**  
(Exit ends only)

|          |        |
|----------|--------|
| DESIGNED | B.G.H. |
| CHECKED  | L.D.G. |
| DRAWN    | K.H.L. |
| CHECKED  | B.G.H. |

BA-0 10-31-08

(Sheet 1 of 2)  
**BRIDGE APPROACH SLAB DETAILS**

|                           |                    |                           |                    |                     |                 |
|---------------------------|--------------------|---------------------------|--------------------|---------------------|-----------------|
| SHEET NO. 11<br>21 SHEETS | F.A.S. RTE.<br>739 | SECTION<br>401-2BR        | COUNTY<br>GREENE   | TOTAL SHEETS<br>150 | SHEET NO.<br>44 |
|                           | S.N. 031-0041      |                           | CONTRACT NO. 76410 |                     |                 |
| FED. ROAD DIST. NO.       |                    | ILLINOIS FED. AID PROJECT |                    |                     |                 |