

FINAL SURVEY	DATE
SURVEYED	
NOTED	
TEMPERATURE	
AREAS	
CHECKED	
NO.	

ORIGINAL SURVEY	DATE
SURVEYED	
NOTED	
TEMPERATURE	
AREAS	
CHECKED	
NO.	

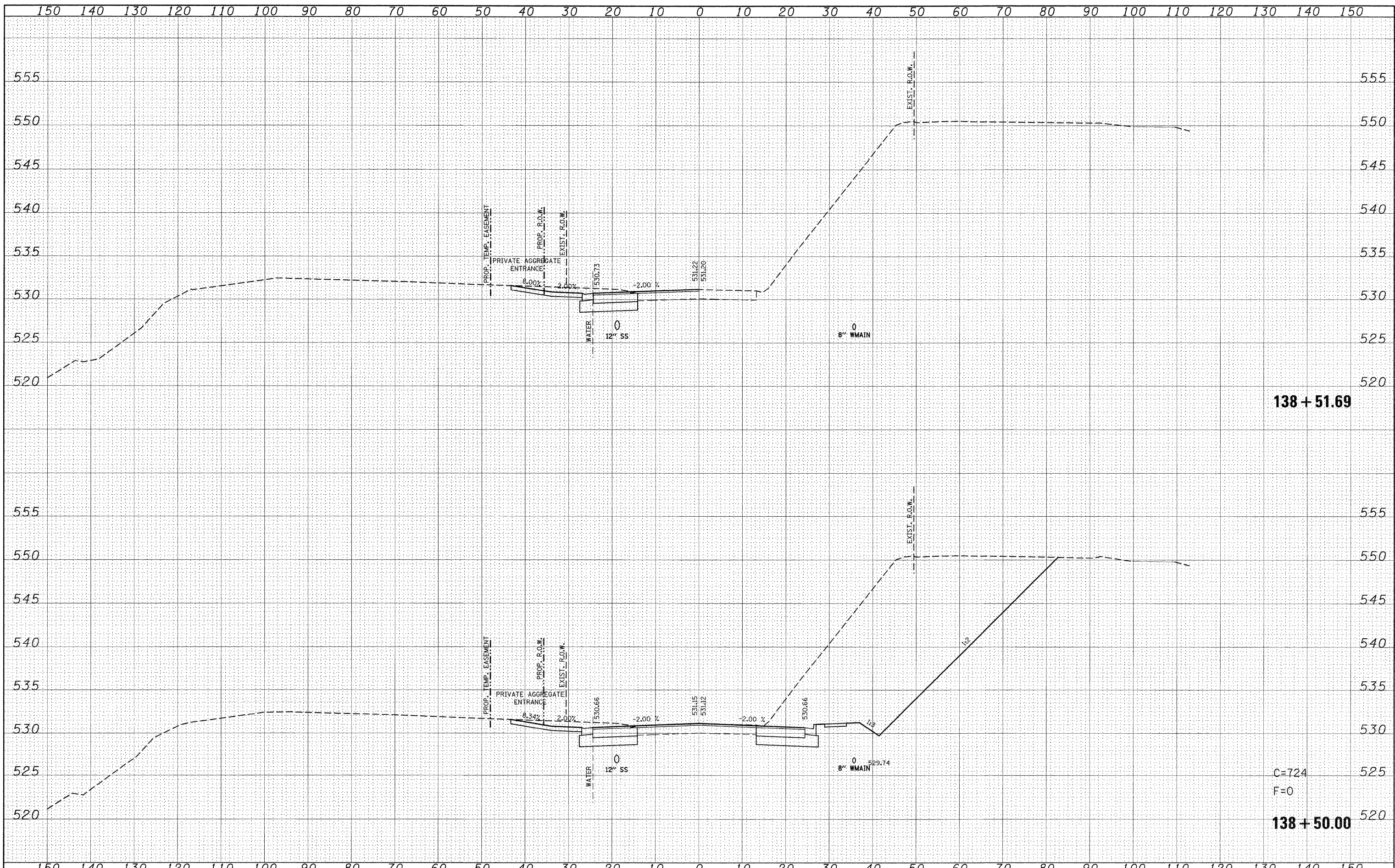

FILE NAME =	USER NAME = default	DESIGNED -	REVISED -	<b>STATE OF ILLINOIS DEPARTMENT OF TRANSPORTATION</b>	<b>IL ROUTE 159 MAINLINE CROSS SECTIONS</b>		F.A.P. RTE.	SECTION	COUNTY	TOTAL SHEETS	SHEET NO.
ps:\projects\15135\01\road\vdgn\vd676838-sht-xssht-1159.dgn		DRAWN -	REVISED -		600	60-(30,31,128)-1	ST. CLAIR/MADISON	399	327		
PLOT SCALE = 10.0000' / IN.		CHECKED -	REVISED -		CONTRACT NO. 76830						
PLOT DATE = 8/24/2009		DATE -	REVISED -		ILLINOIS FED. AID PROJECT						
				SCALE:	SHEET NO. 48 OF 120 SHEETS	STA. 138+50.00 TO STA. 138+51.69					