

FINAL SURVEY	SURVEYED	DATE
NOTE BOOK NO.	TEMPLATE AREAS CHECKED	

ORIGINAL SURVEY	SURVEYED	DATE
NOTE BOOK NO.	TEMPLATE AREAS CHECKED	

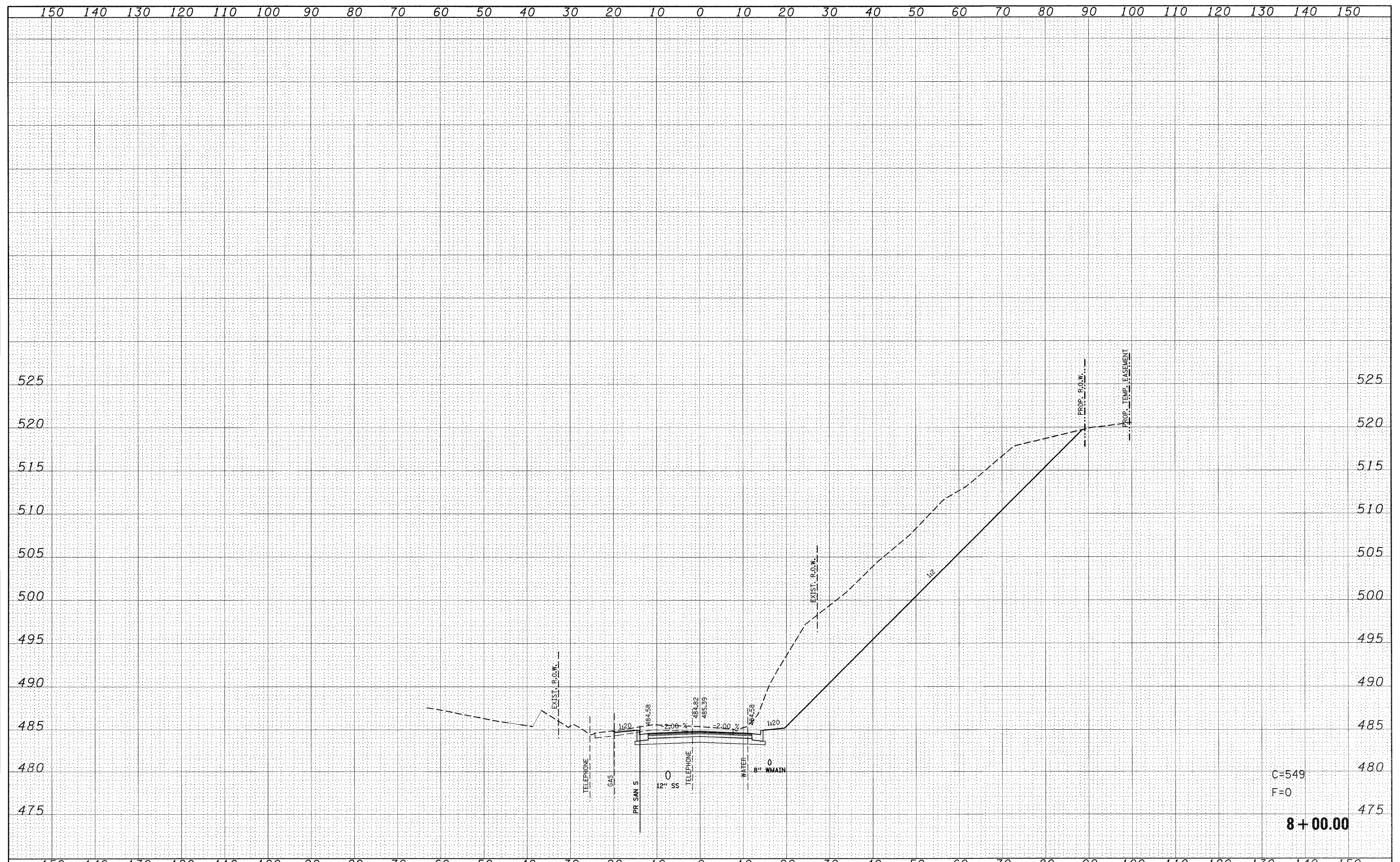

C=549  
F=0  
**8+00.00**

FILE NAME = p:\projects\513581\cadd\dgn\d876838-sht-xasht-	USER NAME = default	DESIGNED -	REVISED -	<b>STATE OF ILLINOIS DEPARTMENT OF TRANSPORTATION</b>	<b>SOUTH CLINTON ST SIDE ROAD CROSS SECTIONS</b>			F.A.P. RTE. 600	SECTION 60-(30,31,128)-1	COUNTY ST. CLAIR/MADISON	TOTAL SHEETS 399	SHEET NO. 354
	Clinton.dgn	DRAWN -	REVISED -		SCALE:	SHEET NO. 75 OF 120 SHEETS	STA. 8+00.00	TO STA. 8+00.00	CONTRACT NO. 76830			
	PLOT SCALE = 10.0000' / IN.	CHECKED -	REVISED -		[ILLINOIS] FED. AID PROJECT							
	PLOT DATE = 8/24/2009	DATE -	REVISED -									