

**LEGEND:**

- PAVEMENT REMOVAL
- SIDEWALK REMOVAL
- MEDIAN REMOVAL
- SHOULDER REMOVAL
- DRIVEWAY/ ENTRANCE REMOVAL
- PATCHING
- PAVEMENT REMOVAL (BRIDGE APPROACH)
- LINEAR REMOVAL
- TREE REMOVAL (UNITS)

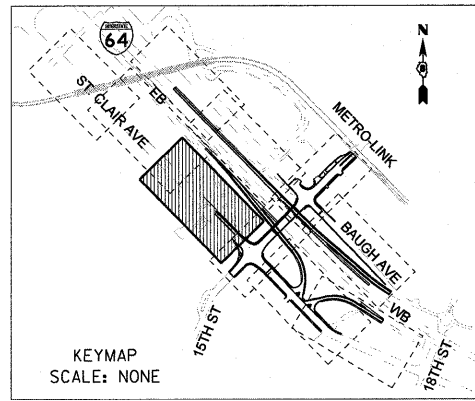
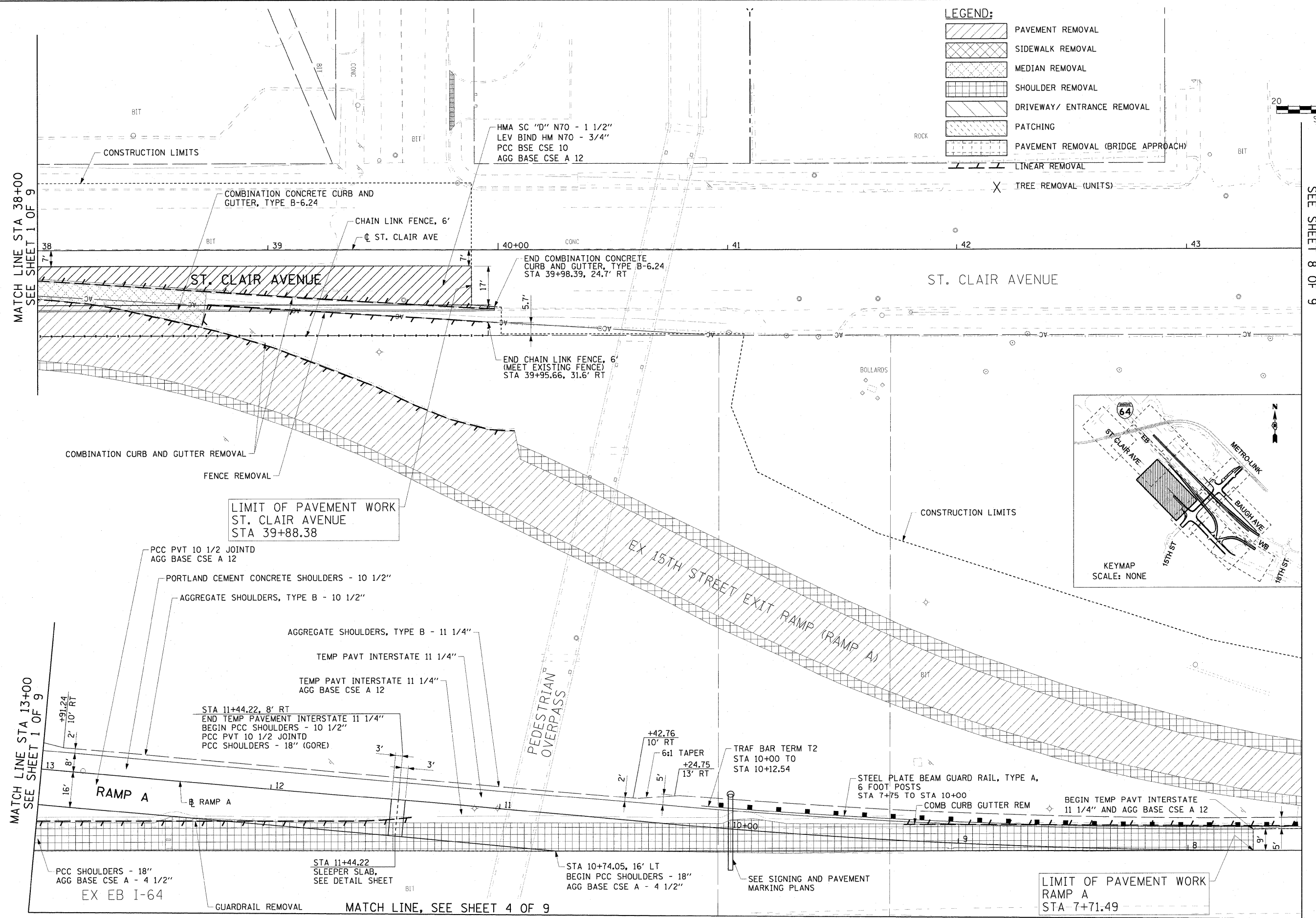

MATCH LINE STA 38+00  
SEE SHEET 1 OF 9

MATCH LINE STA 43+50  
SEE SHEET 8 OF 9

MATCH LINE STA 13+00  
SEE SHEET 1 OF 9

MATCH LINE, SEE SHEET 4 OF 9

LIMIT OF PAVEMENT WORK  
RAMP A  
STA 7+71.49

FILE NAME = #FILEA#	USER NAME = pmsa/ma	DESIGNED OP	REVISED -	<b>STATE OF ILLINOIS DEPARTMENT OF TRANSPORTATION</b>	<b>ROADWAY PLAN - ST. CLAIR AVENUE</b>	F.A.I. RTE.	SECTION	COUNTY	TOTAL SHEETS	SHEET NO.
	PLOT SCALE = 20,000' / IN.	CHECKED DBM	REVISED -			64	82-1-2HB	ST. CLAIR	345	52
PLOT DATE = 3/19/2010	DATE 03/19/10	REVISED -		SCALE: 1" = 20'		SHEET NO. 7 OF 9 SHEETS		STA. 7+71.49 TO STA. 13+00		CONTRACT NO. 76C49
						FED. ROAD DIST. NO. ILLINOIS FED. AID PROJECT				