

STAGE 4 TRAFFIC CONTROL ITEMS

IMPACT ATTENUATORS, RELOCATE	RELOCATE TEMPORARY CONCRETE BARRIER	4" MARKING	24" MARKING (STOP BAR)	WORK ZONE PAVEMENT MARKING REMOVAL	TEMPORARY INFORMATION SIGNING
EACH	FOOT	FOOT	FOOT	SQ FT	SQ FT
1	246	2151	50	430	80

PAVEMENT MARKING LAYOUT- STAGE 4

	ROADWAY	STATION	OFFSET
144	15TH STREET	3+00.00	9.38' LT
145	15TH STREET	3+21.96	9.38' LT
146	15TH STREET	4+37.49	25.96' LT
148	15TH STREET	3+02.20	24.28' RT
149	15TH STREET	4+66.18	24.28' RT
151	15TH STREET	9+77.44	7.00' LT
152	15TH STREET	10+79.29	7.00' LT
153	BAUGH AVE	110+08.97	2.00' RT
154	15TH STREET	9+82.28	4.00' RT
155	15TH STREET	12+21.02	17.30' RT
156	15TH STREET	12+82.05	8.93' RT

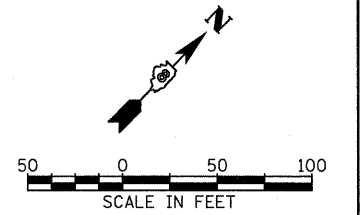
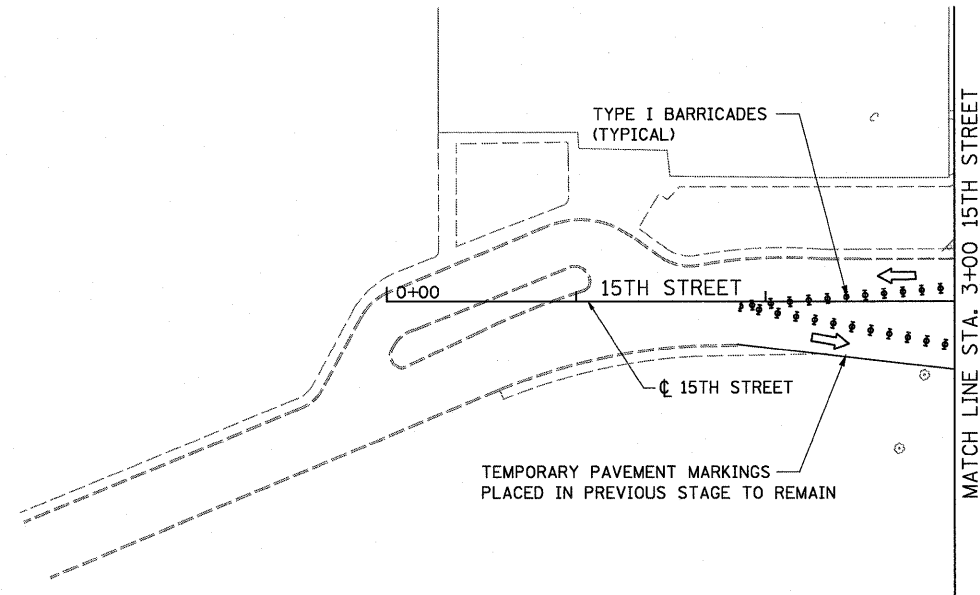

- NOTES:
 1. PLACE "NO TRUCKS" SIGN (R12-3) FOR NORTHBOUND TRAFFIC AT INTERSECTION OF 15TH STREET AND SUMMIT AVENUE.

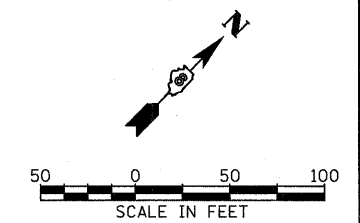
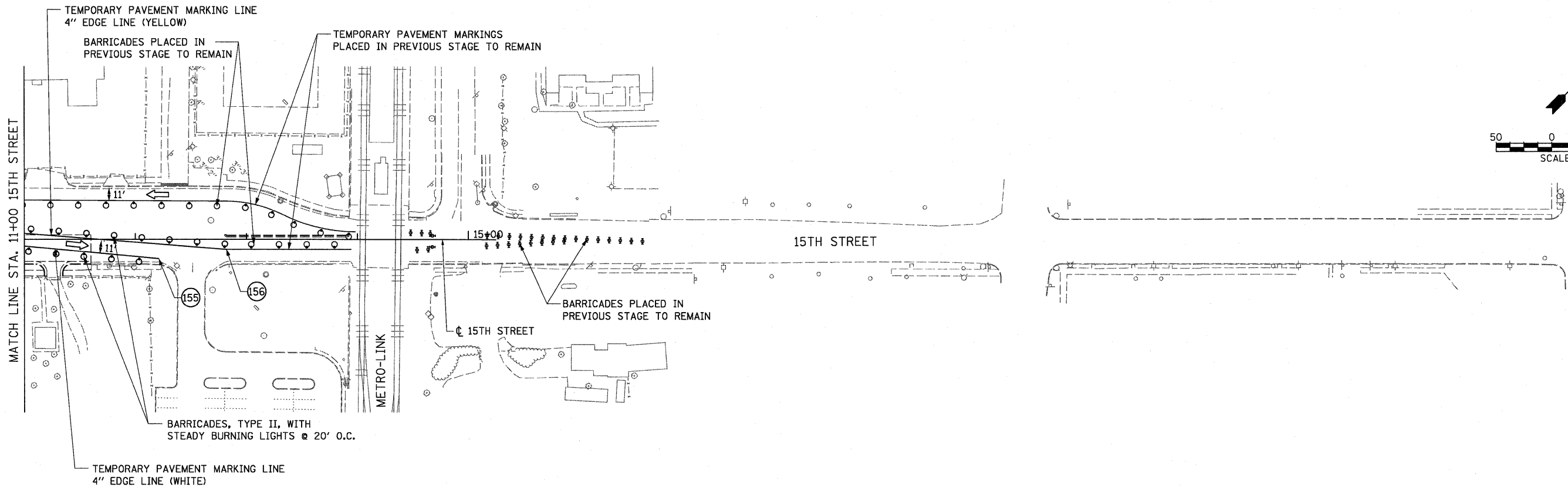

FILE NAME =	USER NAME = IDOT	DESIGNED - TTB	REVISED -
#FILE#		DRAWN - TTB	REVISED -
	PLOT SCALE = 50.0000' / IN.	CHECKED - JAH	REVISED -
	PLOT DATE = 3/17/2010	DATE - 3/19/2010	REVISED -

**STATE OF ILLINOIS
DEPARTMENT OF TRANSPORTATION**

SUGGESTED STAGES OF CONSTRUCTION AND TRAFFIC CONTROL - STAGE 4

SCALE: 1" = 50' SHEET NO. 4 OF 4 SHEETS STA. XX+XX TO STA. XX+XX

F.A.I. RTE.	SECTION	COUNTY	TOTAL SHEETS	SHEET NO.
64	82-1-2HB	ST. CLAIR	345	91
FED. ROAD DIST. NO. ILLINOIS FED. AID PROJECT			CONTRACT NO. 76C49	