

JOINT	15TH STREET TRANSVERSE STATION/SPACING
A	9+34.90
B	9+45.72
C	9+56.53
D	10+10.58
E	10+12.72
F	10+24.05
G	10+37.52
H	10+50.99

JOINT	BAUGH AVENUE N TRANSVERSE STATION/SPACING
I	5+26.42
J	5+28.00
K	5+40.98
L	5+42.04
M	5+55.51
N	5+68.98
O	5+83.98
P	5+98.98
Q	6+11.73
R	6+24.49
S	6+37.24

JOINT	BAUGH AVENUE S15 TRANSVERSE STATION/SPACING
T	110+19.96
U	110+33.31
V	110+46.86
W	110+61.48
X	110+76.10
Y	110+90.72
Z	111+05.38

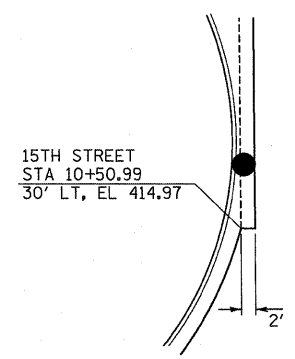
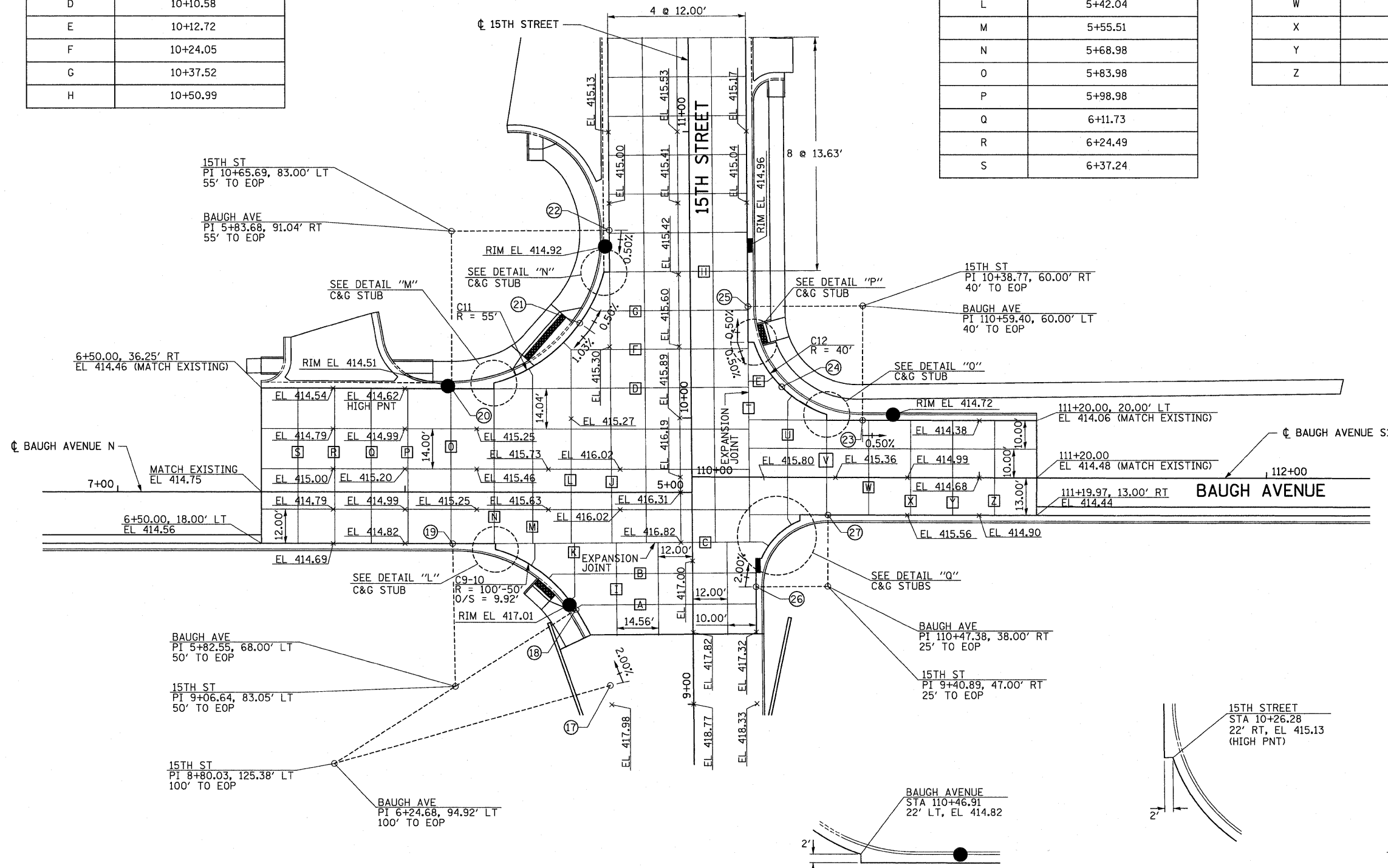
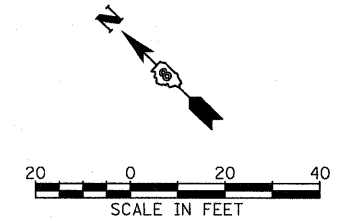

DETAIL "N"

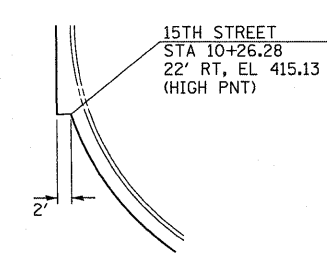

DETAIL "P"

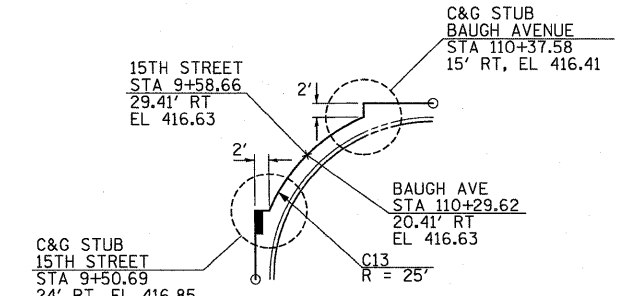

DETAIL "Q"

- NOTES:
- SEE SHEET 4 OF 4 FOR CURVE POINT LAYOUT AND C & G DETAILS.
 - JOINT DETAILS ARE IN ACCORDANCE WITH STANDARDS 420001, 420206, AND 420306 UNLESS OTHERWISE NOTED.