

STATE OF ILLINOIS
DEPARTMENT OF TRANSPORTATION
DIVISION OF HIGHWAYS

**PROPOSED
HIGHWAY PLANS**

**ROUTE FAI 55/70 (I-55/70)
SECTION 60-81-2
MARYVILLE WEIGH STATION
PATCHING AND RESURFACING
MADISON COUNTY**

C-98-033-10

F.A.I. RTE.	SECTION	COUNTY	TOTAL SHEETS	SHEET NO.
55/70	60-81-2	MADISON	16	1
		ILLINOIS	CONTRACT NO. 76D55	

INDEX OF SHEETS

1. COVER SHEET
2. GENERAL NOTES, STANDARDS, & COMMITMENTS
3. SUMMARY OF QUANTITIES
- 4.-5. SCHEDULE
- 6.-8. TYPICAL DETAILS
- 9.-11. PLAN VIEW
12. PAVEMENT MARKING
13. PROPOSED PARKING LOT DETAIL
14. PROPOSED SIDEWALK DETAIL
15. PROPOSED DUMPSTER PLATFORM DETAIL
16. BUTT JOINT DETAIL

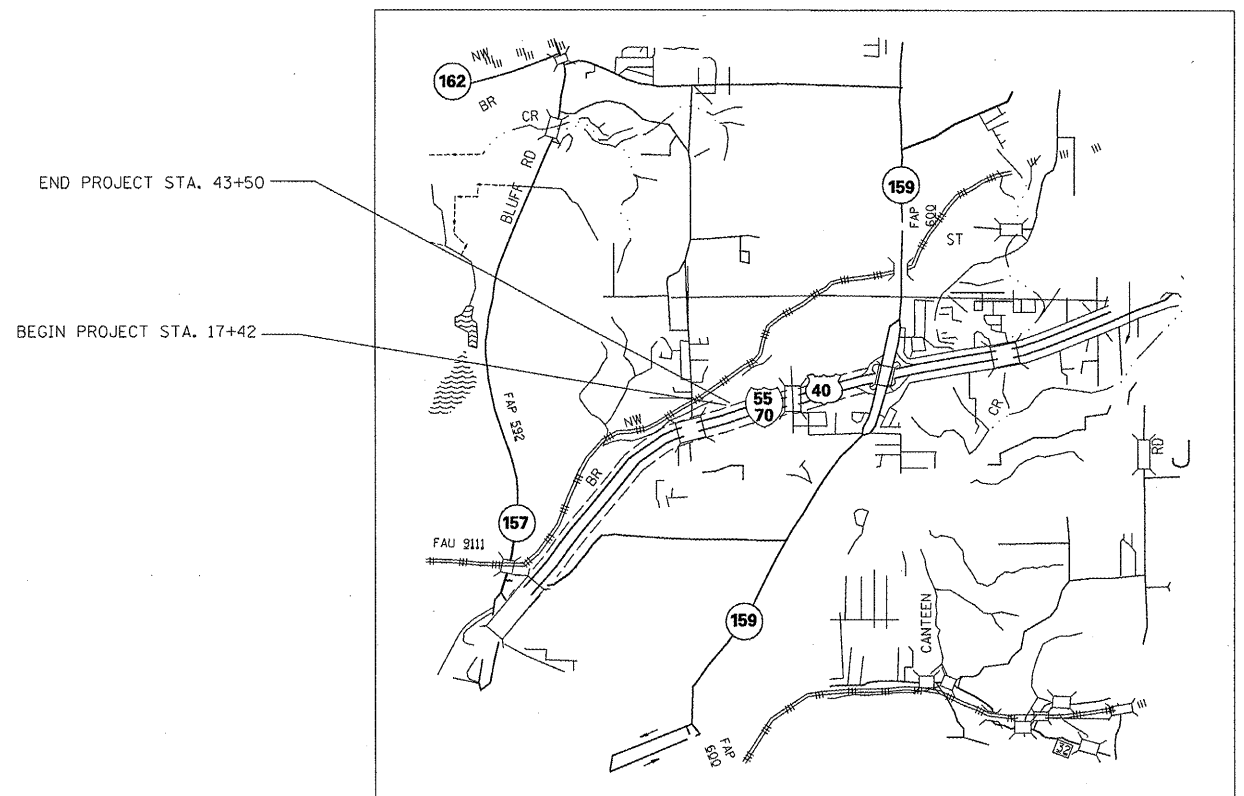

NOT TO SCALE

GROSS LENGTH = 3253' = 0.62 MILES
NET LENGTH = 2568' = 0.49 MILES

SCALES

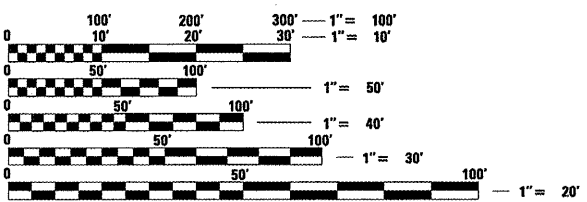

FULL SIZE PLANS HAVE BEEN PREPARED USING STANDARD ENGINEERING SCALES. REDUCED SIZED PLANS WILL NOT CONFORM TO STANDARD SCALES. IN MAKING MEASUREMENTS ON REDUCED PLANS, THE ABOVE SCALES MAY BE USED.

J.U.L.I.E.
JOINT UTILITY LOCATION INFORMATION FOR EXCAVATION
1-800-892-0123
OR 811

PROJECT ENGINEER: TIM PADGETT 618-346-3325
PROJECT MANAGER: LUKE WATERS 618-346-3194

CONTRACT NO. 76D55

STATE OF ILLINOIS
DEPARTMENT OF TRANSPORTATION
DIVISION OF HIGHWAYS

SUBMITTED *March 25* 20 *10*

Mary C Jamie
DEPUTY DIRECTOR OF HIGHWAYS, REGION ENGINEER

May 7 20 *10*
Scott E. Stitt, P.E., I&E
acting ENGINEER OF DESIGN AND ENVIRONMENT

May 7 20 *10*
Christine M. Reed, I&E
DIRECTOR OF HIGHWAYS, CHIEF ENGINEER

**PRINTED BY THE AUTHORITY
OF THE STATE OF ILLINOIS**

GENERAL NOTES

- ① WHERE ANY PARTIAL DEPTH PATCH ENCOUNTERS A DETECTOR LOOP, THAT PORTION OF THE PATCH SHALL BE OMITTED
- ② THE CONTRACTOR SHALL VERIFY ALL DIMENSIONS AND CONDITIONS IN THE FIELD PRIOR TO CONSTRUCTION AND ORDERING OF MATERIALS.
- ③ ILLINOIS STATE LAW REQUIRES A 48-HOUR NOTICE TO BE GIVEN TO UTILITIES BEFORE DIGGING. FIELD MARKING OF FACILITIES MAY BE OBTAINED BY CONTACTING J.U.L.I.E. OR FOR NON-MEMBERS, THE UTILITY COMPANY DIRECTLY. AGENCIES KNOWN TO HAVE FACILITIES WITHIN THE PROJECT AREA ARE AS FOLLOWS:

UTILITY	ABOVE GROUND	BELOW GROUND
* AMEREN IP		X
* AT&T ILLINOIS		X
* CHARTER COMMUNICATIONS, INC.		X
* CITY OF COLLINSVILLE		X
* VILLAGE OF MARYVILLE		X
* SOUTHWESTERN ELECTRIC COOPERATIVE, INC.	X	
* CITY OF TROY		X

MEMBERS OF J.U.L.I.E. (800)-892-0123 ARE INDICATED BY *. NON J.U.L.I.E. MEMBERS MUST BE NOTIFIED INDIVIDUALLY.

- ④ THE FOLLOWING MIXTURE REQUIREMENTS ARE APPLICABLE FOR THIS PROJECT:

DESCRIPTION	MARYVILLE WEIGH STATION LOOP AROUND
-------------	-------------------------------------

MIXTURE USE	POLY SURFACE	PARTIAL DEPTH PATCH
AC/PG	SBS PG 76-22	PG 64-22
RAP % (MAX)	10%	10%
DESIGN AIR VOIDS	4.0% @ Ndes=90	4.0% @ Ndes=90
MIX COMPOSITION (GRADATION MIXTURE)		IL 12.5
FRICITION AGG	MIXTURE "D"	MIXTURE "D"

MIXTURE USE	SHOULDERS	TOP LIFT SHOULDERS
AC/PG	PG 64-22	PG 64-22
RAP % (MAX)	30%	30%
DESIGN AIR VOIDS	2.0% @ Ndes=30	2.0% @ Ndes=30
MIX COMPOSITION (GRADATION MIXTURE)		
FRICITION AGG	BAM	BAM

**** Top Lift Shoulders - Design this mix at 2.0% voids and add asphalt to reduce voids to 1.5%.
Plan quantities for Bituminous Concrete Surface Course items are calculated using a unit weight of 112 lb/sq yd/in (59.8 kg/sq m/25 mm thickness).
See special provision RECLAIMED ASPHALT PAVEMENT (RAP) (BOE) for RAP %**

- ⑤ THE THICKNESS OF THE BITUMINOUS MIXTURE SHOWN ON THE PLANS IS THE NOMINAL THICKNESS. DEVIATIONS FROM THE NOMINAL THICKNESS WILL BE PERMITTED WHEN SUCH DEVIATIONS OCCUR DUE TO IRREGULARITIES IN THE EXISTING SURFACE OR BASE ON WHICH THE BITUMINOUS MIXTURE IS PLACED.
- ⑥ ALL AREAS DISTURBED FOR ANY REASON SHALL BE PERMANENTLY SEEDED AS DIRECTED BY THE ENGINEER. ALL AREAS DISTURBED BY THE CONTRACTOR OUTSIDE THE PROPOSED CONSTRUCTION LIMITS SHALL BE SEEDED AT THE CONTRACTOR'S EXPENSE.
- ⑦ SIGN BASE ON PARAPET WALL TO BE REUSED. ALL WORK REQUIRED FOR REMOVAL AND RELOCATION TO BE INCLUDED IN PAY ITEMS PROVIDED. NO ADDITIONAL COMPENSATION SHALL BE ALLOWED.
- ⑧ UPON CLOSURE OF THE WEIGH STATION, THE ENGINEER SHALL CONTACT MASTER SEARGENT PAT JACKSON OF THE ILLINOIS STATE POLICE AT 618-346-3615 AND INFORM HER OF THE CLOSURE DATES.

STANDARDS

000001-05
001006
442101-07
701451-01
701901-01
720001-01
720006-02
720011-01
728001-01
729001-01

COMMITMENTS

NONE

FILE NAME =	USER NAME = watersle	DESIGNED -	REVISED -	STATE OF ILLINOIS DEPARTMENT OF TRANSPORTATION	GENERAL NOTES, STANDARDS, & COMMITMENTS	F.A.I. RTE.	SECTION	COUNTY	TOTAL SHEETS	SHEET NO.
c:\pwork\pwork\WIDOT\WATERSLE\0165625\d876d95-shr-plan.dgn	DRAWN -	REVISED -	55/70			60-81-2	MADISON	16	2	
PLOT SCALE = 1/8" = 1' / IN.	CHECKED -	REVISED -	CONTRACT NO. 76D55							
PLOT DATE = 3/18/2018	DATE -	REVISED -	FED. ROAD DIST. NO. 8 ILLINOIS FED. AID PROJECT							
SCALE: _____ SHEET NO. 1 OF 1 SHEETS STA. _____ TO STA. _____										

SUMMARY OF QUANTITIES

SUMMARY OF QUANTITIES			TOTAL QUANTITIES	CONSTRUCTION TYPE CODE			SUMMARY OF QUANTITIES			TOTAL QUANTITIES	CONSTRUCTION TYPE CODE		
CODE NO	ITEM	UNIT		1000 100% STATE			CODE NO	ITEM	UNIT				
35101500	AGGREGATE BASE COURSE, TYPE B	CU YD	14	14									
40600985	PORTLAND CEMENT CONCRETE SURFACE REMOVAL - BUTT JOINT	SQ YD	268	268									
40603545	POLYMERIZED HOT-MIX ASPHALT SURFACE COURSE, MIX "D", N90	TON	283	283									
42400100	PORTLAND CEMENT CONCRETE SIDEWALK 4 INCH	SQ FT	168	168									
44000153	HOT-MIX ASPHALT SURFACE REMOVAL, 1"	SQ YD	14	14									
44000600	SIDEWALK REMOVAL	SQ FT	120	120									
44200970	CLASS B PATCHES, TYPE II, 10 INCH	SQ YD	11	11									
44213200	SAW CUTS	FOOT	44	44									
48102100	AGGREGATE WEDGE SHOULDER, TYPE B	TON	102	102									
48203100	HOT-MIX ASPHALT SHOULDERS	TON	248	248									
67100100	MOBILIZATION	L SUM	1	1									
70100820	TRAFFIC CONTROL AND PROTECTION, STANDARD 701451	L SUM	1	1									
*72400100	REMOVE SIGN PANEL ASSEMBLY - TYPE A	EACH	2	2									
*72400310	REMOVE SIGN PANEL - TYPE 1	SQ FT	11.25	11.25									
*72400500	RELOCATE SIGN PANEL ASSEMBLY - TYPE A	EACH	2	2									
*72400710	RELOCATE SIGN PANEL - TYPE 1	SQ FT	11.25	11.25									
*78000100	THERMOPLASTIC PAVEMENT MARKING - LETTERS AND SYMBOLS	SQ FT	4.6	4.6									
*78000200	THERMOPLASTIC PAVEMENT MARKING - LINE 4"	FOOT	1675	1675									
X0325847	IMPACT ATTENUATORS (FULLY REDIRECTIVE, RESETTABLE), TEST LEVEL 3	EACH	1	1									
X4421000	PARTIAL DEPTH PATCHING	TON	75	75									
X4422025	PARTIAL DEPTH REMOVAL 2"	SQ YD	672	672									
X7040650	REMOVE TEMPORARY CONCRETE BARRIER	FOOT	60	60									
Z0017202	DOWEL BARS 1 1/2"	EACH	28	28									
Z0029999	IMPACT ATTENUATOR REMOVAL	EACH	1	1									

**Specialty Items*

PARTIAL DEPTH PATCHING SCHEDULE LOOP RAMP AND RETENTION PARKING AREA					
PATCH #	FEET FROM BEGINNING POINT	WIDTH	LENGTH	SY	TON
1	28	2	20	4.44	0.50
2	57	2	4	0.89	0.10
3	71	2	20	4.44	0.50
4	109	2	16	3.56	0.40
5 *	28 - 117	2	136	30.22	3.38
6 *	109 - 164	2	55	12.22	1.37
7	164	2	16	3.56	0.40
8	220	2	22	4.89	0.55
9	252	2	30	6.67	0.75
10	290	2	4	0.89	0.10
11	303	2	15	3.33	0.37
12 *	319 - 387	2	68	15.11	1.69
13 *	414 - 423	2	9	2.00	0.22
14	441	2	18	4.00	0.45
15 *	466 - 631	2	165	36.67	4.11
16	504	2	6	1.33	0.15
17	561	2	24	5.33	0.60
18	590	2	2	0.44	0.05
19	606	2	24	5.33	0.60
20	610	2	10	2.22	0.25
21	631	2	12	2.67	0.30
SUBTOTAL				150.21	16.84

PARTIAL DEPTH PATCHING SCHEDULE MAINLINE					
PATCH #	STATION	WIDTH	LENGTH	SY	TON
22	42+01	4	16	7.11	0.80
23	41+50	4	8	3.56	0.40
24	41+00	4	8	3.56	0.40
25	40+50	2	16	3.56	0.40
26	39+99	2	16	3.56	0.40
27	38+99	2	16	3.56	0.40
28	38+48	2	16	3.56	0.40
29	37+98	2	16	3.56	0.40
30	37+48	2	16	3.56	0.40
31	36+97	2	20	4.44	0.50
32 *	36+97-34+96	2	201	44.67	5.00
33 *	36+91-36+73	2	18	4.00	0.45
34	36+76	6	6	4.00	0.45
35	36+47	2	6	1.33	0.15
36	36+29	2	6	1.33	0.15
37	36+23	2	24	5.33	0.60
38	36+18	2	20	4.44	0.50
39	35+97	2	20	4.44	0.50
40	35+69	2	16	3.56	0.40
41	35+46	2	16	3.56	0.40
42	34+96	2	16	3.56	0.40
43 *	34+96-34+46	2	50	11.11	1.24
44 *	34+66-33+03	2	163	36.22	4.06
45	34+46	2	16	3.56	0.40
46	33+96	2	24	5.33	0.60
47 *	33+81-32+96	2	85	18.89	2.12
48	33+46	2	27	6.00	0.67
49	33+26	2	6	1.33	0.15
50	32+96 LT	2	12	2.67	0.30
51	32+61 LT	2	8	1.78	0.20
52	32+46 LT	2	12	2.67	0.30
53	31+96 LT	2	8	1.78	0.20
54	31+45 LT	2	12	2.67	0.30
55	31+45 RT	2	8	1.78	0.20
56	30+95 LT	2	12	2.67	0.30
57	30+78 LT	2	12	2.67	0.30
SUB TOTAL				221.38	24.84

PARTIAL DEPTH PATCHING SCHEDULE MAINLINE					
PATCH #	STATION	WIDTH	LENGTH	SY	TON
58	30+61 LT	2	6	1.33	0.15
59	30+16 RT	2	8	1.78	0.20
60	29+61 RT	2	16	3.56	0.40
61	29+61 LT	2	20	4.44	0.50
62	29+16 RT	2	12	2.67	0.30
63	29+16 LT	2	8	1.78	0.20
64	28+55 RT	2	16	3.56	0.40
65	28+19 RT	2	16	3.56	0.40
66	27+59 RT	2	16	3.56	0.40
67	27+41 RT	2	16	3.56	0.40
68	26+41 RT	2	16	3.56	0.40
69	26+19 LT	2	8	1.78	0.20
70	25+91 RT	2	16	3.56	0.40
71	25+66	2	16	3.56	0.40
72	25+39	2	30	6.67	0.75
73	25+16	2	20	4.44	0.50
74	25+05	2	14	3.11	0.35
75	24+88	2	14	3.11	0.35
76	24+385	2	16	3.56	0.40
77	24+17	2	20	4.44	0.50
78	23+88	2	12	2.67	0.30
79	23+55	2	12	2.67	0.30
80	23+36	2	12	2.67	0.30
81	23+11	2	16	3.56	0.40
82	22+87	2	12	2.67	0.30
83	22+59	2	16	3.56	0.40
84 *	22+51-22+36	10	16	17.78	1.99
85	22+36	2	4	0.89	0.10
86	21+85	2	24	5.33	0.60
87	21+36	2	15	3.33	0.37
88	20+83	2	22	4.89	0.55
89	20+36	2	21	4.67	0.52
90	19+87	2	19	4.22	0.47
91	18+86	2	12	2.67	0.30
92	18+35	2	16	3.56	0.40
93	17+85	2	16	3.56	0.40
94 *	29+76-29+41	2	35	7.78	0.87
95 *	26+41-19+36	2	705	156.67	17.55
SUB TOTAL				300.74	33.72

PARTIAL DEPTH PATCHING ROUNDED TOTALS	
**SY = 672	TON = 75

NOTE: * DENOTES LONGITUDINAL PATCH
NOTE: ** PARTIAL DEPTH REMOVAL 2.5 INCH QUANTITY

AGGREGATE WEDGE SHOULDER, TYPE B SCHEDULE	
LOCATION	TON
-121' TO 0'	7.83
0' TO 50'	5.06
50' TO 100'	6.32
100' TO 150'	7.56
150' TO 200'	8.54
200' TO 265'	6.73
265' TO 315'	21.95
315' TO 365'	10.78
365' TO 415'	5.47
415' TO 465'	5.46
465' TO 515'	4.61
515' TO 565'	4.16
565' TO 615'	4.19
615' TO 701'	3.36
SUBTOTAL	102.02
ROUNDED TOTAL	102

HMA SHOULDER SCHEDULE	
LOCATION	TON
-121' TO 0'	17.82
0' TO 50'	12.78
50' TO 100'	13.41
100' TO 150'	13.75
150' TO 200'	14.83
200' TO 265'	17.27
265' TO 315'	28.52
315' TO 365'	31.57
365' TO 415'	18.53
415' TO 465'	12.34
465' TO 515'	10.84
515' TO 565'	9.55
565' TO 615'	10.55
615' TO 701'	15.46
NEW PARKING LOT	8.89
EXISTING PARKING LOT	12.20
SUBTOTAL	248.31
ROUNDED TOTAL	248

CLASS B PATCH TYPE II, 10 INCH SCHEDULE					SAW CUTS	DOWEL BARS 1 1/2"
PATCH #	STATION	WIDTH	LENGTH	SY	FOOT	EACH
96	26+93 RT	6	16	11.0	44	28
			TOTAL	11.0	44	28

SIGN SCHEDULE				
SIGN DESCRIPTION AND LOCATION	REMOVE SIGN PANEL ASSEMBLY-TYPE A	REMOVE SIGN PANEL-TYPE 1	RELOCATE SIGN PANEL ASSEMBLY-TYPE A	RELOCATE SIGN PANEL-TYPE 1
	(EACH)	(SQ FT)	(EACH)	(SQ FT)
(NO PARKING EXCEPT FOR AUTHORIZED VEHICLES) 24" X 30"	1	5.0	1	5.0
(R7-3a MODIFIED) LOCATED 240' FROM STARTING POINT	1	6.25	*1	*6.25
(W12-1) 30" X 30" LOCATED AT STA. 33+43				
TOTAL	2	11.25	2	11.25

*NOTE: NEW LOCATION SHALL BE ON BARRIER WALL AT STATION 32+83

SECTION A-A

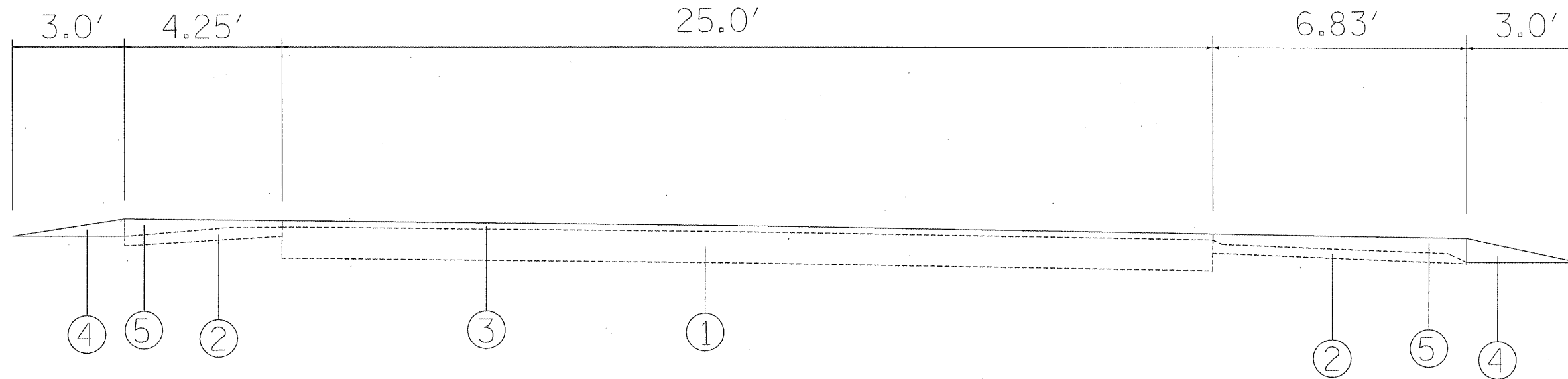

SUPERELEVATION SECTION

100' FROM BEGIN POINT

- ① EXISTING PAVEMENT 10''
- ② EXISTING BITUMINOUS SHOULDER
- ③ PROPOSED POLYMERIZED HMA SURFACE COURSE, MIX "D", N90 - 2''
- ④ PROPOSED AGGREGATE WEDGE SHOULDER
- ⑤ PROPOSED HMA SHOULDER - VAR. DEPTH

FILE NAME =	USER NAME = watersle	DESIGNED - ---	REVISED - ---	STATE OF ILLINOIS DEPARTMENT OF TRANSPORTATION	TYPICAL SECTION	F.A.I. RTE.	SECTION	COUNTY	TOTAL SHEETS	SHEET NO.
ct:\pw\work\PMIDOT\WATERSLE\d0185625\d876d55-shr-pln.dgn	DRAWN - ---	REVISED - ---	55/70			60-81-2	MADISON	16	6	
PLOT SCALE = 1/8" = 1' / IN.	CHECKED - ---	REVISED - ---	CONTRACT NO. 76D55							
PLOT DATE = 3/18/2010	DATE - ---	REVISED - ---	FED. ROAD DIST. NO. 8 ILLINOIS FED. AID PROJECT							
					SCALE: _____	SHEET NO. 1 OF 3 SHEETS		STA. _____ TO STA. _____		

SECTION B-B

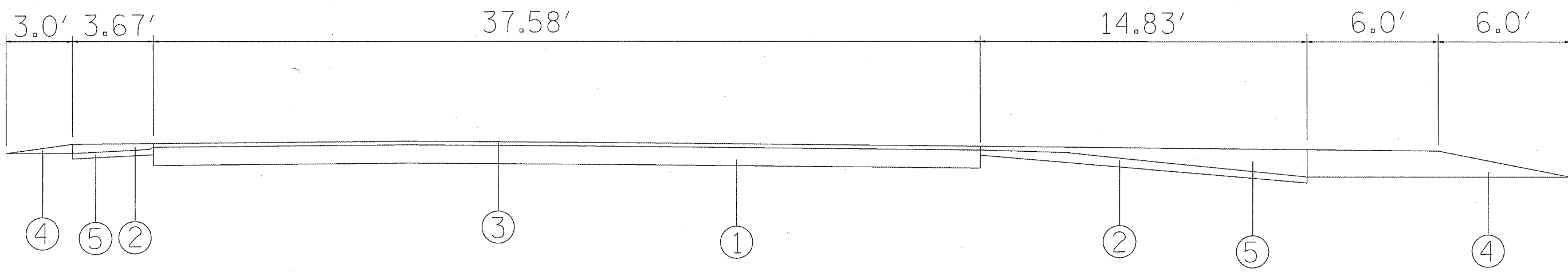

TANGENT SECTION
265' FROM BEGIN POINT

- ① EXISTING PAVEMENT 10"
- ② EXISTING BITUMINOUS SHOULDER
- ③ PROPOSED POLYMERIZED HMA SURFACE COURSE, MIX "D", N90 - 2"
- ④ PROPOSED AGGREGATE WEDGE SHOULDER
- ⑤ PROPOSED HMA SHOULDER - VAR. DEPTH

FILE NAME =	USER NAME = watersle	DESIGNED - ---	REVISED - ---	STATE OF ILLINOIS DEPARTMENT OF TRANSPORTATION	TYPICAL SECTION	F.A.I. RTE.	SECTION	COUNTY	TOTAL SHEETS	SHEET NO.	
cr:\pw\work\PMIDOT\WATERSLE\d0165625\d876d55-ehtr-plan.dgn		DRAWN - ---	REVISED - ---			55/70	60-81-2	MADISON	16	7	
		CHECKED - ---	REVISED - ---			SCALE: _____ SHEET NO. 2 OF 3 SHEETS STA. _____ TO STA. _____		CONTRACT NO. 76D55			
		DATE - -----	REVISED - ---			FED. ROAD DIST. NO. 8 ILLINOIS FED. AID PROJECT					

SECTION C-C

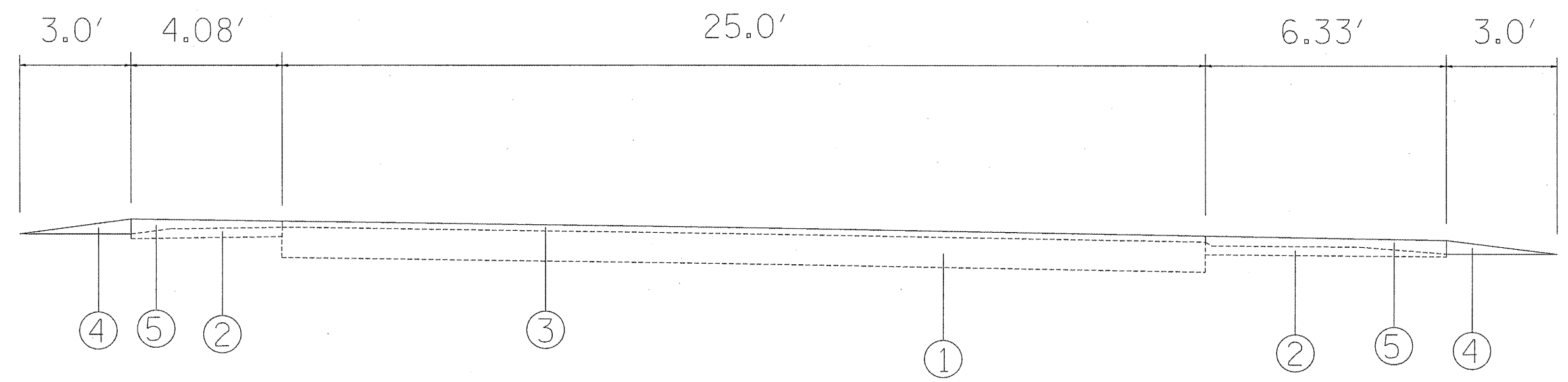

SUPERELEVATION SECTION

565' FROM BEGIN POINT

- ① EXISTING PAVEMENT 10''
- ② EXISTING BITUMINOUS SHOULDER
- ③ PROPOSED POLYMERIZED HMA SURFACE COURSE, MIX "D", N90 - 2''
- ④ PROPOSED AGGREGATE WEDGE SHOULDER
- ⑤ PROPOSED HMA SHOULDER - VAR. DEPTH

FILE NAME =	USER NAME = watersle	DESIGNED -	REVISED -	STATE OF ILLINOIS DEPARTMENT OF TRANSPORTATION	TYPICAL SECTION	F.A.1 RTE.	SECTION	COUNTY	TOTAL SHEETS	SHEET NO.
ac:\pw\work\VPMDOT\WATERSLE\d0165625\d876d55-shr-plen.dgn	DRAWN -	REVISED -	55/70			TYPICAL SECTION	MADISON	16	8	
PLOT SCALE = 1/8" = 1' / IN.	CHECKED -	REVISED -	CONTRACT NO. 76D55							
PLOT DATE = 3/18/2010	DATE -	REVISED -	FED. ROAD DIST. NO. 8 ILLINOIS FED. AID PROJECT							
					SCALE: _____	SHEET NO. 3 OF 3 SHEETS		STA. _____ TO STA. _____		

EXIST. CURVE RAMPBL-5
 PI STA. = 5+46.32
 $\Delta = 1^\circ 00' 02''$ (RT)
 $D = 0^\circ 59' 25''$
 $R = 5,786.57'$
 $T = 50.53'$
 $L = 101.05'$
 $E = 0.22'$
 $e = \text{-----}$
 T.R. = -----
 S.E. RUN = -----
 P.C. STA. = 4+95.79
 P.T. STA. = 5+96.85

EXIST. CURVE RAMPBL-7
 PI STA. = 7+48.33
 $\Delta = 1^\circ 00' 00''$ (RT)
 $D = 0^\circ 59' 15''$
 $R = 5,802.15'$
 $T = 50.64'$
 $L = 101.28'$
 $E = 0.22'$
 $e = \text{-----}$
 T.R. = -----
 S.E. RUN = -----
 P.C. STA. = 6+97.69
 P.T. STA. = 7+98.97

EXIST. CURVE RAMPBL-8
 PI STA. = 8+49.39
 $\Delta = 1^\circ 00' 00''$ (RT)
 $D = 0^\circ 59' 31''$
 $R = 5,776.71'$
 $T = 50.42'$
 $L = 100.83'$
 $E = 0.22'$
 $e = \text{-----}$
 T.R. = -----
 S.E. RUN = -----
 P.C. STA. = 7+98.97
 P.T. STA. = 8+99.80

EXIST. CURVE RAMPBL-9
 PI STA. = 9+49.96
 $\Delta = 0^\circ 59' 21''$ (RT)
 $D = 0^\circ 59' 10''$
 $R = 5,810.42'$
 $T = 50.16'$
 $L = 100.32'$
 $E = 0.22'$
 $e = \text{-----}$
 T.R. = -----
 S.E. RUN = -----
 P.C. STA. = 8+99.80
 P.T. STA. = 10+00.12

EXIST. CURVE RAMPBL-10
 PI STA. = 12+51.25
 $\Delta = 2^\circ 02' 54''$ (RT)
 $D = 0^\circ 24' 28''$
 $R = 14,047.34'$
 $T = 251.13'$
 $L = 502.22'$
 $E = 2.24'$
 $e = \text{-----}$
 T.R. = -----
 S.E. RUN = -----
 P.C. STA. = 10+00.12
 P.T. STA. = 15+02.33

EXIST. CURVE RAMPBL-6
 PI STA. = 6+47.27
 $\Delta = 1^\circ 00' 02''$ (RT)
 $D = 0^\circ 59' 32''$
 $R = 5,775.26'$
 $T = 50.43'$
 $L = 100.85'$
 $E = 0.22'$
 $e = \text{-----}$
 T.R. = -----
 S.E. RUN = -----
 P.C. STA. = 5+96.85
 P.T. STA. = 6+97.69

EXIST. CURVE RAMPBL-11
 PI STA. = 19+24.96
 $\Delta = 4^\circ 45' 20''$ (LT)
 $D = 1^\circ 03' 49''$
 $R = 5,386.68'$
 $T = 223.68'$
 $L = 447.10'$
 $E = 4.64'$
 $e = \text{-----}$
 T.R. = -----
 S.E. RUN = -----
 P.C. STA. = 17+01.28
 P.T. STA. = 21+48.38

EXIST. CURVE I70-1
 PI STA. = 617+82.74
 $\Delta = 16^\circ 50' 00''$ (RT)
 $D = 1^\circ 00' 00''$
 $R = 5,729.58'$
 $T = 847.77'$
 $L = 1,683.32'$
 $E = 62.38'$
 $e = \text{-----}$
 T.R. = -----
 S.E. RUN = -----
 P.C. STA. = 609+34.97
 P.T. STA. = 626+18.29

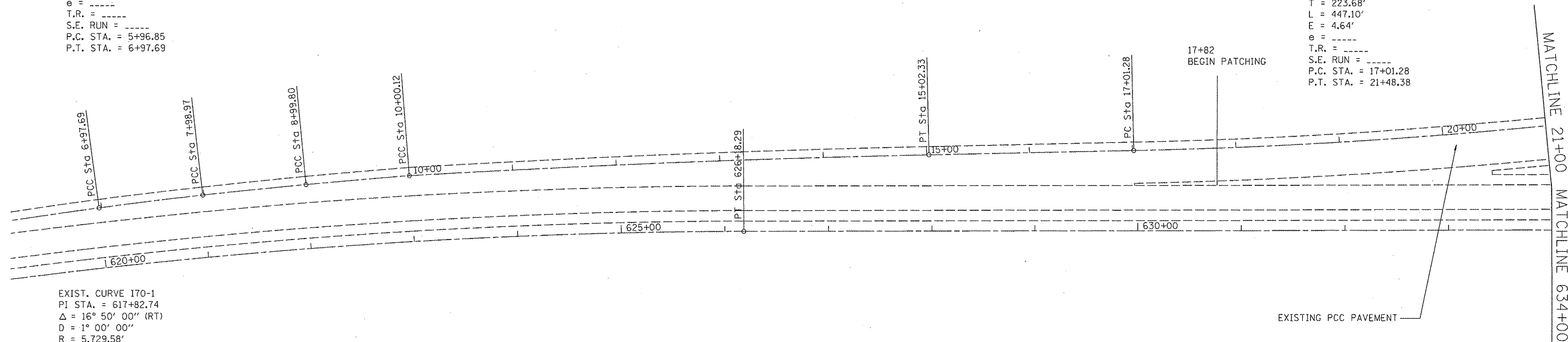

FILE NAME =	USER NAME = watersie	DESIGNED -	REVISED -
c:\pwork\p\WIDOT\WATERSL\165625\d816d55-sh1-plan.dgn		DRAWN -	REVISED -
		CHECKED -	REVISED -
		DATE -	REVISED -

**STATE OF ILLINOIS
 DEPARTMENT OF TRANSPORTATION**

PLAN VIEW

SCALE: _____ SHEET NO. 1 OF 3 SHEETS STA. _____ TO STA. _____

F.A.I. RTE.	SECTION	COUNTY	TOTAL SHEETS	SHEET NO.
55/70	60-81-2	MADISON	16	9
CONTRACT NO. 76D55			FED. ROAD DIST. NO. 8 ILLINOIS FED. AID PROJECT	

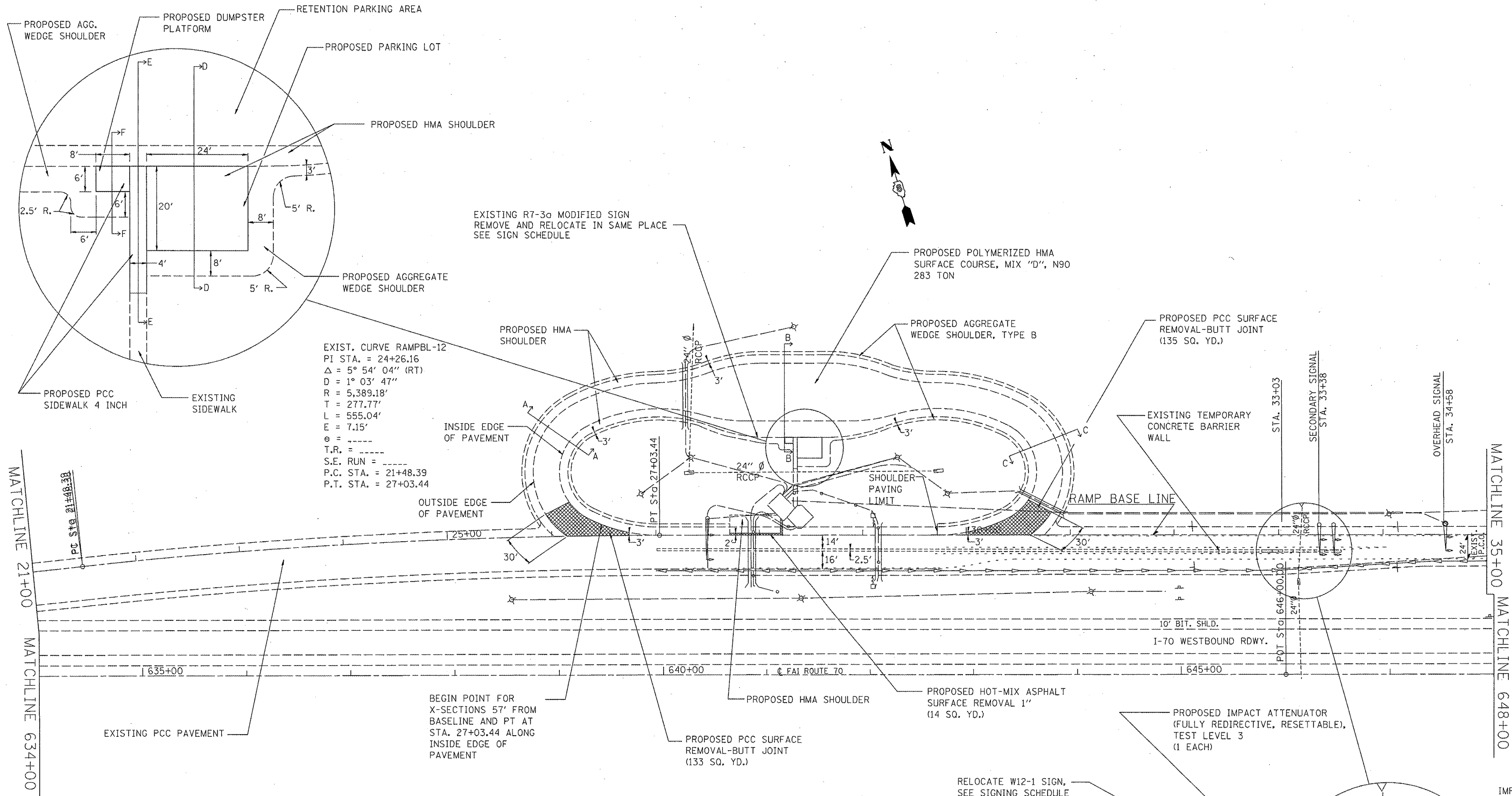

EXIST. CURVE RAMPBL-12
 PI STA. = 24+26.16
 $\Delta = 5^\circ 54' 04''$ (RT)
 $D = 1^\circ 03' 47''$
 $R = 5,389.18'$
 $T = 277.77'$
 $L = 555.04'$
 $E = 7.15'$
 $\theta = \dots$
 $T.R. = \dots$
 $S.E. RUN = \dots$
 $P.C. STA. = 21+48.39$
 $P.T. STA. = 27+03.44$

NOTE: STATIONING IS UNKNOWN ON LOOP RAMP. BEGINNING POINT FOR MEASURING PATCHES IS LOCATED ON PLAN VIEW. PATCHES AND DETAIL SECTIONS ARE LOCATED ACCORDING TO DISTANCE FROM BEGINNING POINT AS THE DISTANCE INCREASES AROUND THE INSIDE EDGE OF PAVEMENT OF THE RAMPS.

FILE NAME =	USER NAME = watersle	DESIGNED -	REVISED -	STATE OF ILLINOIS DEPARTMENT OF TRANSPORTATION	PLAN VIEW	F.A.I. RTE.	SECTION	COUNTY	TOTAL SHEETS	SHEET NO.	
cd:\pwork\WIDOT\WATERSLE\0165625\876d55-sht-plan.dgn	PLOT SCALE = 100.0000' / IN.	DRAWN -	REVISED -			55/70	60-81-2	MADISON	16	10	
	DATE = 3/31/2010	CHECKED -	REVISED -			CONTRACT NO. 76D55					
		DATE -	REVISED -			FED. ROAD DIST. NO. 8 (ILLINOIS) FED. AID PROJECT					

EXIST. CURVE RAMPBL-13
 PI STA. = 38+43.07
 $\Delta = 1^{\circ} 00' 18''$ (RT)
 $D = 5^{\circ} 03' 39''$
 $R = 1,132.13'$
 $T = 9.93'$
 $L = 19.86'$
 $E = 0.04'$
 $e = \text{-----}$
 $T.R. = \text{-----}$
 $S.E. \text{ RUN} = \text{-----}$
 $P.C. \text{ STA.} = 38+33.14$
 $P.T. \text{ STA.} = 38+53.00$

EXIST. CURVE RAMPBL-14
 PI STA. = 39+62.97
 $\Delta = 11^{\circ} 05' 47''$ (RT)
 $D = 5^{\circ} 03' 39''$
 $R = 1,132.13'$
 $T = 109.97'$
 $L = 219.26'$
 $E = 5.33'$
 $e = \text{-----}$
 $T.R. = \text{-----}$
 $S.E. \text{ RUN} = \text{-----}$
 $P.C. \text{ STA.} = 38+53.00$
 $P.T. \text{ STA.} = 40+72.26$

EXIST. CURVE RAMPBL-15
 PI STA. = 41+61.99
 $\Delta = 9^{\circ} 03' 45''$ (LT)
 $D = 5^{\circ} 03' 37''$
 $R = 1,132.24'$
 $T = 89.73'$
 $L = 179.09'$
 $E = 3.55'$
 $e = \text{-----}$
 $T.R. = \text{-----}$
 $S.E. \text{ RUN} = \text{-----}$
 $P.C. \text{ STA.} = 40+72.26$
 $P.T. \text{ STA.} = 42+51.34$

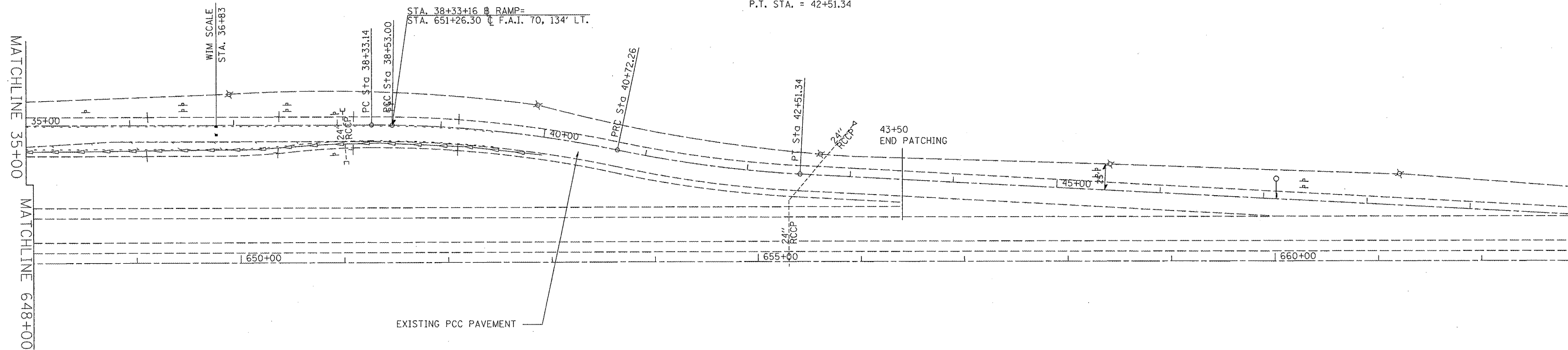

FILE NAME =	USER NAME = wotersle	DESIGNED -	REVISED -
ce:\pw_work\PWIDOT\WATERSLE\d0165625\d876d55-sht-plan.dgn		DRAWN -	REVISED -
	PLOT SCALE = 1/83.1218" / IN.	CHECKED -	REVISED -
	PLOT DATE = 3/18/2010	DATE -	REVISED -

**STATE OF ILLINOIS
 DEPARTMENT OF TRANSPORTATION**

PLAN VIEW

SCALE: _____ SHEET NO. 3 OF 3 SHEETS STA. _____ TO STA. _____

F.A.I. RTE.	SECTION	COUNTY	TOTAL SHEETS	SHEET NO.
55/70	60-81-2	MADISON	16	11
FED. ROAD DIST. NO. 8 ILLINOIS FED. AID PROJECT			CONTRACT NO. 76D55	

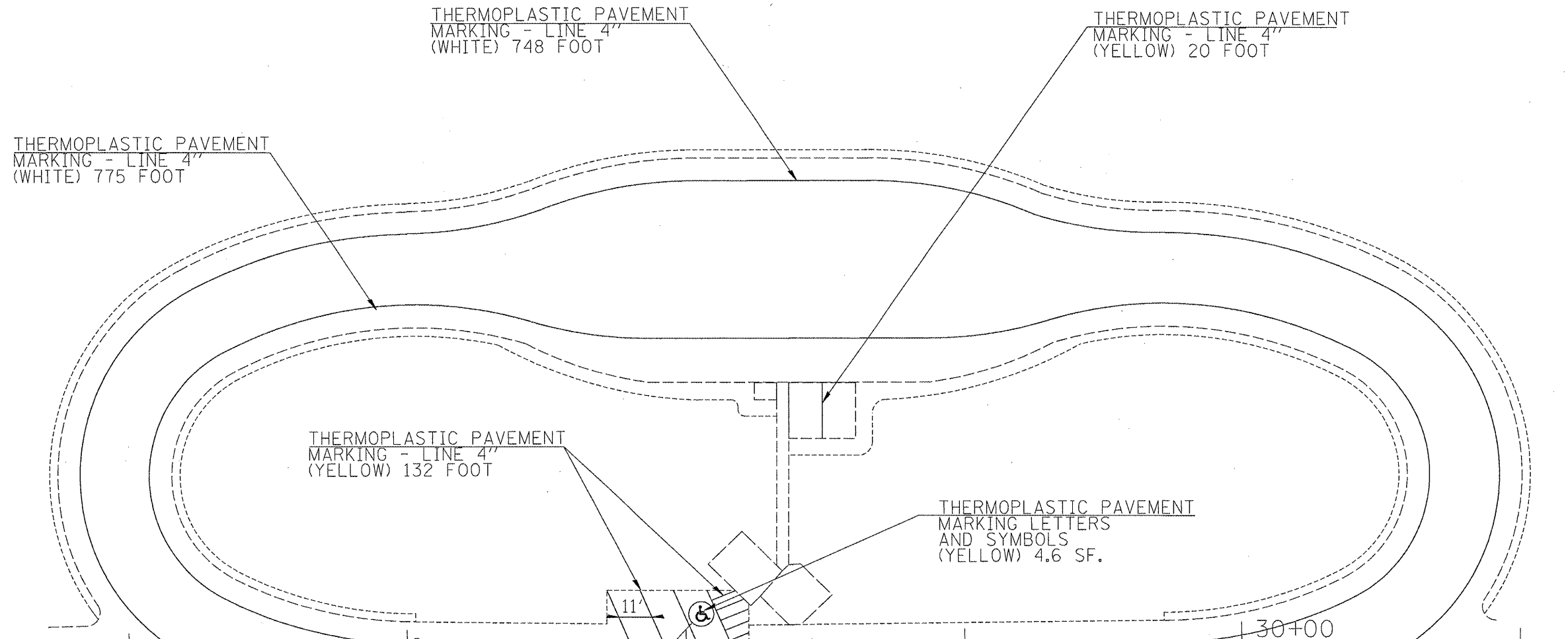

PT Sta 27+03.44

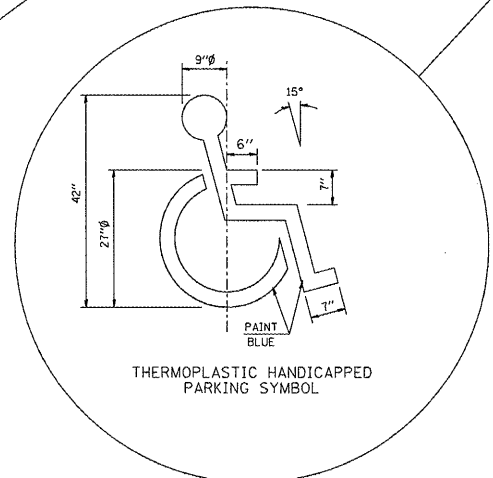

NOTE: MATCH ALL EXISTING PAVEMENT MARKING

FILE NAME =	USER NAME = watersle	DESIGNED -	REVISED -
c:\pwork\k\PM\DOT\WATERSLE\d0165625\d076d55-sht-plan.dgn		DRAWN -	REVISED -
	PLOT SCALE = 1/8" = 1' IN.	CHECKED -	REVISED -
	PLOT DATE = 3/18/2010	DATE -	REVISED -

**STATE OF ILLINOIS
DEPARTMENT OF TRANSPORTATION**

PAVEMENT MARKING	
SCALE: _____	SHEET NO. 1 OF 1 SHEETS
STA. _____ TO STA. _____	

F.A.I. RTE.	SECTION	COUNTY	TOTAL SHEETS	SHEET NO.
55/70	60-81-2	MADISON	16	12
FED. ROAD DIST. NO. 8 ILLINOIS FED. AID PROJECT			CONTRACT NO. 76D55	

SECTION D-D

PROPOSED PARKING LOT DETAIL

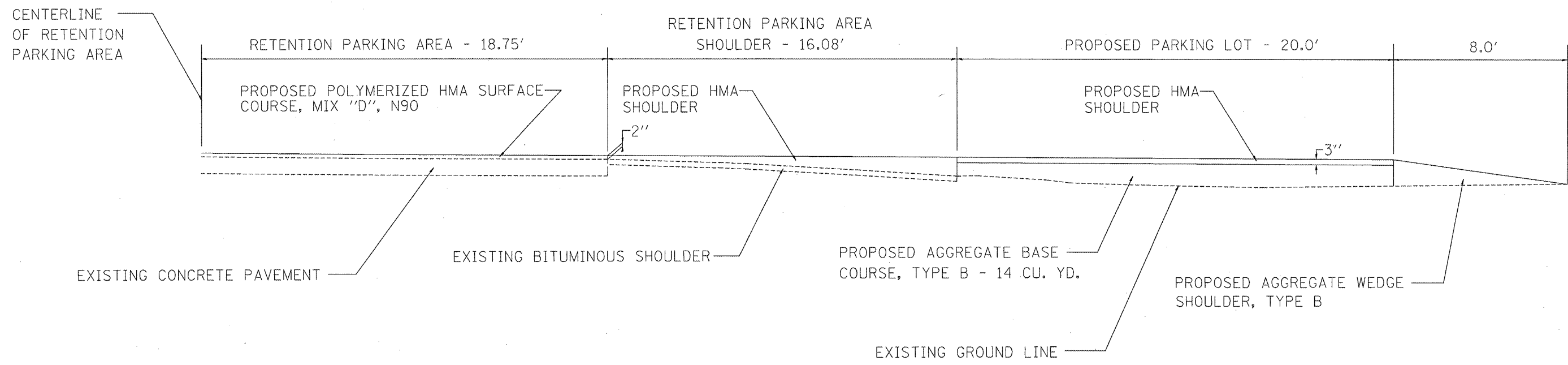

NOTE: PROPOSED HMA SHOULDERS IN THE RETENTION PARKING AREA SHOULDER AND THE PROPOSED PARKING LOT SHOULDER SHALL MATCH THE GRADE OF THE PROPOSED POLYMERIZED HMA SURFACE COURSE, MIX "D", N90

FILE NAME =	USER NAME = waterslo	DESIGNED -	REVISED -	STATE OF ILLINOIS DEPARTMENT OF TRANSPORTATION	PROPOSED PARKING LOT DETAIL	F.A.I. RTE.	SECTION	COUNTY	TOTAL SHEETS	SHEET NO.	
ca:\pwwork\VP\WIDOT\WATERSLE\d0165625\d0165625-11-11-11.dgn	7655-shr-plan.dgn	DRAWN -	REVISED -			55/70	60-81-2	MADISON	16	13	
	PLOT SCALE = 1/8" = 1' / IN.	CHECKED -	REVISED -			CONTRACT NO. 76D55					
	PLOT DATE = 3/18/2010	DATE -	REVISED -			FED. ROAD DIST. NO. 8 ILLINOIS FED. AID PROJECT					

SECTION E-E

PROPOSED SIDEWALK DETAIL

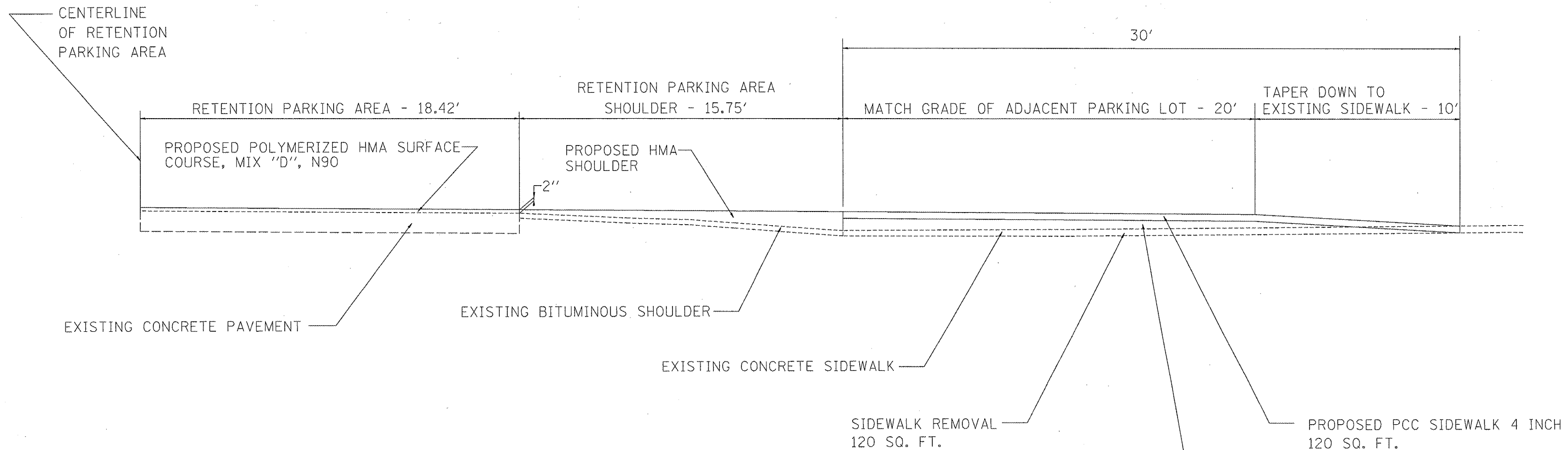

NOTE: PROPOSED HMA SHOULDER IN THE RETENTION PARKING AREA SHOULDER SHALL MATCH THE GRADE OF THE PROPOSED POLYMERIZED HMA SURFACE COURSE, MIX "D", N90

NOTE: COST OF EMBANKMENT SHALL BE INCLUDED IN THE SQUARE FOOT UNIT PRICE FOR PCC SIDEWALK 4 INCH.

FILE NAME =	USER NAME = watersle	DESIGNED -	REVISED -
ca:\pwork\PMIDOT\WATERSLE\d0185625\d876d55-shr-plen.dgn		DRAWN -	REVISED -
		CHECKED -	REVISED -
		DATE -	REVISED -

STATE OF ILLINOIS
DEPARTMENT OF TRANSPORTATION

PROPOSED SIDEWALK DETAIL

SCALE: SHEET NO. 1 OF 1 SHEETS STA. TO STA.

F.A.I. RTE.	SECTION	COUNTY	TOTAL SHEETS	SHEET NO.
55/70	60-81-2	MADISON	16	14
FED. ROAD DIST. NO. 8 ILLINOIS FED. AID PROJECT			CONTRACT NO. 76D55	

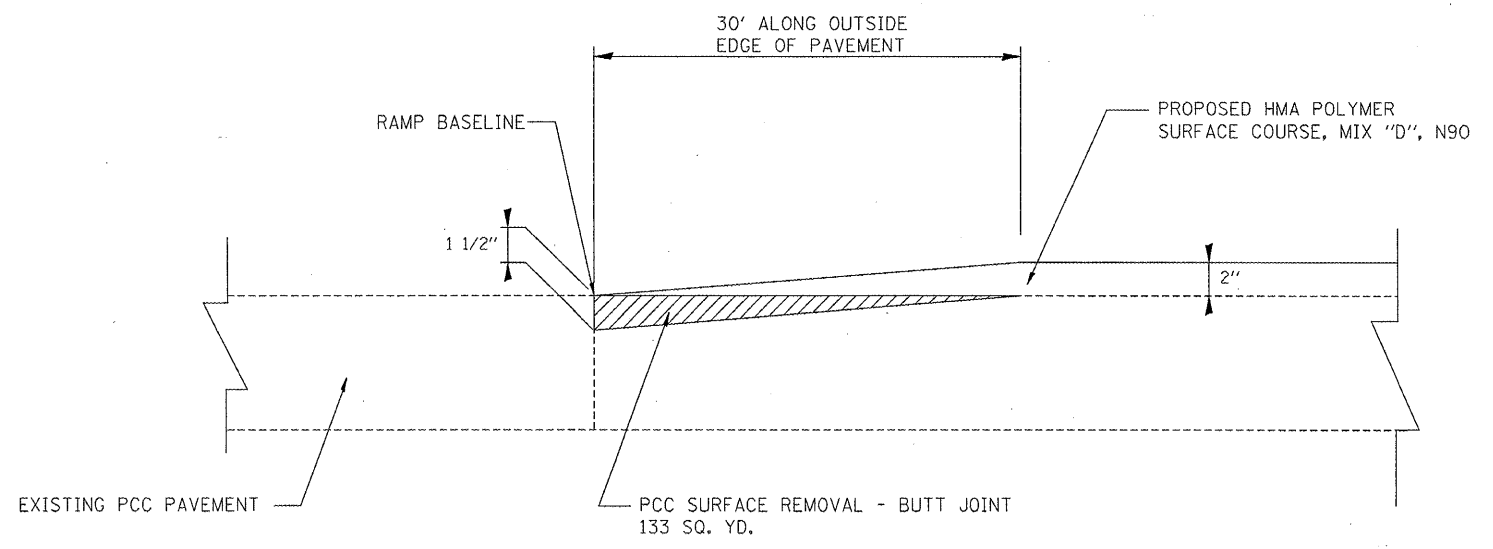

PCC SURFACE REMOVAL - BUTT JOINT
-28' TO 39' FROM BEGINNING

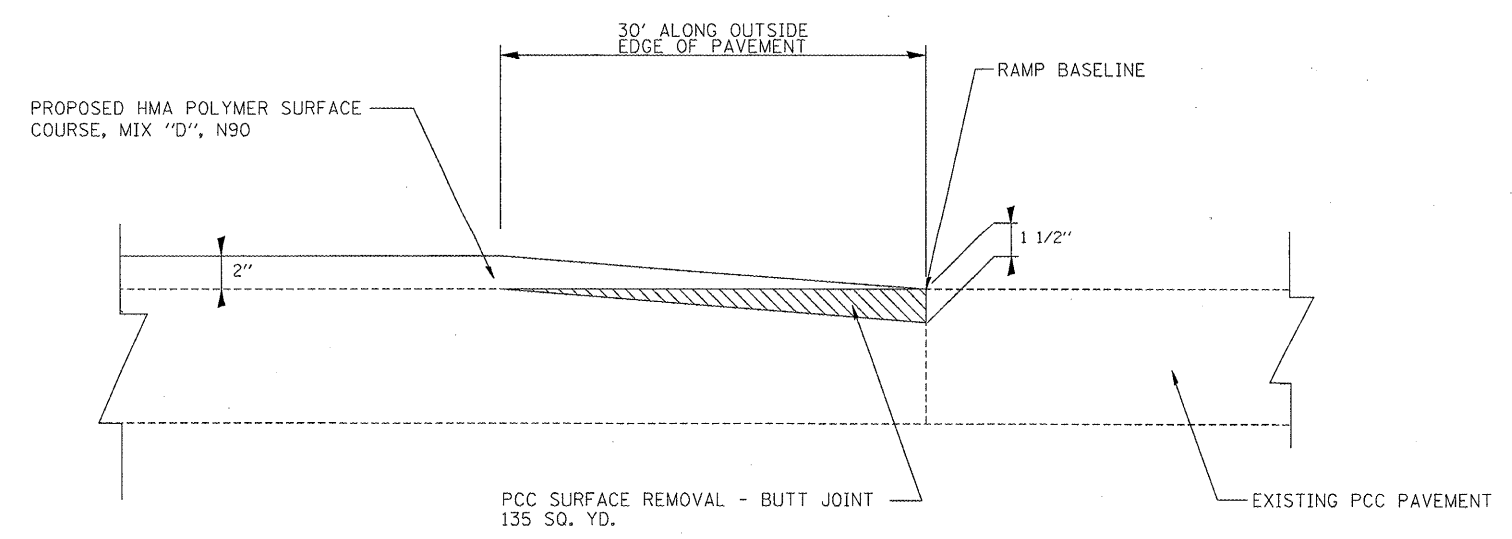

PCC SURFACE REMOVAL - BUTT JOINT
618' TO 685' FROM BEGINNING

FILE NAME =	USER NAME = watersle	DESIGNED -	REVISED -	STATE OF ILLINOIS DEPARTMENT OF TRANSPORTATION	BUTT JOINT DETAIL		F.A.I. RTE.	SECTION	COUNTY	TOTAL SHEETS	SHEET NO.	
cr:\pwork\pwidot\watersle\j0165625\j0165625-16d55-sht-plan.dgn		DRAWN -	REVISED -		SCALE: _____	SHEET NO. 1 OF 1 SHEETS	STA. _____ TO STA. _____	55/70	60-81-2	MADISON	16	16
		CHECKED -	REVISED -								CONTRACT NO. 76D55	
		DATE -	REVISED -								FED. ROAD DIST. NO. 8 ILLINOIS FED. AID PROJECT	