

PROP. CURVE PR-P5LT-1  
 PI STA. = 41270+73.53  
 $\Delta = 3^\circ 00' 23''$  (RT)  
 $D = 7^\circ 01' 18''$   
 $R = 816.00'$   
 $T = 21.41'$   
 $L = 42.82'$   
 $E = 0.28'$   
 $e = 6\%$   
 $T.R. = N/A$   
 $S.E. RUN = N/A$   
 $P.C. STA. = 41270+52.11$   
 $P.T. STA. = 41270+94.93$

PROP. CURVE PR-P5LT-2  
 PI STA. = 41271+77.84  
 $\Delta = 12^\circ 45' 48''$  (RT)  
 $D = 7^\circ 43' 45''$   
 $R = 741.30'$   
 $T = 82.91'$   
 $L = 165.14'$   
 $E = 4.62'$   
 $e = 6\%$   
 $T.R. = N/A$   
 $S.E. RUN = SEE DETAILS$   
 $P.C. STA. = 41270+94.93$   
 $P.T. STA. = 41272+60.07$

PROP. CURVE PR-P5LT-3  
 PI STA. = 41275+29.09  
 $\Delta = 33^\circ 55' 17''$  (LT)  
 $D = 16^\circ 22' 13''$   
 $R = 350.00'$   
 $T = 106.74'$   
 $L = 207.21'$   
 $E = 15.92'$   
 $e = 5.1\%$   
 $T.R. = N/A$   
 $S.E. RUN = SEE DETAILS$   
 $P.C. STA. = 41274+22.35$   
 $P.T. STA. = 41276+29.56$

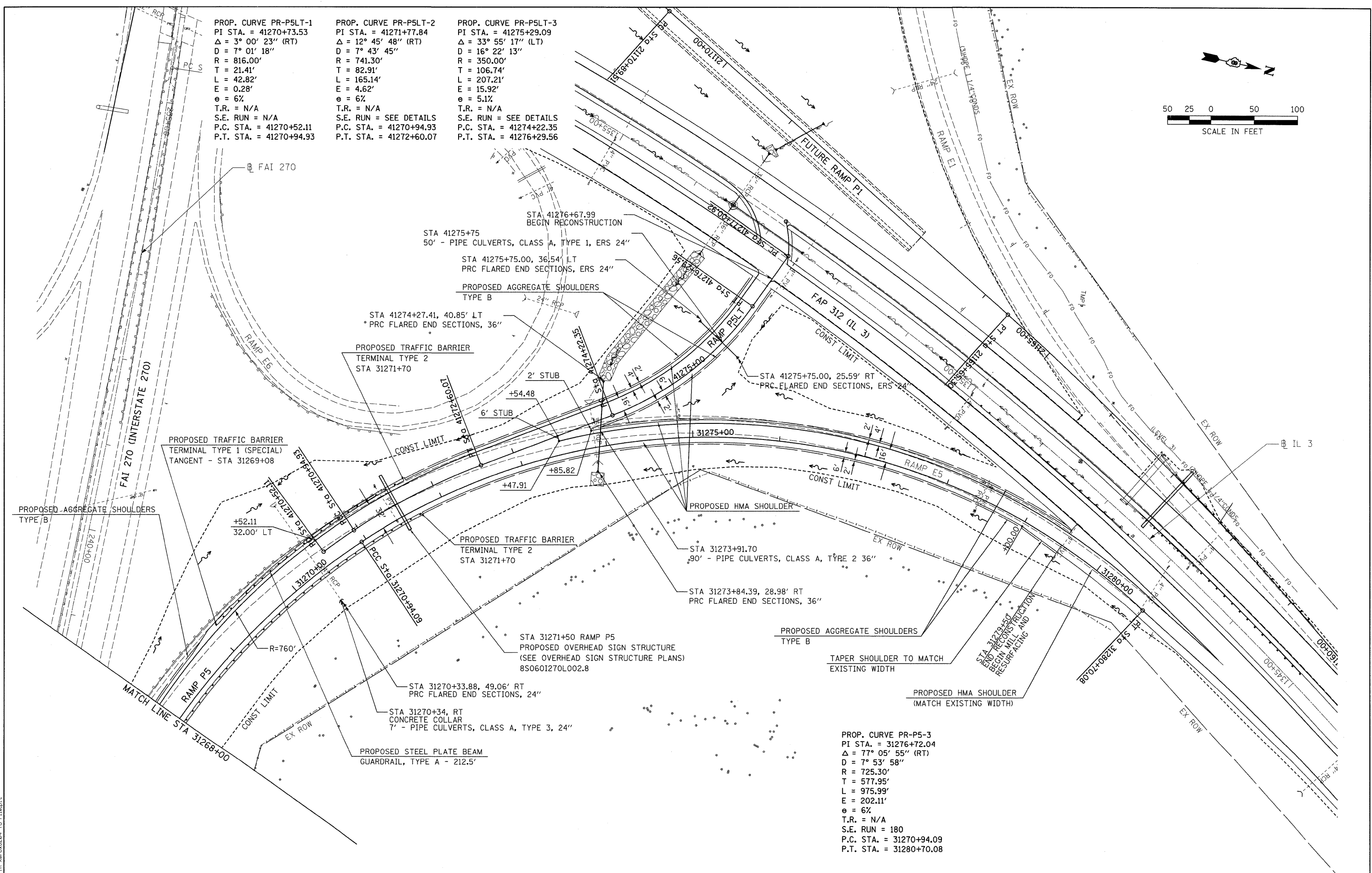
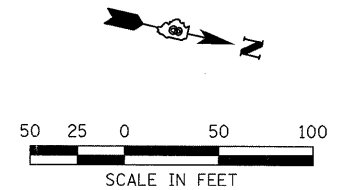

PROP. CURVE PR-P5-3  
 PI STA. = 31276+72.04  
 $\Delta = 77^\circ 05' 55''$  (RT)  
 $D = 7^\circ 53' 58''$   
 $R = 725.30'$   
 $T = 577.95'$   
 $L = 975.99'$   
 $E = 202.11'$   
 $e = 6\%$   
 $T.R. = N/A$   
 $S.E. RUN = 180$   
 $P.C. STA. = 31270+94.09$   
 $P.T. STA. = 31280+70.08$

LAST SAVED = 3/16/2010  
 PEN TABLE = V6.tbl  
 PLOT DRIVER = TR-Xerox6284-TopFile.plt

FILE NAME =	USER NAME = sdonahue	DESIGNED -	REVISED -
\\0906600\0906601\oad\l\plans\023.087	087-Sht-Plan-RampP5-02.dgn	DRAWN -	REVISED -
PLOT SCALE = 50.0023' / IN.		CHECKED -	REVISED -
PLOT DATE = 3/16/2010 4:38:52 PM		DATE -	REVISED -

**STATE OF ILLINOIS**  
**DEPARTMENT OF TRANSPORTATION**



**PLAN**  
 PROPOSED RAMP P5 & P5LT  
 SCALE: 1" = 50'  
 SHEET NO. 14 OF 16 SHEETS  
 STA. 31268+00 TO STA. 31280+70.08

F.A.I. RTE.	SECTION	COUNTY	TOTAL SHEETS	SHEET NO.
270	60-2RS-3	MADISON	231	39
CONTRACT NO. 76D87				
(ILLINOIS) FED. AID PROJECT				