

PLAN	SURVEYED	BY	DATE
	PLOTTED		
	CHECKED		
	RTI OF WAY CHECKED		
	NO.		
	CAO FILE NAME		

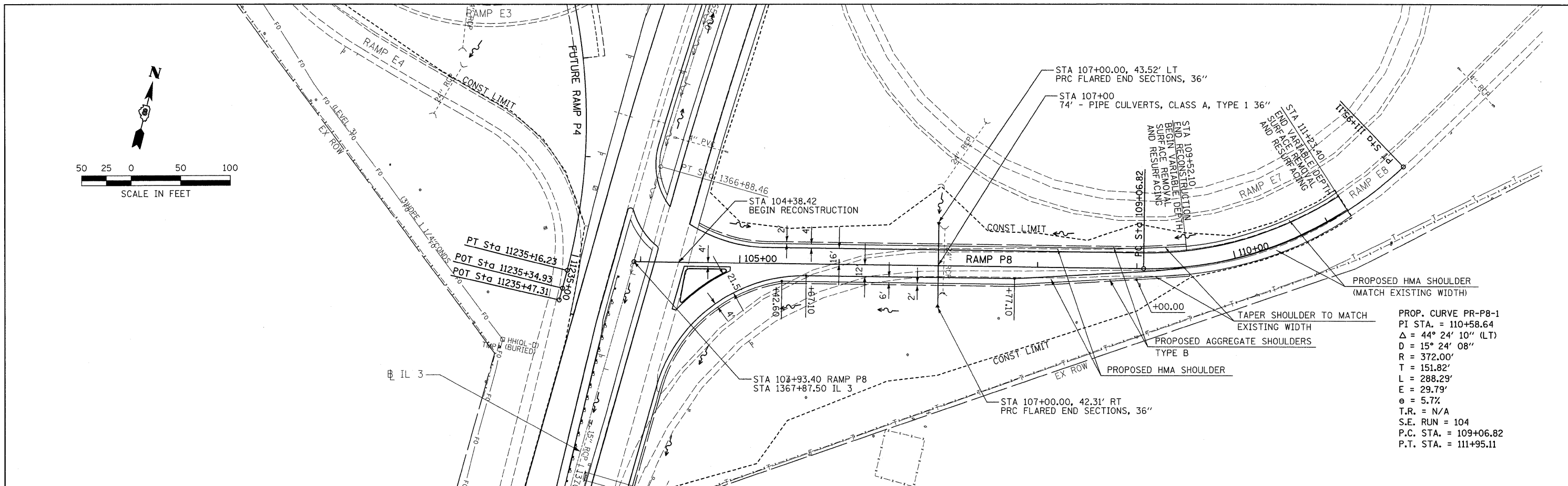

PROP. CURVE PR-P8-1
 PI STA. = 110+58.64
 $\Delta = 44^\circ 24' 10''$ (LT)
 $D = 15^\circ 24' 08''$
 $R = 372.00'$
 $T = 151.82'$
 $L = 288.29'$
 $E = 29.79'$
 $e = 5.7\%$
 $T.R. = N/A$
 $S.E. RUN = 104$
 $P.C. STA. = 109+06.82$
 $P.T. STA. = 111+95.11$

PROFILE	SURVEYED	BY	DATE
	PLOTTED		
	CHECKED		
	STRUCTURE NOTATIONS CHRG		
	NO.		

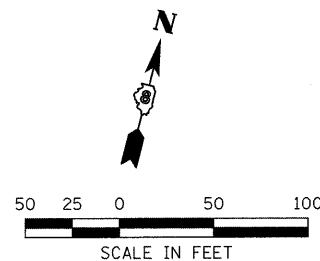
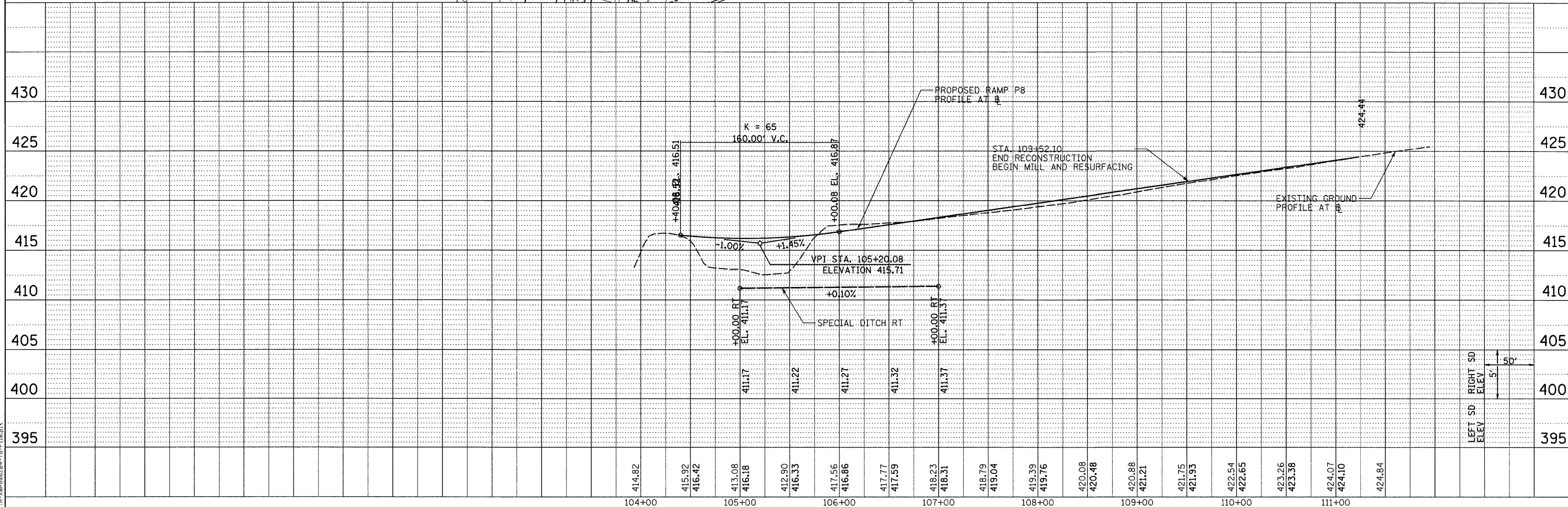

LAST SAVED = 3/16/2010
 PEN TABLE = V6.541
 PLOT DRIVER = TR-V60x6204-Ts-F10p14

FILE NAME =	USER NAME = sdonahue	DESIGNED -	REVISED -		PLAN PROPOSED RAMP P8	F.A.I. RTE. = 270	SECTION = 60-2RS-3	COUNTY = MADISON	TOTAL SHEETS = 231	SHEET NO. = 41		
1:\0906600\0906601\cad\1\plans\025.0876087-Sht-Plan-RampP8.dgn	PLOT SCALE = 50.0023' / IN.	CHECKED -	REVISED -			SCALE: 1"=50'	SHEET NO. 16 OF 16 SHEETS	STA. 103+93.40 TO STA. 111+23.40	CONTRACT NO. 76D87			
PLOT DATE = 3/16/2010 4:38:58 PM	DATE -	REVISED -	REVISED -			ILLINOIS FED. AID PROJECT						