

M3-1 MIN & STD;  
1.5" Radius, 0.6" Border, 0.4" Indent, Black on White;  
[NORTH] C 80ø spacing;

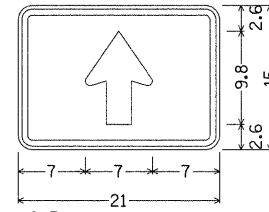

M6-3;  
1.5" Radius, 0.6" Border, 0.4" Indent, Black on White;

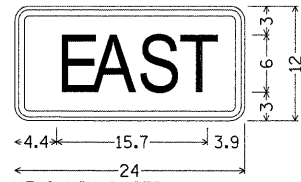

M3-2 MIN & STD;  
1.5" Radius, 0.6" Border, 0.4" Indent, Black on White;  
[EAST] C;

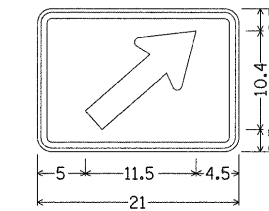

M6-2;  
1.5" Radius, 0.6" Border, 0.4" Indent, Black on White;

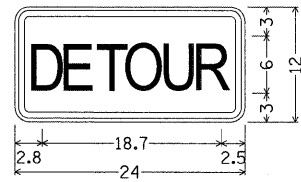

M4-8 MIN & STD;  
1.5" Radius, 0.6" Border, 0.4" Indent, Black on Orange;  
[DETOUR] B 80ø spacing;

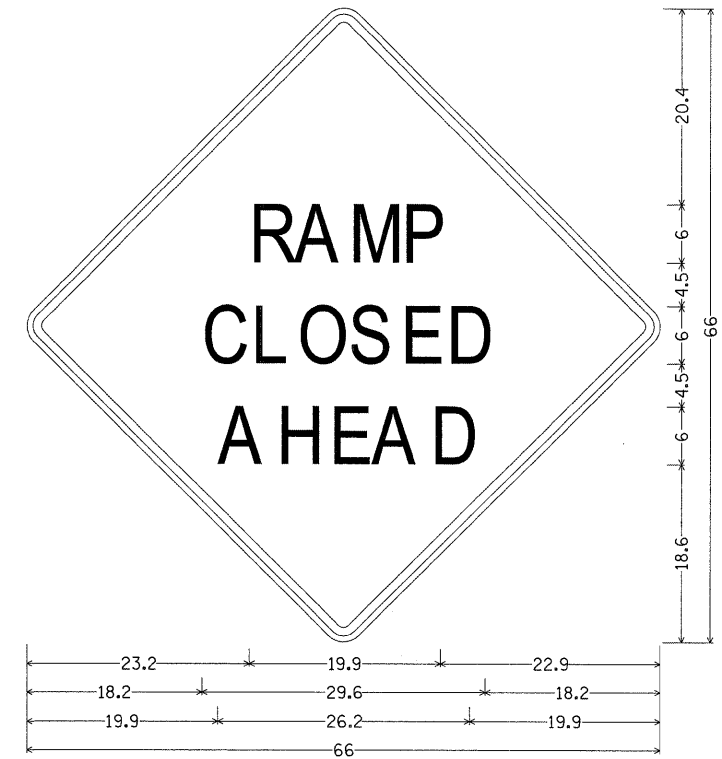

W20-2 MIN;  
48.0" across sides 2.3" Radius, 0.9" Border, 0.6" Indent, Black on Orange;  
[RAMP] D 60ø spacing; [CLOSED] D; [AHEAD] D 102ø spacing;

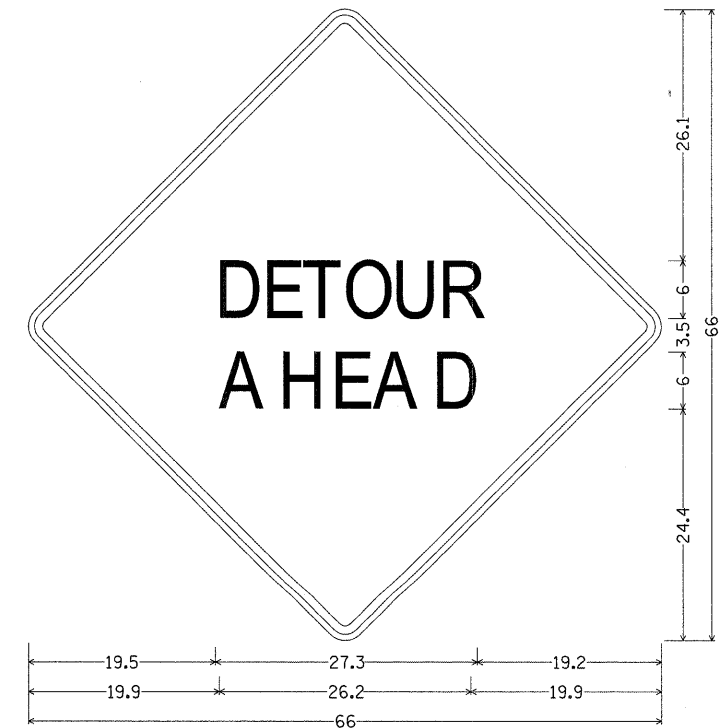

W20-2 MIN;  
48.0" across sides 2.3" Radius, 0.9" Border, 0.6" Indent, Black on Orange;  
[DETOUR] D 60ø spacing; [AHEAD] D 102ø spacing;

DETOUR SIGN SCHEDULE									
	ARROW DIAGONAL	ARROW UP	DETOUR	ILLINOIS 3	INTERSTATE 270	EAST	NORTH	RAMP CLOSED AHEAD	DETOUR AHEAD
STAGE 1	3	1	4		4	4		1	1
STAGE 2	3	1	4	4			4	1	1
TOTAL SETUPS	2	2	2	1	1	1	1	2	2
QUANTITY NEEDED	3	1	4	4	4	4	4	1	1

LAST SAVED = 3/13/2010  
PEN TABLE = V8.tbl  
PLOT DRIVER = TR-Xerox6204-To-File.plt

FILE NAME =	USER NAME = sdonahue	DESIGNED -	REVISED -	<b>STATE OF ILLINOIS DEPARTMENT OF TRANSPORTATION</b>	<b>HORNER &amp; SHIFRIN, INC. ENGINEERS</b>	<b>SUGGESTED STAGES OF CONSTRUCTION AND TRAFFIC CONTROL</b> DETOUR SIGNS	F.A.I. RTE:	SECTION	COUNTY	TOTAL SHEETS	SHEET NO.
\\0906600\0906601\cad\plans\026_087\0267-Sht-Staging-Details.dgn	PLOT SCALE = 50.0023' / IN.	DRAWN -	REVISED -				270	60-2RS-3	MADISON	231	42
PLOT DATE = 3/16/2010 4:39:00 PM	DATE -	CHECKED -	REVISED -				CONTRACT NO. 76D87				
							ILLINOIS FED. AID PROJECT				