

CABLE DIAGRAM LEGEND

- ELECTRIC CABLE IN CONDUIT
- EXISTING ELECTRIC CABLE IN CONDUIT
- S CABLE SPLICE (SEE GENERAL NOTES)
- 2/C INDICATES NUMBER OF CONDUCTORS IN CABLE
- CD CALL DELAY (SEE GENERAL NOTES)
- CCO CALL CARRY OVER (SEE GENERAL NOTES)
- EXISTING SERVICE INSTALLATION
- EXISTING ILLUMINATED SIGN
- #6 INDICATES AMERICAN WIRE GAUGE (AWG) SIZE 6 CONDUCTORS (SEE GENERAL NOTES)

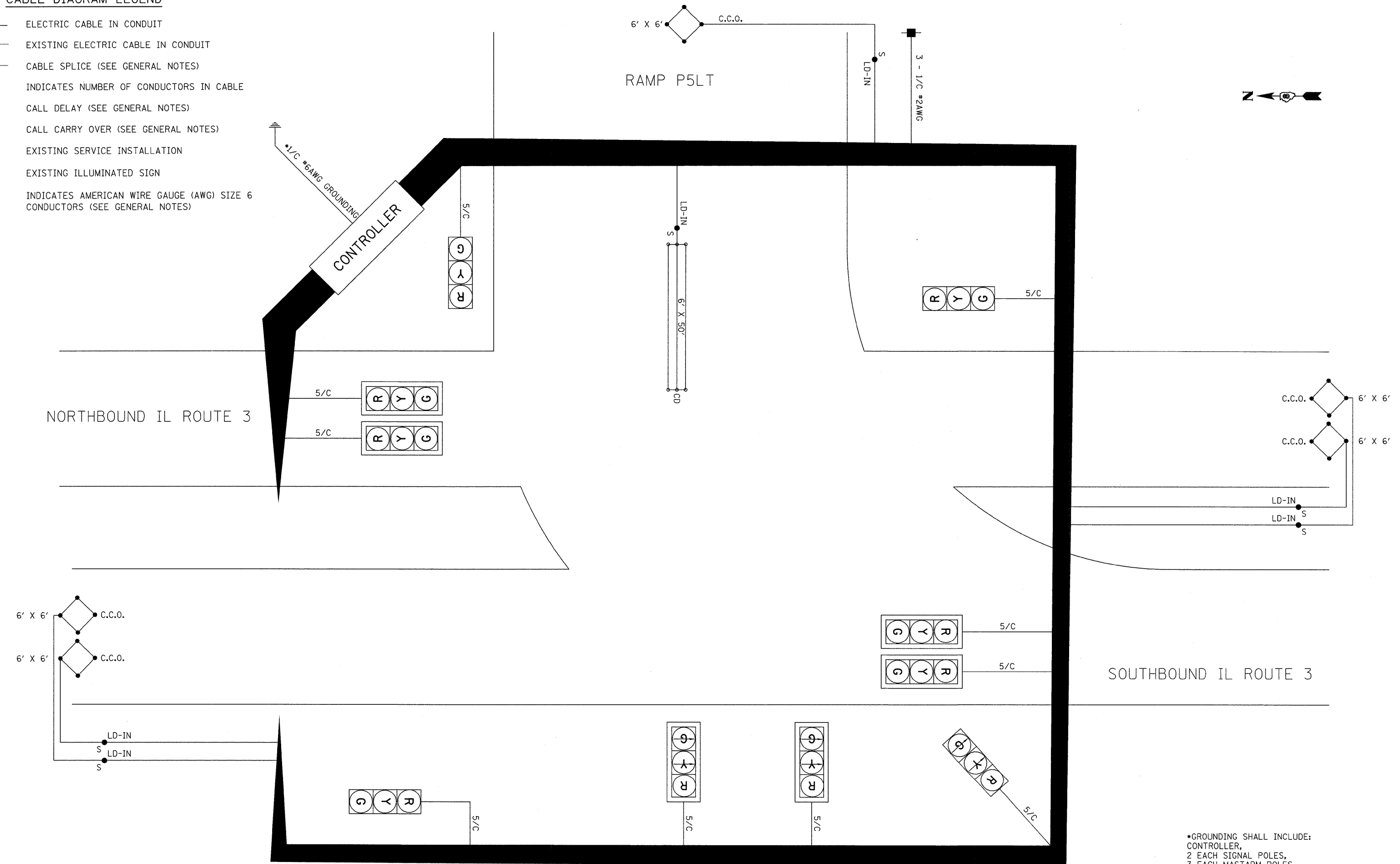

*GROUNDING SHALL INCLUDE:
 CONTROLLER,
 2 EACH SIGNAL POLES,
 3 EACH MASTARM POLES,
 DOUBLE HANDHOLE, AND
 4 EACH HANDHOLES AT INTERSECTION
 7 EACH HANDHOLES FOR ELECTRIC FEEDER
 (C.C.O. HANDHOLES DO NOT REQUIRE GROUNDING)

LAST SAVED = 3/13/2010
 PEN TABLE = VB.tbl
 PLOT DRIVER = TR-Xerox6204-To-File.plt

FILE NAME =	USER NAME = sdonahue	DESIGNED -	REVISED -
\\0906680\09066801\cad\plans\060_087\087-Shr-TS-RampP5LT-07.dgn		DRAWN -	REVISED -
PLOT SCALE = 20.0009' / IN.		CHECKED -	REVISED -
PLOT DATE = 3/16/2010 4:42:22 PM		DATE -	REVISED -

**STATE OF ILLINOIS
 DEPARTMENT OF TRANSPORTATION**

**HORNER &
 SHIFRIN, INC.
 ENGINEERS**

**TRAFFIC SIGNAL DETAILS
 IL 3 AT PROPOSED RAMP P5LT
 CABLE DIAGRAM**

F.A.I. RTE.	SECTION	COUNTY	TOTAL SHEETS	SHEET NO.
270	60-2RS-3	MADISON	231	77
CONTRACT NO. T6D87				
ILLINOIS FED. AID PROJECT				

SCALE: NONE SHEET NO. 7 OF 7 SHEETS STA. TO STA.