

DATE	
BY	
SURVEYED	
PLOTTED	
TEMPLATE	
NOTE BOOK	
AREAS CHECKED	
NO.	

DATE	
BY	
SURVEYED	
PLOTTED	
TEMPLATE	
NOTE BOOK	
AREAS CHECKED	
NO.	

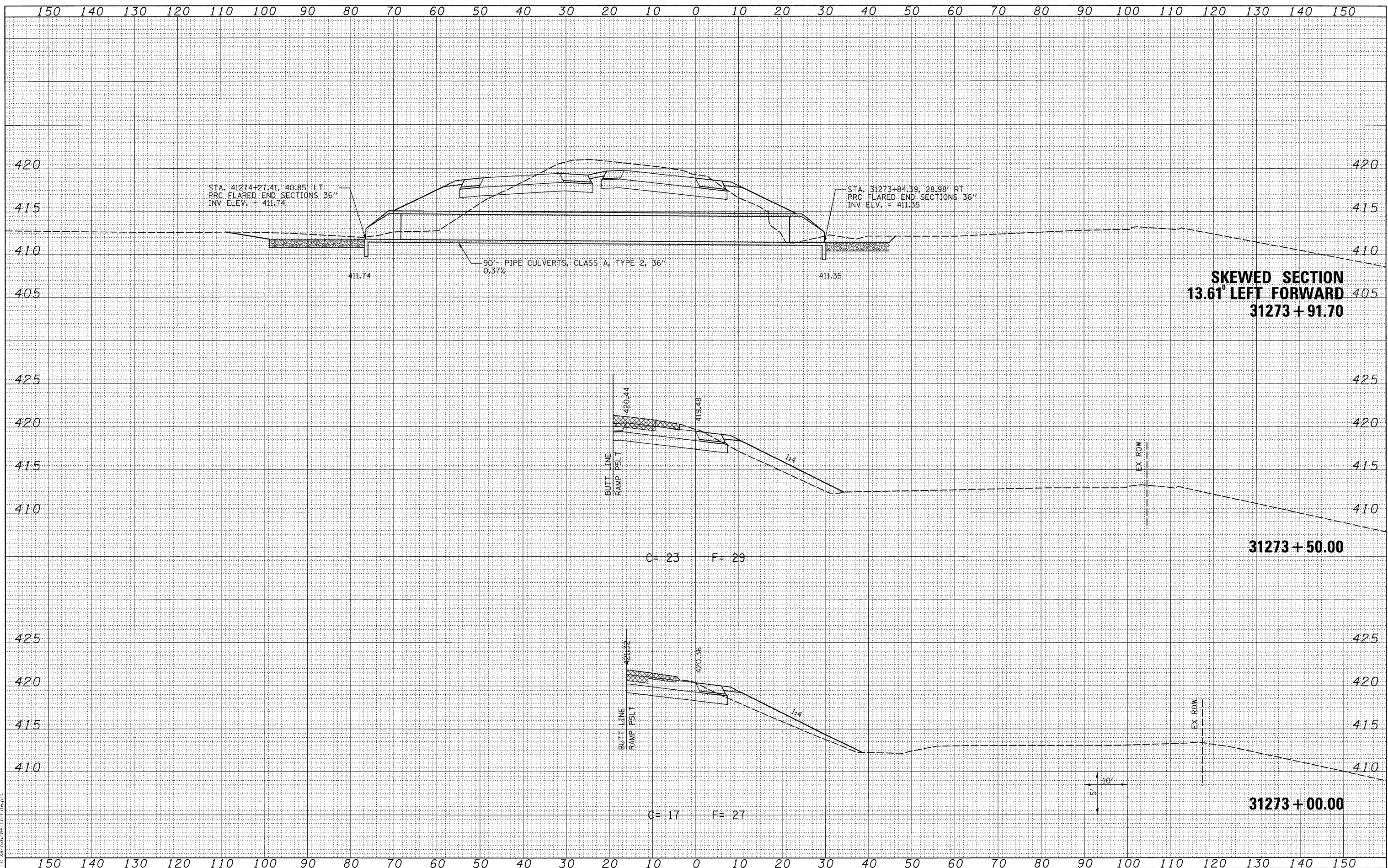

LAST SAVED = 3/16/2010
 PEN TABLE = V8.plt
 PLOT DRIVER = TR-V80x6204-Cor-File.plt

FILE NAME =
 H:\0906600\0906601\Cad\T\Plans\093_D876087-Sht-XSht-RampP5.dgn

USER NAME = sdonahue
 DESIGNED -
 DRAWN -
 CHECKED -
 DATE -

DESIGNED -
 REVISIONS:
 REVISIONS:
 REVISIONS:
 REVISIONS:

REVISIONS:
 REVISIONS:
 REVISIONS:
 REVISIONS:

STATE OF ILLINOIS
 DEPARTMENT OF TRANSPORTATION

HORNER &
 SHIFRIN, INC.
 ENGINEERS

CROSS SECTIONS
 PROPOSED RAMP P5
 SCALE: SEE SHT SHEET NO. 25 OF 30 SHEETS STA. 31273+00.00 TO STA. 31273+91.70

FAA RT-1 270	SECTION 60-2RS-3	COUNTY MADISON	TOTAL SHEETS 231	SHEET NO. 218
CONTRACT NO. 76D87			ILLINOIS FED. AID PROJECT	