

F.A.P. RTE.	SECTION	COUNTY	TOTAL SHEETS	SHEET NO.
312	101-2(RS-1,N-1)	ALEXANDER	189	63
STA.		TO STA.		
FED. ROAD DIST. NO.		ILLINOIS FED. AID PROJECT		

NOTE: CONSTRUCTION LIMITS ON NORTH SIDE HAVE BEEN OMITTED FOR CLARITY.

EXIST. IL RTE 146 & PROP. WESTBOUND LANES

PROP. EASTBOUND LANES IL RTE 146

BY	DATE

FINAL SURVEY PLOTTED  
NOTE BOOK TEMPLATE AREAS CHECKED  
NO.



1:500 RATIO

BM #7 - RR SPIKE IN BILLBOARD POST STA 3+120  
21.03 m RT, ELEV 101.396

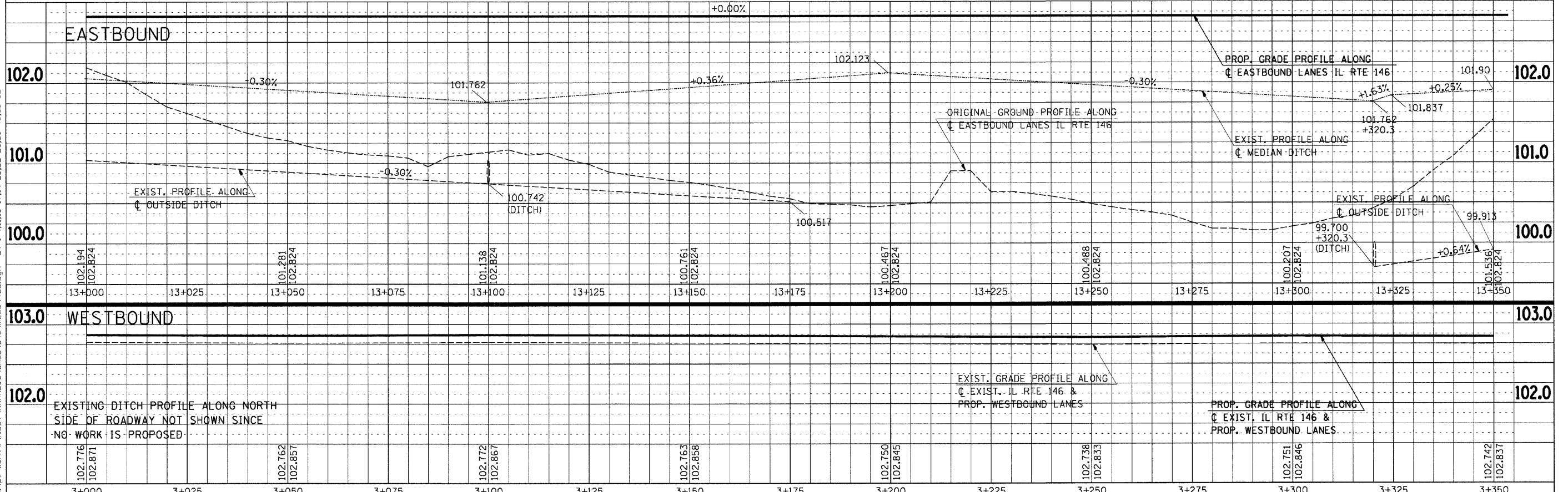

Tuesday September 15, 2009 @ 9:06:39 AM  
c:\pwworkspace\1001\KRRANZ\JC.dwg  
c:\pwworkspace\1001\KRRANZ\JC.dwg  
c:\pwworkspace\1001\KRRANZ\JC.dwg  
LV=2-23-25-63  
LV=1-57-15-17-21-23-62  
LV=1-51-11-13-17-19-20-22-23-25-48-50-62