

F.A.P. RTE.	SECTION	COUNTY	TOTAL SHEETS	SHEET NO.
312	101-2(RS-1,N-1)	ALEXANDER	189	102
STA. 2+844.90		TO STA. 2+875.00		
FED. ROAD DIST. NO.		ILLINOIS	FED. AID PROJECT	

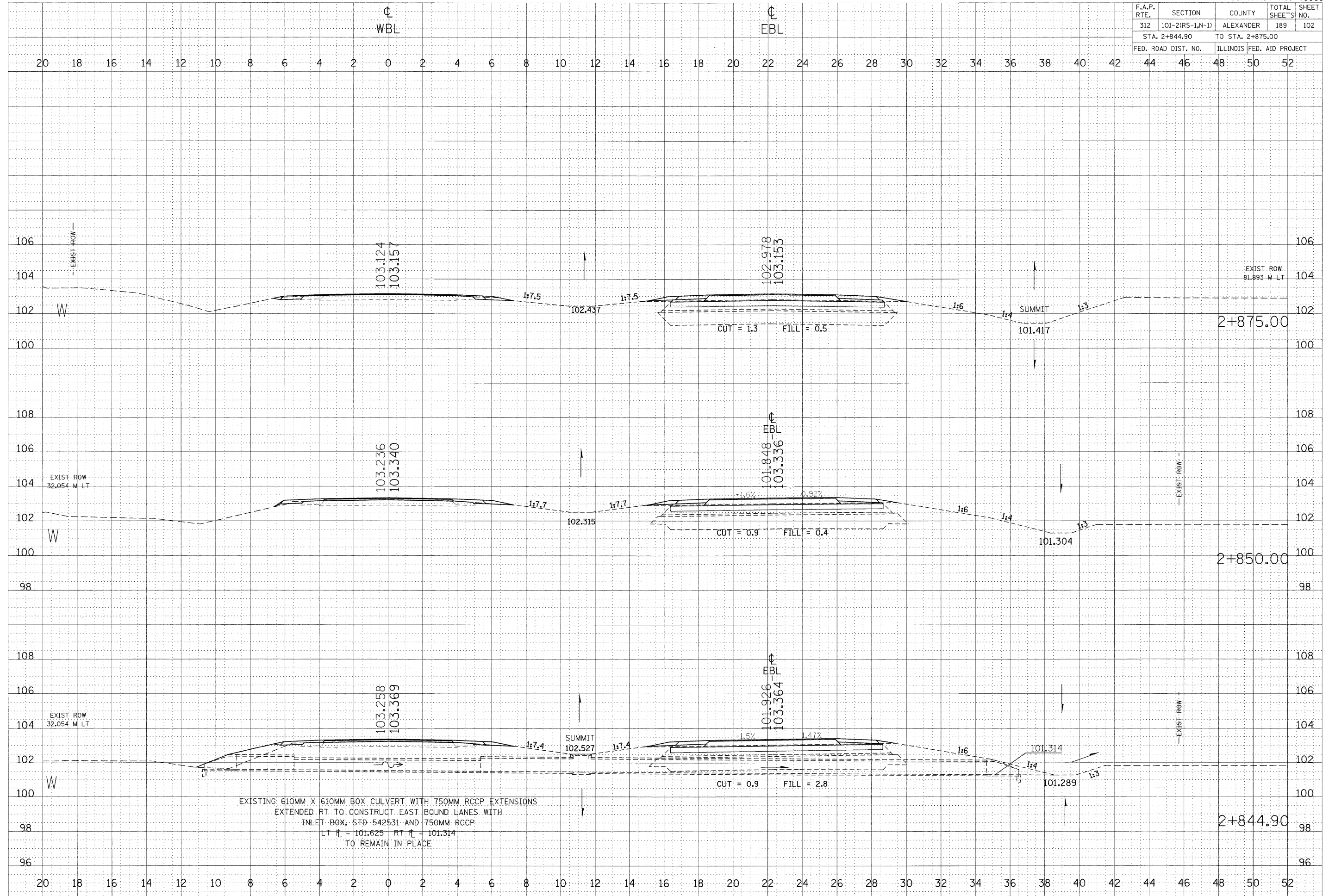

EXISTING 610MM X 610MM BOX CULVERT WITH 750MM RCCP EXTENSIONS  
 EXTENDED RT. TO CONSTRUCT EAST BOUND LANES WITH  
 INLET BOX, STD 542531 AND 750MM RCCP  
 LT  $\nabla$  = 101.625 RT  $\nabla$  = 101.314  
 TO REMAIN IN PLACE

DATE \_\_\_\_\_ BY \_\_\_\_\_  
 SURVEYED \_\_\_\_\_  
 PLOTTED \_\_\_\_\_  
 NOTE BOOK \_\_\_\_\_  
 AREAS CHECKED \_\_\_\_\_  
 NO. \_\_\_\_\_

DATE \_\_\_\_\_ BY \_\_\_\_\_  
 ORIGINAL SURVEY \_\_\_\_\_  
 PLOTTED \_\_\_\_\_  
 FILE NAME = c:\pwworkspace\101725999\101725999-1146.rvt  
 PLOT SCALE = 100:1  
 USER NAME = jef@acivil.com

PLOT DATE = 9/17/2009  
 FILE NAME = c:\pwworkspace\101725999\101725999-1146.rvt  
 PLOT SCALE = 100:1  
 USER NAME = jef@acivil.com