

F.A.P. RTE.	SECTION	COUNTY	TOTAL SHEETS	SHEET NO.
312	101-2(RS-1,N-1)	ALEXANDER	189	113
STA. 3+725.00		TO STA. 3+787.00		
FED. ROAD DIST. NO.		ILLINOIS FED. AID PROJECT		

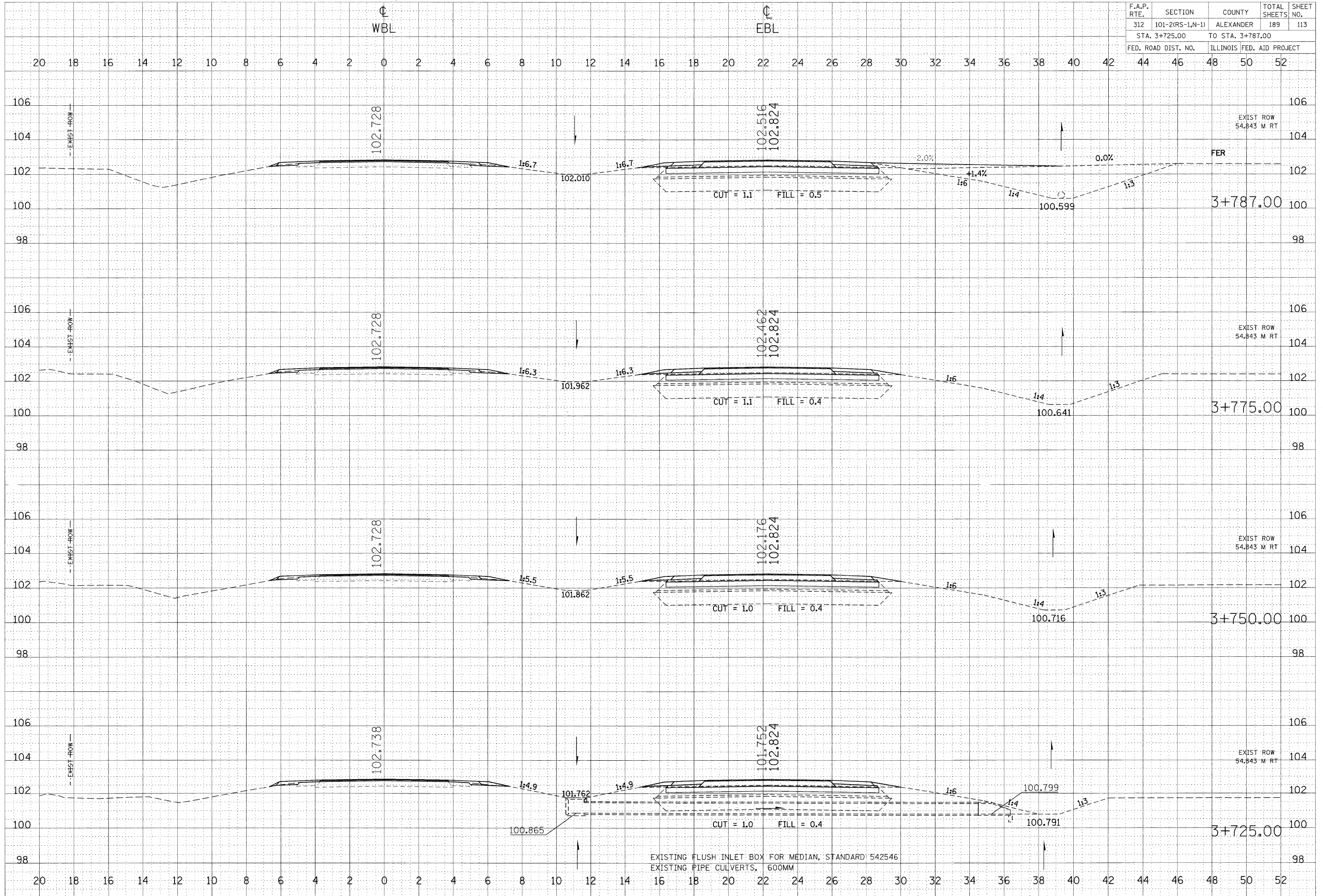

EXISTING FLUSH INLET BOX FOR MEDIAN, STANDARD 542546
 EXISTING PIPE CULVERTS, 600MM

FINAL SURVEY BY DATE
 SURVEYED BY
 CHECKED BY
 NOTE BOOK NO.
 TYPING AREAS CHECKED

ORIGINAL SURVEY BY DATE
 SURVEYED BY
 CHECKED BY
 USER NAME = lrtatord

PLOT DATE = 9/17/2009
 FILE NAME = c:\pwworking\pwworking\plott\101-2(rs-1,n-1)\101-2(rs-1,n-1)-c2.mxd
 USER NAME = lrtatord