

STATE OF ILLINOIS
 DEPARTMENT OF TRANSPORTATION
 DIVISION OF HIGHWAYS

**PROPOSED
 HIGHWAY PLANS**

FAP ROUTE 841 (IL 154)
 SECTION 108N-1
 PROJECT: *HSIP-0841(012)*
 INTERSECTION IMPROVEMENT
 PERRY COUNTY

C-99-013-09

F.A.P. RTE.	SECTION	COUNTY	TOTAL SHEETS	SHEET NO.
841	108N-1	PERRY	76	1
		ILLINOIS	CONTRACT NO. 78098	

D-99-005-09

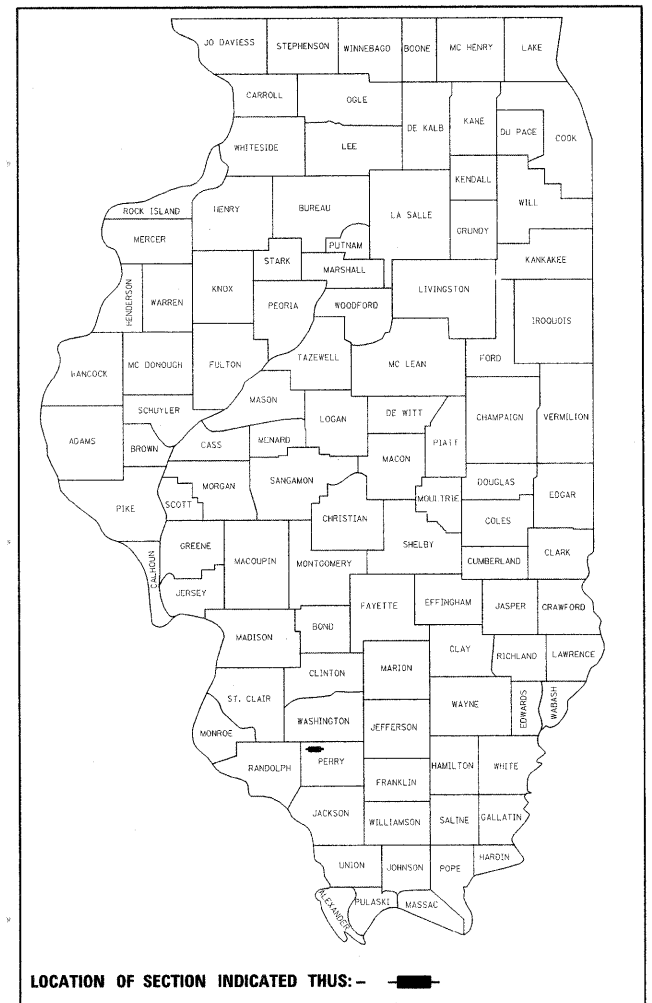

LOCATION OF SECTION INDICATED THUS: - [thick black line] -

FOR INDEX OF SHEETS, SEE SHEET NO. 2
 FOR SUMMARY OF QUANTITIES, SEE SHEET NO. 4

APPROACH	ADT(2009)	% TRUCK
IL 154 W. OF WHITE WALNUT RD.	5,700	9.7%
WHITE WALNUT N. OF IL 154	750	7.2%
IL 154 E. OF WHITE WALNUT RD.	5,000	13.5%
PICK RD. S. OF IL 154	200	4.8%

PROPOSED PROJECT BEGINS
 (IL 154) STA 72+50

PROPOSED PROJECT ENDS
 (IL 154) STA 109+80.15

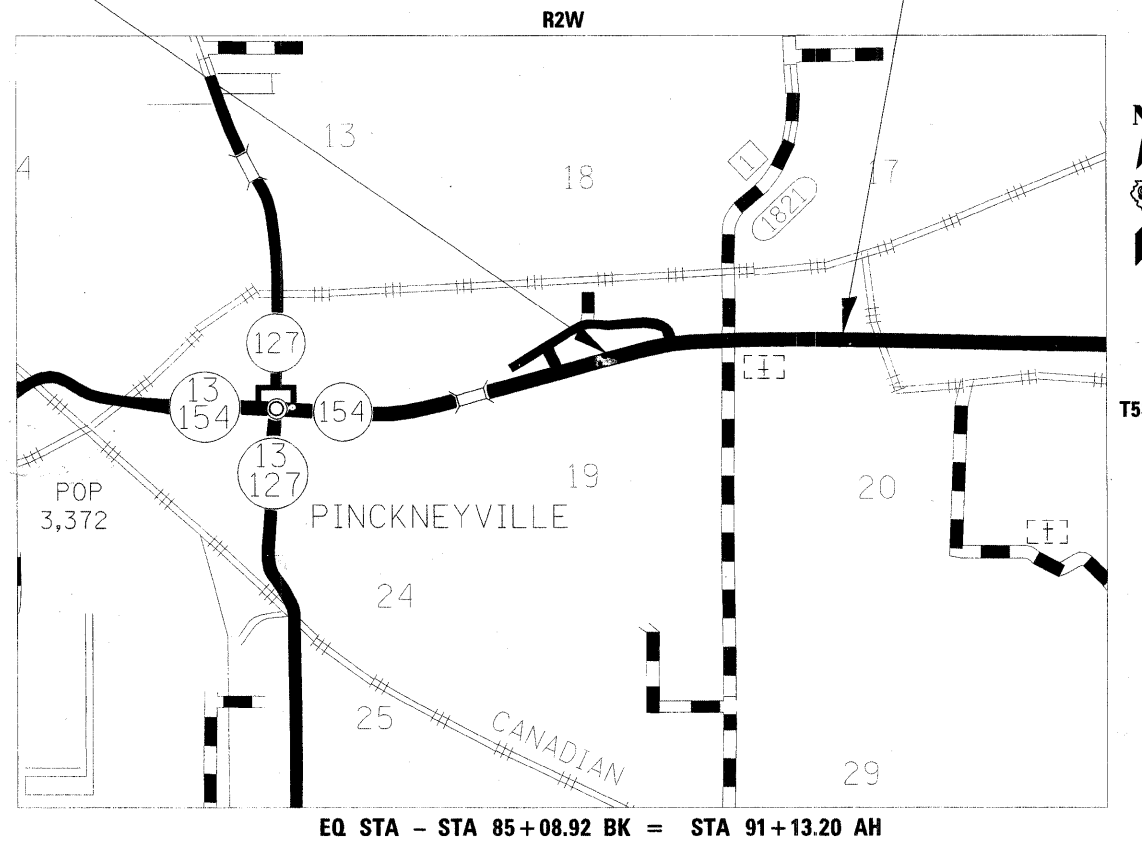

GROSS LENGTH = 3125.87 FT. = 0.592 MILE
 NET LENGTH = 3125.87 FT. = 0.592 MILE

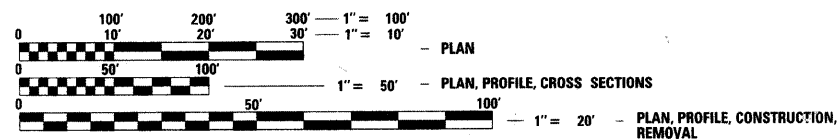

FULL SIZE PLANS HAVE BEEN PREPARED USING STANDARD ENGINEERING SCALES. REDUCED SIZED PLANS WILL NOT CONFORM TO STANDARD SCALES. IN MAKING MEASUREMENTS ON REDUCED PLANS, THE ABOVE SCALES MAY BE USED.

J.U.L.I.E.
 JOINT UTILITY LOCATION INFORMATION FOR EXCAVATION
 1-800-892-0123
 OR 811

PROJECT ENGINEER SEAN GREENLEE
 PROJECT MANAGER SUSAN POE

CONTRACT NO. 78098

STATE OF ILLINOIS
 DEPARTMENT OF TRANSPORTATION
 DIVISION OF HIGHWAYS

SUBMITTED Jan 29 2010

Mary C. Lammie
 DEPUTY DIRECTOR OF HIGHWAYS, REGION ENGINEER

May 7 2010
Scott E. Stitt, P.E.
 acting ENGINEER OF DESIGN AND ENVIRONMENT

May 7 2010
Christine M. Reed
 DIRECTOR OF HIGHWAYS, CHIEF ENGINEER

**PRINTED BY THE AUTHORITY
 OF THE STATE OF ILLINOIS**