

Bench Mark: Chiseled square on SW corner of parapet wall on SN 028-0005.
Sta 120+70, 60' RT. Elev. 421.74

STATE OF ILLINOIS
DEPARTMENT OF TRANSPORTATION

Existing Structure: S.N. 028-0004 N.B. and 028-0005 S.B. Built in 1962 as F.A.I. Rte 57, Section 28-5VB, at Sta. 119+71.94. Existing dual structures each consist of a four-span reinf. concrete deck on steel WF beams supported by spill-thru pile bent abuts. and multi-column piers. 195'-0" Bk. to Bk. abutments. 42'-0" out-to-out deck. Structures to be removed and replaced. C.&E.I.R.R. track is currently abandoned.

Traffic Control: Staged construction will be utilized.

Salvage: None

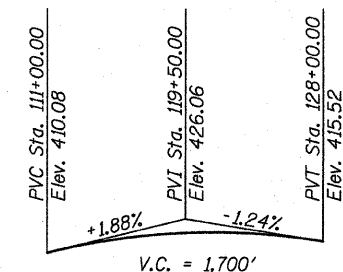
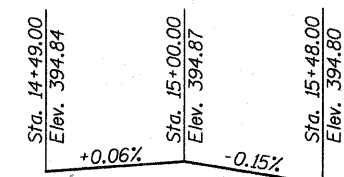

PROFILE GRADE - 7th ST.
(along centerline of roadway)

PROFILE GRADE - I-57
(along P.G.L. of N.B. & S.B. roadway)

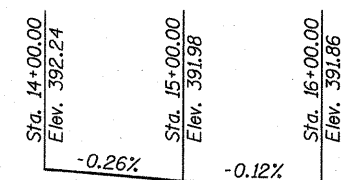

PROFILE GRADE - C.&E.I.R.R.
(along theoretical top of rail)

STATION 119+71.18
BUILT 20__ BY
STATE OF ILLINOIS
FAI ROUTE 57 SEC (28-5)VB-1
LOADING HS20 & ALT.
STRUCTURE NO. 028-0079

NAME PLATE (N.B.)
See Std. 515001

STATION 119+71.18
BUILT 20__ BY
STATE OF ILLINOIS
FAI ROUTE 57 SEC (28-5)VB-1
LOADING HS20 & ALT.
STRUCTURE NO. 028-0080

NAME PLATE (S.B.)
See Std. 515001

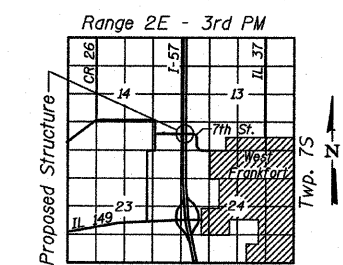

LOCATION SKETCH

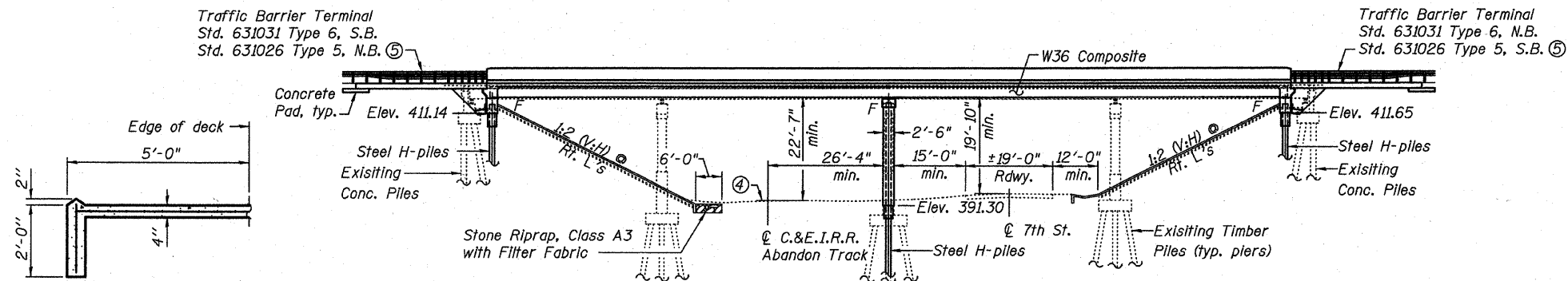

SECTION A-A

- Notes:
- See Sheet 2 of 29 for Index of Sheets
 - Contractor shall verify location of 4" high pressure gas main prior to removal of pier 2.
 - No freefall deck drains will be permitted within the limits of the C.&E.I.R.R. ROW.
 - The C.&E.I.R.R. track is currently abandoned. The theoretical top of rail elevations are taken from the existing 1962 plans and adjusted to match the proposed datum.
 - Traffic Barrier Terminal, Type 5 used to tie into proposed guardrail.

DESIGN STRESSES

FIELD UNITS
f'c = 3,500 psi
fy = 60,000 psi (Reinforcement)
fy = 50,000 psi (M270 Grade 50)

SEISMIC DATA

Seismic Performance Category (SPC) = B
Bedrock Acceleration Coefficient (A) = 0.12g
Site Coefficient (S) = 1.0

DESIGN SPECIFICATIONS

2002 AASHTO

LOADING HS20-44 & ALT.

Allow 50#/sq. ft. for future wearing surface.

APPROVED

FOR STRUCTURAL ADEQUACY ONLY
Ralph E. Anderson (PE)
ENGINEER OF BRIDGES AND STRUCTURES

GENERAL PLAN & ELEVATION
INTERSTATE 57 OVER 7TH STREET
AND C.&E.I. RAILROAD R.O.W.
FAI ROUTE 57-SECTION (28-5)VB-1
FRANKLIN COUNTY
STATION 119+71.18
STRUCTURE NO. 028-0079 (N.B.)
STRUCTURE NO. 028-0080 (S.B.)

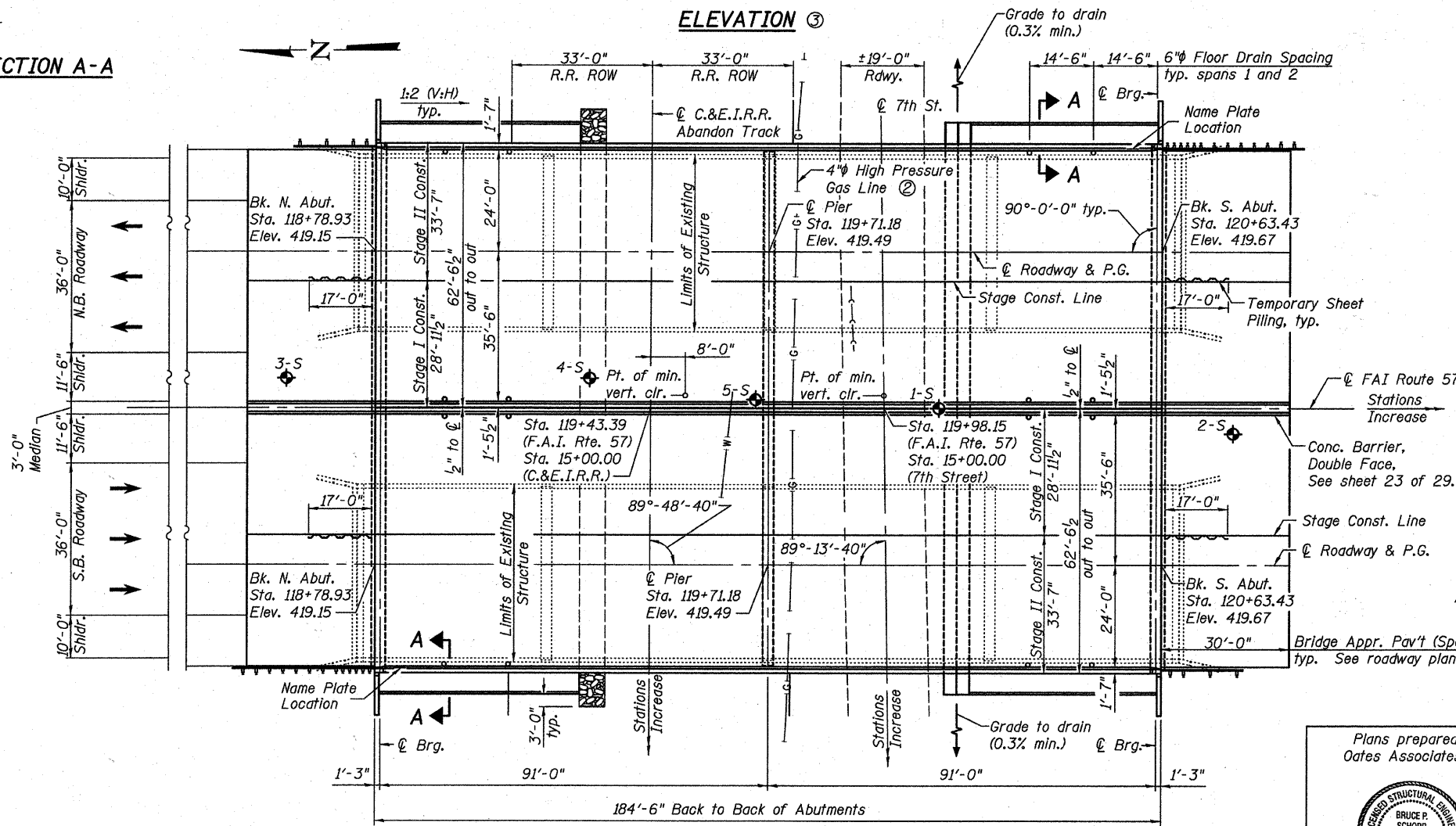

PLAN

Indicates Soil Boring Location

Plans prepared by
Oates Associates, Inc.

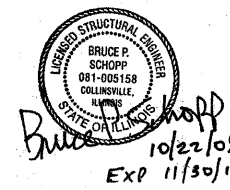

SHEET NO. 1	F.A.I. RTE.	SECTION	COUNTY	TOTAL SHEETS	SHEET NO.
	57	(28-5)VB-1	FRANKLIN	81	24
SHEETS 29	CONTRACT NO. 78157				
FED. ROAD DIST. NO. 7 ILLINOIS FED. AID PROJECT					



Eastport Business Center 1
100 Lanter Court, Suite 1
Collinsville, Illinois 62234
618-345-2200
Design Firm License No. 184.001115

DESIGNED	JAD
CHECKED	MJP
DRAWN	JAD
CHECKED	MJP