

STAGE 3

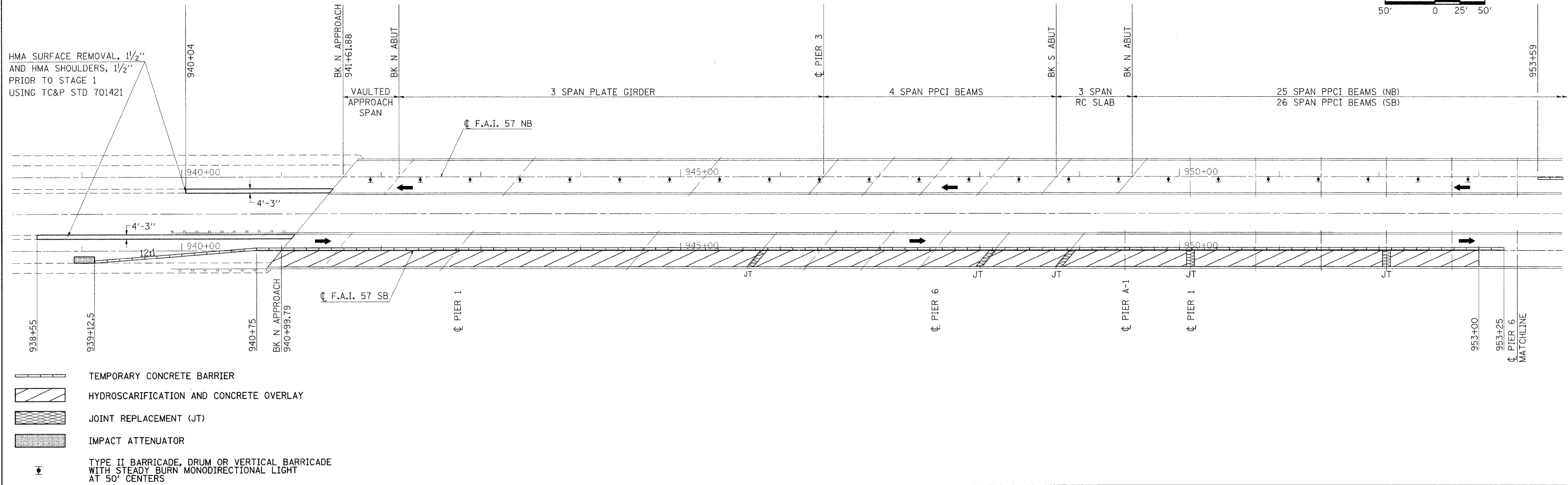

- TEMPORARY CONCRETE BARRIER
- HYDROSCARIFICATION AND CONCRETE OVERLAY
- JOINT REPLACEMENT (JT)
- IMPACT ATTENUATOR
- TYPE II BARRICADE, DRUM OR VERTICAL BARRICADE WITH STEADY BURN MONODIRECTIONAL LIGHT AT 50' CENTERS

STAGE 3

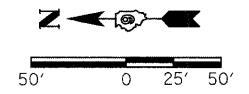
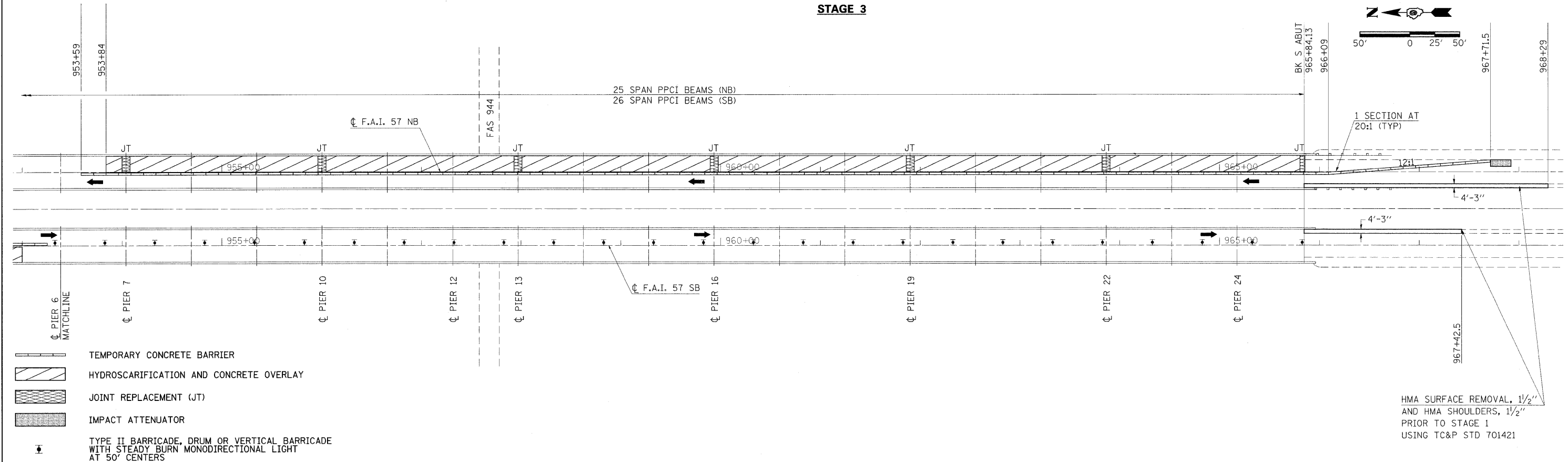
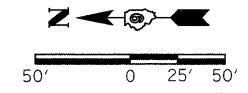

- TEMPORARY CONCRETE BARRIER
- HYDROSCARIFICATION AND CONCRETE OVERLAY
- JOINT REPLACEMENT (JT)
- IMPACT ATTENUATOR
- TYPE II BARRICADE, DRUM OR VERTICAL BARRICADE WITH STEADY BURN MONODIRECTIONAL LIGHT AT 50' CENTERS

HMA SURFACE REMOVAL, 1/2"
AND HMA SHOULDERS, 1/2"
PRIOR TO STAGE 1
USING TC&P STD 701421

FILE NAME =	USER NAME = cornellm	DESIGNED -	REVISED -	STATE OF ILLINOIS DEPARTMENT OF TRANSPORTATION	TRAFFIC CONTROL STAGE 3			F.A.I. RTE.	SECTION	COUNTY	TOTAL SHEETS	SHEET NO.			
c:\p\work\p\dot\cornellm\0170060\002-0001_0002-ehf-misc.dgn	PLOT SCALE = 50.0000' / IN.	DRAWN -	REVISED -		SCALE: 1"=50'	SHEET NO.	OF	SHEETS	STA.	TO STA.	57	D9 BSMART 2010-1	ALEXANDER	25	7
	PLOT DATE = 2/22/2018	CHECKED -	REVISED -												
		DATE -	REVISED -												
											CONTRACT NO. 78173			ILLINOIS FED. AID PROJECT	