

STATIONS	EOP STATIONING ALONG HALFWAY RD.	OFFSET TO E.P.	EDGE OF PAVMT ELEV.	EOP STATIONING ALONG IL 13 WB	OFFSET TO E.P.	DISTANCE ALONG RADIUS
		FEET	FEET		FEET	FEET
0+00			451.26	791+04.31	48.00	10
0+10			451.19	791+14.23	48.32	10
0+20			451.12	791+24.10	49.28	10
0+30			451.05	791+33.89	50.88	10
0+40			451.14	791+43.55	53.09	10
0+50			451.17	791+53.06	55.94	10
0+60			451.30	791+62.05	59.39	10
0+70			451.43	791+71.41	63.44	10
0+80			451.56	791+80.19	68.05	10
0+90			451.62	791+88.64	73.23	10
1+00			451.72	791+96.75	78.95	10
1+10	407+00.21	55.99	451.82			10
1+20	406+91.43	51.20	451.92			10
1+30	406+82.43	46.84	452.02			10
1+40	406+73.26	42.85	452.12			10
1+50	406+63.94	39.22	452.22			10
1+60	406+54.49	35.98	452.32			10
1+70	406+44.91	33.11	452.42			10
1+80	406+35.22	30.63	452.52			10
1+90	406+25.44	28.54	452.62			10
2+00	406+15.59	26.84	452.72			10
2+10	406+05.67	25.53	452.82			10

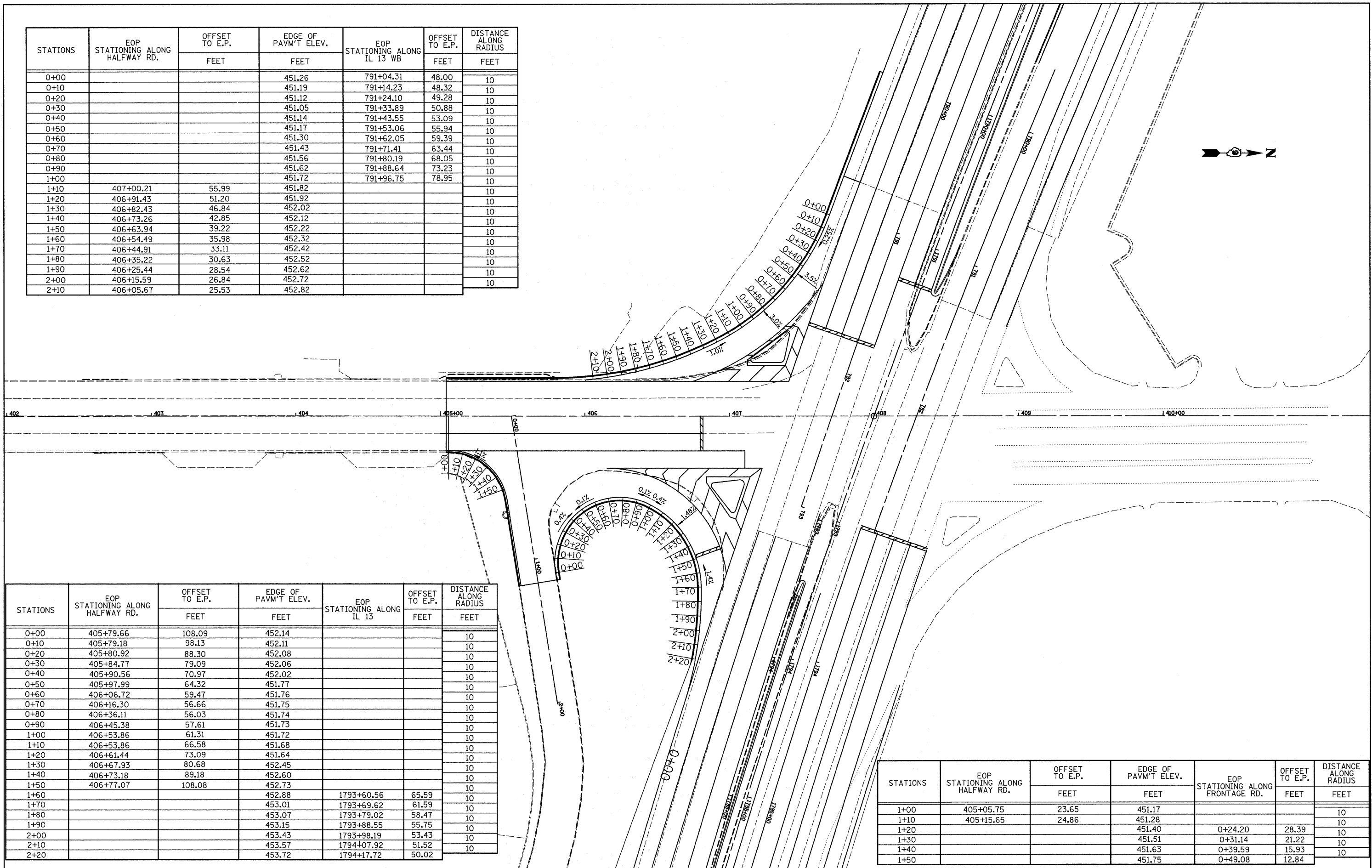

STATIONS	EOP STATIONING ALONG HALFWAY RD.	OFFSET TO E.P.	EDGE OF PAVMT ELEV.	EOP STATIONING ALONG IL 13	OFFSET TO E.P.	DISTANCE ALONG RADIUS
		FEET	FEET		FEET	FEET
0+00	405+79.66	108.09	452.14			10
0+10	405+79.18	98.13	452.11			10
0+20	405+80.92	88.30	452.08			10
0+30	405+84.77	79.09	452.06			10
0+40	405+90.56	70.97	452.02			10
0+50	405+97.99	64.32	451.77			10
0+60	406+06.72	59.47	451.76			10
0+70	406+16.30	56.66	451.75			10
0+80	406+36.11	56.03	451.74			10
0+90	406+45.38	57.61	451.73			10
1+00	406+53.86	61.31	451.72			10
1+10	406+53.86	66.58	451.68			10
1+20	406+61.44	73.09	451.64			10
1+30	406+67.93	80.68	452.45			10
1+40	406+73.18	89.18	452.60			10
1+50	406+77.07	108.08	452.73			10
1+60			452.88	1793+60.56	65.59	10
1+70			453.01	1793+69.62	61.59	10
1+80			453.07	1793+79.02	58.47	10
1+90			453.15	1793+88.55	55.75	10
2+00			453.43	1793+98.19	53.43	10
2+10			453.57	1794+07.92	51.52	10
2+20			453.72	1794+17.72	50.02	10

STATIONS	EOP STATIONING ALONG HALFWAY RD.	OFFSET TO E.P.	EDGE OF PAVMT ELEV.	EOP STATIONING ALONG FRONTAGE RD.	OFFSET TO E.P.	DISTANCE ALONG RADIUS
		FEET	FEET		FEET	FEET
1+00	405+05.75	23.65	451.17			10
1+10	405+15.65	24.86	451.28			10
1+20			451.40	0+24.20	28.39	10
1+30			451.51	0+31.14	21.22	10
1+40			451.63	0+39.59	15.93	10
1+50			451.75	0+49.08	12.84	10