

DATE	
BY	
DESIGNED	
PLANNED	
NOTED	
ALIGNED	
CHECKED	
NO. FILE NAME	

DATE	
BY	
DESIGNED	
PLANNED	
NOTED	
ALIGNED	
CHECKED	
NO. FILE NAME	

FILE NAME = s:\broad\1000008\BureauCounty\Design\swppp\01.dgn

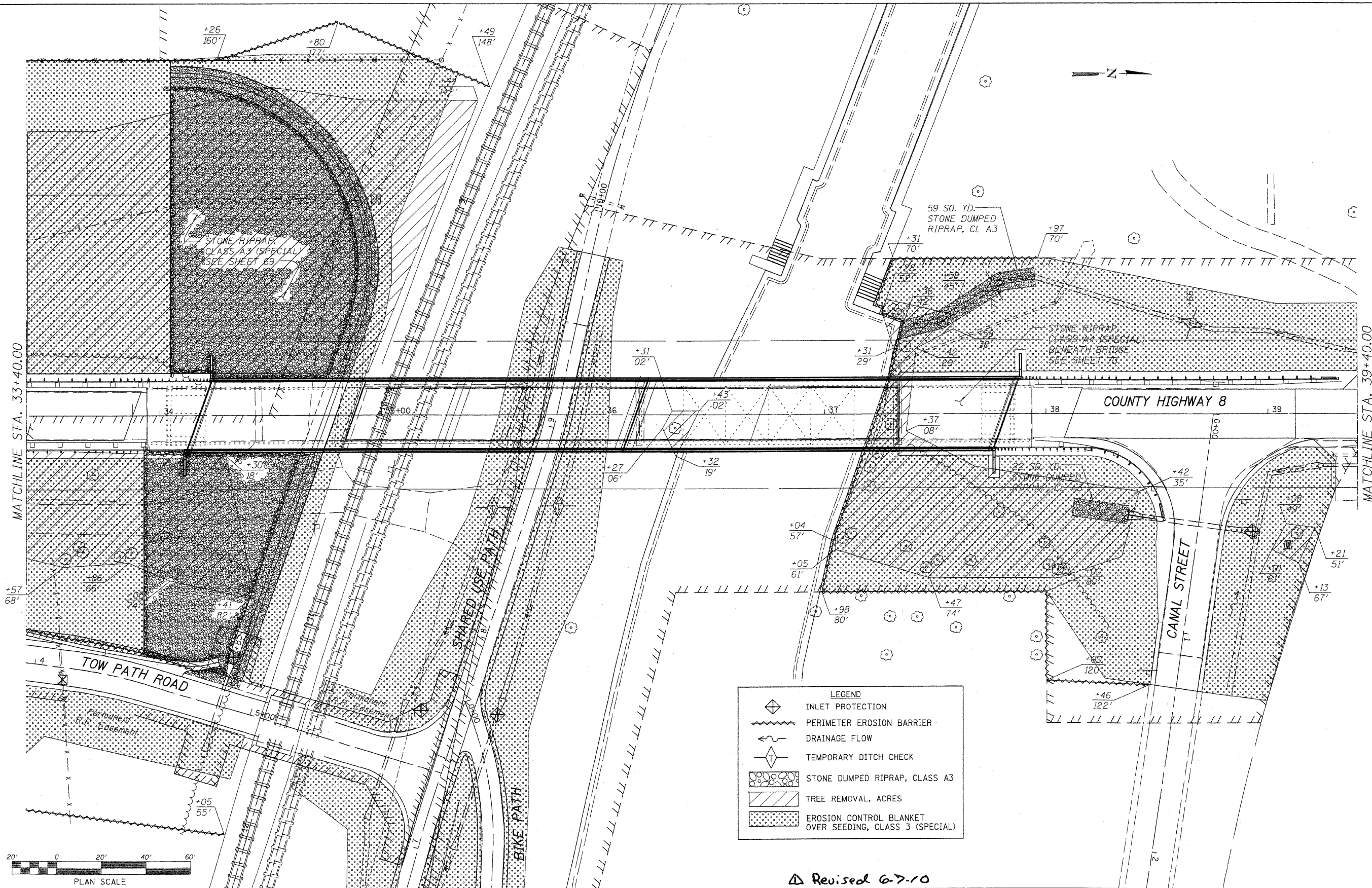

Revised 6-7-10

WILLET, HOFMANN & ASSOCIATES, INC.
CONSULTING ENGINEERS
 600 East Second Street, Dixon, IL 61021
 Phone: 815.284.3381 Fax: 815.284.3385
 Design Firm # 184-00918
 www.willett-hofmann.com

USER NAME =	DESIGNED -	REVISED -
PLOT SCALE =	DRAWN -	REVISED -
PLOT DATE =	CHECKED -	REVISED -
	DATE -	REVISED -

BUREAU COUNTY
BRIDGE REPLACEMENT
FAS 188 (C.H. 8) OVER IAIS RAILROAD & THE HENNEPIN CANAL

SWPPP - C.H. 8

F.A.S.	SECTION	COUNTY	TOTAL SHEETS	SHEET NO.
188	05-00195-00-BR	BUREAU	127	55
STA. 33+40 TO STA. 39+40		CONTRACT NO. 81380		
FED. ROAD DIST. NO. 2 ILLINOIS FED. AID PROJECT BRS-0188(118)				