

DATE	
BY	
FINAL SURVEY	
SURVEY PLOTTED	
NOTE BOOK	
AREAS CHECKED	
NO.	

DATE	
BY	
ORIGINAL SURVEY	
SURVEY PLOTTED	
NOTE BOOK	
AREAS CHECKED	
NO.	

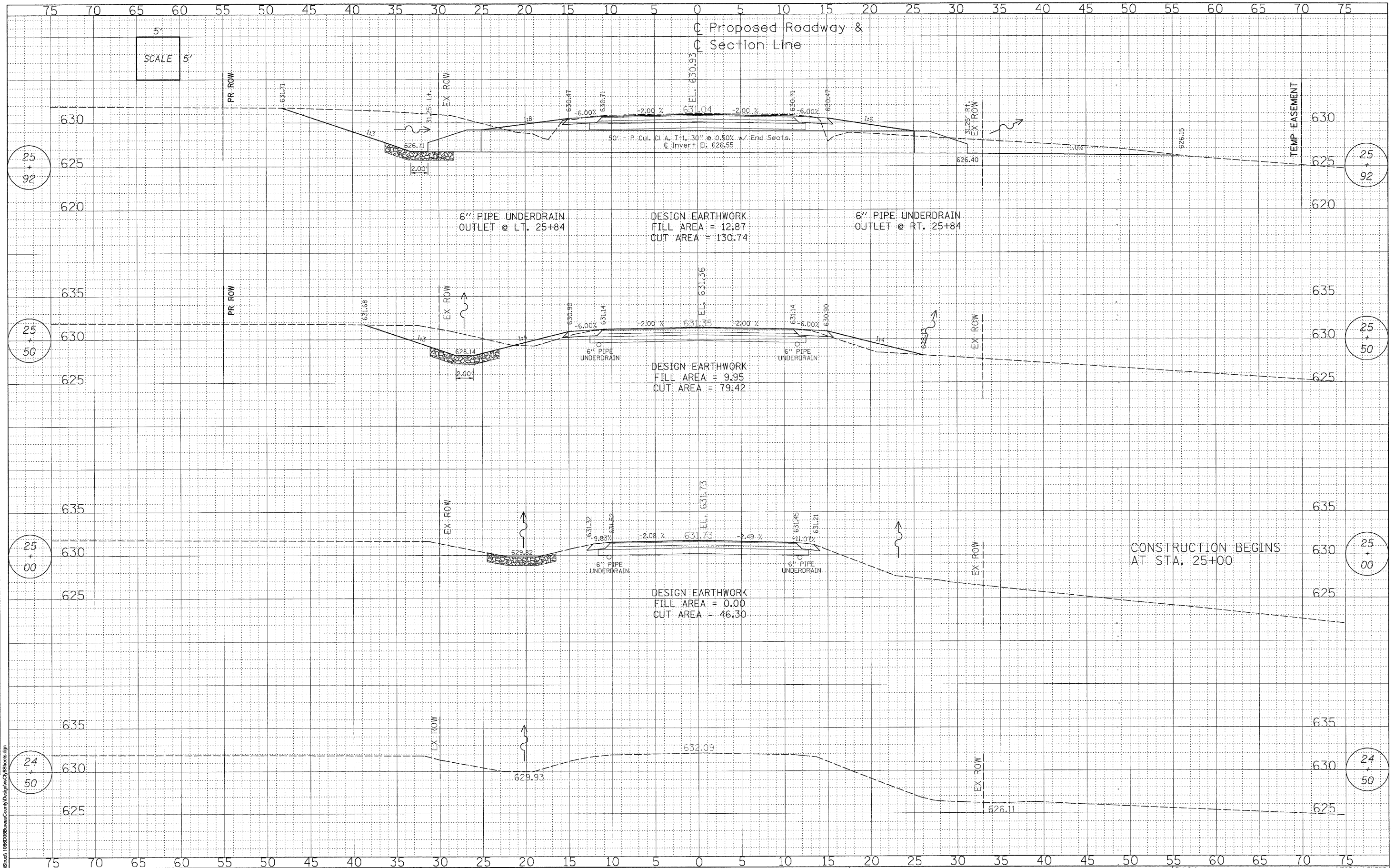

FILE NAME: s:\Sheet\106808\Bureau\County\Design\CrossSections.dgn

WILLET, HOFMANN & ASSOCIATES, INC.
CONSULTING ENGINEERS
 609 East Second Street, Dixon, IL 61021
 Phone: 815.284.3381 Fax: 815.284.3385
 Design Firm 184-00918
 www.willett-hofmann.com

USER NAME =	DESIGNED -	REVISED -
PLOT SCALE =	DRAWN -	REVISED -
PLOT DATE =	CHECKED -	REVISED -
	DATE -	REVISED -

BUREAU COUNTY
BRIDGE REPLACEMENT
FAS 188 (C.H. 8) OVER IAIS RAILROAD & THE HENNEPIN CANAL

C.H. 8 / TOW PATH RD - CROSS SECTIONS

F.A.S. RTE.	SECTION	COUNTY	TOTAL SHEETS	SHEET NO.
188	05-00195-00-BR	BUREAU	127	19
STA. 24+50.00 TO STA. 25+92.00		CONTRACT NO. 87380		
FED. ROAD DIST. NO. 7 [ILLINOIS] FED. AID PROJECT BRS-0188(118)				