

SECTION A-A

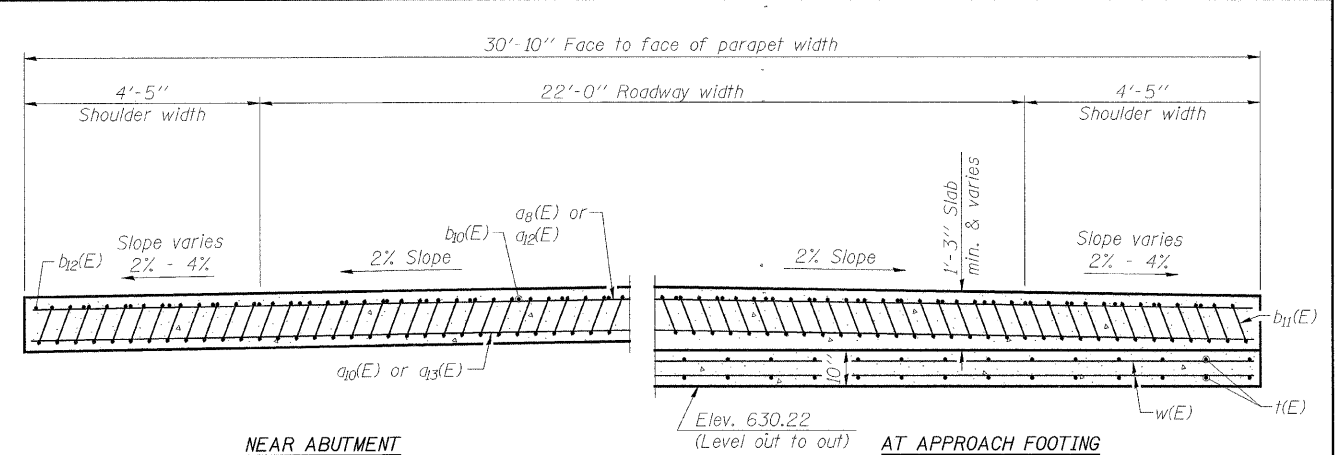

NEAR ABUTMENT

SECTION B-B

(See Plan for dimensions not shown)

* Tilt #9 b₁₁(E) bars as required to maintain clearance.
 ** Cost included with Concrete Superstructure.

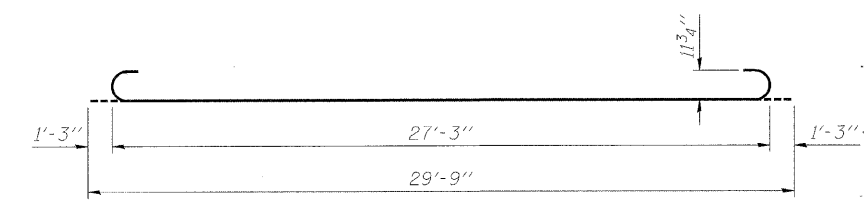

BAR b₁₁(E)

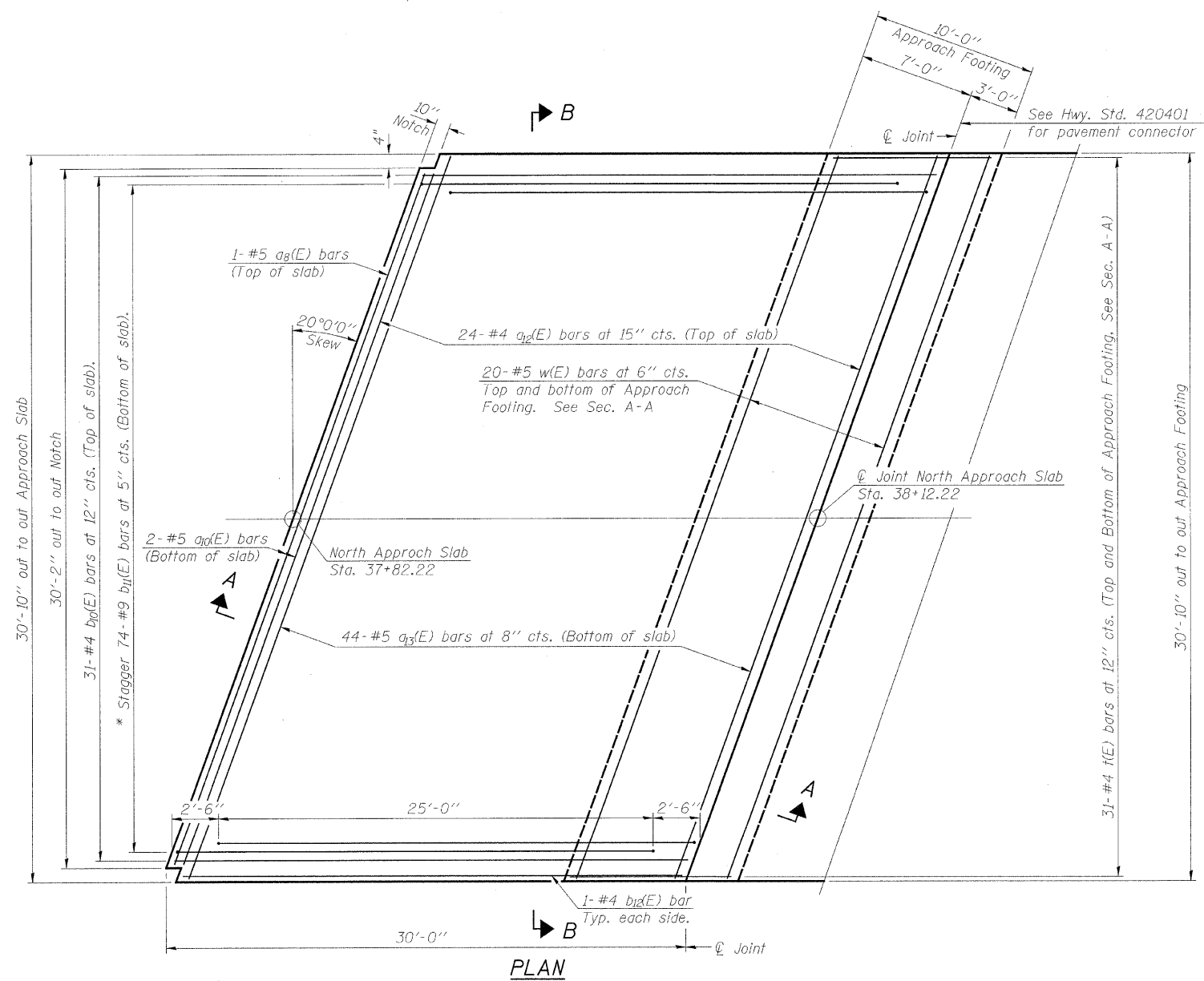

PLAN

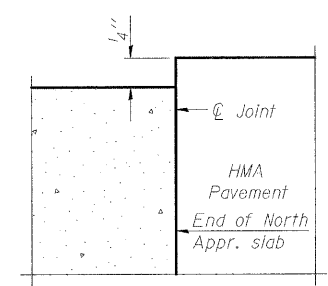

**FLEXIBLE PAVEMENT
DETAIL A**

BILL OF MATERIAL

Bar	No.	Size	Length	Shape
a ₈ (E)	1	#5	31'-9"	—
a ₁₀ (E)	2	#5	31'-9"	—
a ₁₂ (E)	24	#4	32'-5"	—
a ₁₃ (E)	44	#5	32'-5"	—
b ₁₀ (E)	31	#4	29'-8"	—
b ₁₁ (E)	74	#9	29'-9"	—
b ₁₂ (E)	2	#4	28'-10"	—
t(E)	62	#4	9'-8"	—
w(E)	40	#5	32'-5"	—
Concrete Structures			Cu. Yd.	10.1
Concrete Superstructure			Cu. Yd.	44.8
Bridge Deck Grooving			Sq. Yd.	96
Protective Coat			Sq. Yd.	103
Reinforcement Bars, Epoxy Coated			Pound	12,000

NOTES:

a₁₂(E), a₁₃(E), and w(E) bar spacings measured along ϕ Rdwy.
 Approach slab concrete shall be paid for as Concrete Superstructure.
 Approach footing concrete shall be paid for as Concrete Structures.
 Reinforcement shall be paid for as Reinforcement Bars, Epoxy Coated.
 Cost of excavation for approach footing included with Concrete Structures.
 The approach footing maximum applied service bearing pressure (Q_{max}) = 2.0 ksf.
 For v(E) bar details, see Structural Sheet 12B of 33B.
 For bar splicer details, see Structural Sheet 29B of 33B.
 For Porous Granular Embankment and drainage treatment details, see Structural Sheet 4B of 33B.

**NORTH BRIDGE APPROACH SLAB DETAILS
 C.H. 8 OVER IOWA INTERSTATE RAILROAD
 & THE HENNEPIN CANAL
 STATION 36+00
 S.N. 006-3247
 WHA #1066D05**

STRUCTURAL SHEET NO. 16B OF 33B SHEETS	F.A.S. RTE.	SECTION	COUNTY	TOTAL SHEETS	SHEET NO.
	188	05-00195-00-BR	BUREAU	127	82
	CONTRACT NO. 87380				
FED. ROAD DIST. NO. 7 ILLINOIS FED. AID PROJECT BRS-0188(118)					

FILE NAME: s:\Struct\1066D05\Bureau\Drawings\1066Approach.dgn