

TRAFFIC DATA

STREET	ADT(2020)	%PV	%SU	%MU	CLASS	ROADWAY CLASSIFICATION
CROSAT STREET	2200	88	11	1	II	COLLECTOR
ELEVENTH STREET	10000	88	11	1	II	COLLECTOR

STATE OF ILLINOIS
DEPARTMENT OF TRANSPORTATION
DIVISION OF HIGHWAYS
PROPOSED
HIGHWAY PLANS

SURFACE TRANSPORTATION URBAN
CITY OF LASALLE
SECTION 08-00077-00-RS
PROJECT NO. M-5036(024)
JOB NO. C-93-102-09
ELEVENTH STREET (FAU 6086) &
CROSAT STREET (FAU 6109)
LASALLE COUNTY

INDEX OF SHEETS

1	Cover Sheet and Index of Sheets
2	Typ. Sections and Summary of Quantities
3-5	Plan View Eleventh Street
6-9	Plan View Crosat Street

Highway Standards	
000001-05	Standard Symbols, Abbreviations, and Patterns
424001-05	Curb Ramps For Sidewalks
606001-04	Concrete Curb Type B and Concrete Curb and Gutter
701501-05	Urban Lane Closure, 2L, 2W, Undivided
701801-04	Lane Closure Multilane 1w or 2w crosswalk or sidewalk closure
701901-01	Traffic Control Devices
780001-02	Typical Pavement Markings



LOCATION MAP

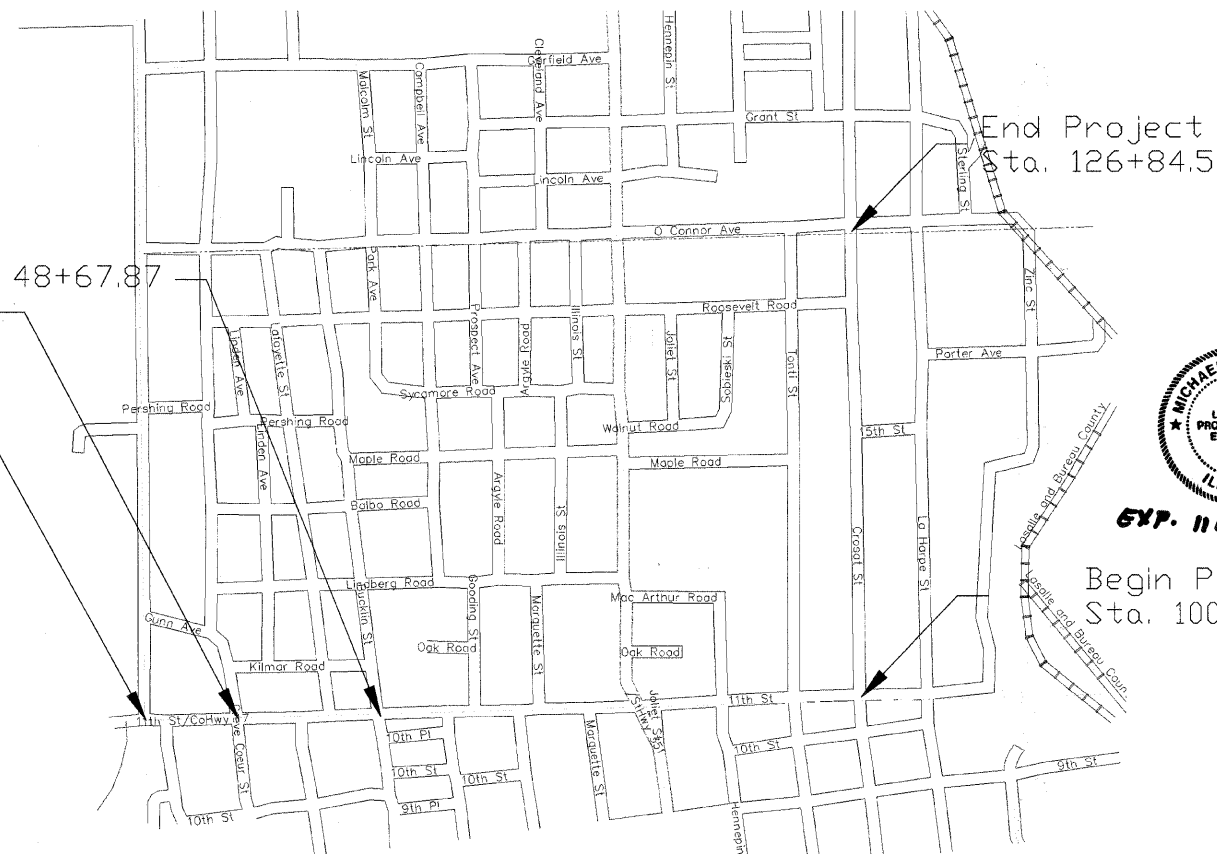

End Project Sta. 48+67.87
Sta. 34+83.17 back = Sta. 40+00 ahead
Begin Project Sta. 30+00

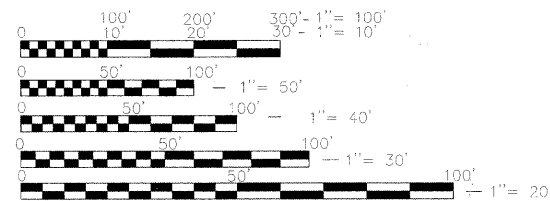

FULL SIZE PLANS HAVE BEEN PREPARED USING STANDARD ENGINEERING SCALES. REDUCED SIZED PLANS WILL NOT CONFORM TO STANDARD SCALES. IN MAKING MEASUREMENTS ON REDUCED PLANS, THE ABOVE SCALES MAY BE USED.

J.U.L.I.F.
JOINT UTILITY LOCATION INFORMATION FOR EXCAVATION
1-800-892-0123 OR 811

PROJECT ENGINEER—Michael Furlan

CONTRACT NO. 87394

GROSS LENGTH = 4032 FT. = 0.764 MILE
NET LENGTH = 4032 FT. = 0.764 MILE
APPROXIMATE SCALE: 1" = 1000'



EXP. 11/30/2011

Begin Project
Sta. 100+03.4

STATE OF ILLINOIS
DEPARTMENT OF TRANSPORTATION
DIVISION OF HIGHWAYS

SUBMITTED APRIL 2 20 10
Michael J. Furlan
CITY ENGINEER

PASSED 4-5 20 10
[Signature]
DISTRICT 3 IMPLEMENTATION ENGINEER

4-5 20 10
[Signature]
DEPUTY DIRECTOR OF HIGHWAYS, REGION 2 ENGINEER
RELEASING FOR BID BASED ON LIMITED REVIEW.

PRINTED BY THE AUTHORITY OF THE STATE OF ILLINOIS