

**DEAD LOAD DEFLECTION DIAGRAM**  
(Includes weight of concrete, excluding beams).

Note:  
The above deflections are not to be used in the field if the engineer is working from the grade elevations adjusted for dead load deflections as shown on Sheet 4 of 22.

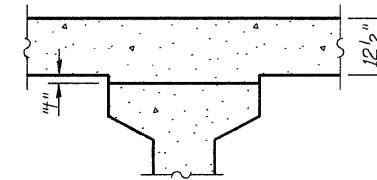

To determine "t": After all precast prestressed beams have been erected, elevations of the top flanges of the beams shall be taken at intervals shown below. These elevations subtracted from the "Theoretical Grade Elevations Adjusted for Dead Load Deflections" shown on Sh. 4 of 22, minus slab thickness, equals the fillet heights "t" above top flanges of beams.

**FILLET HEIGHTS**

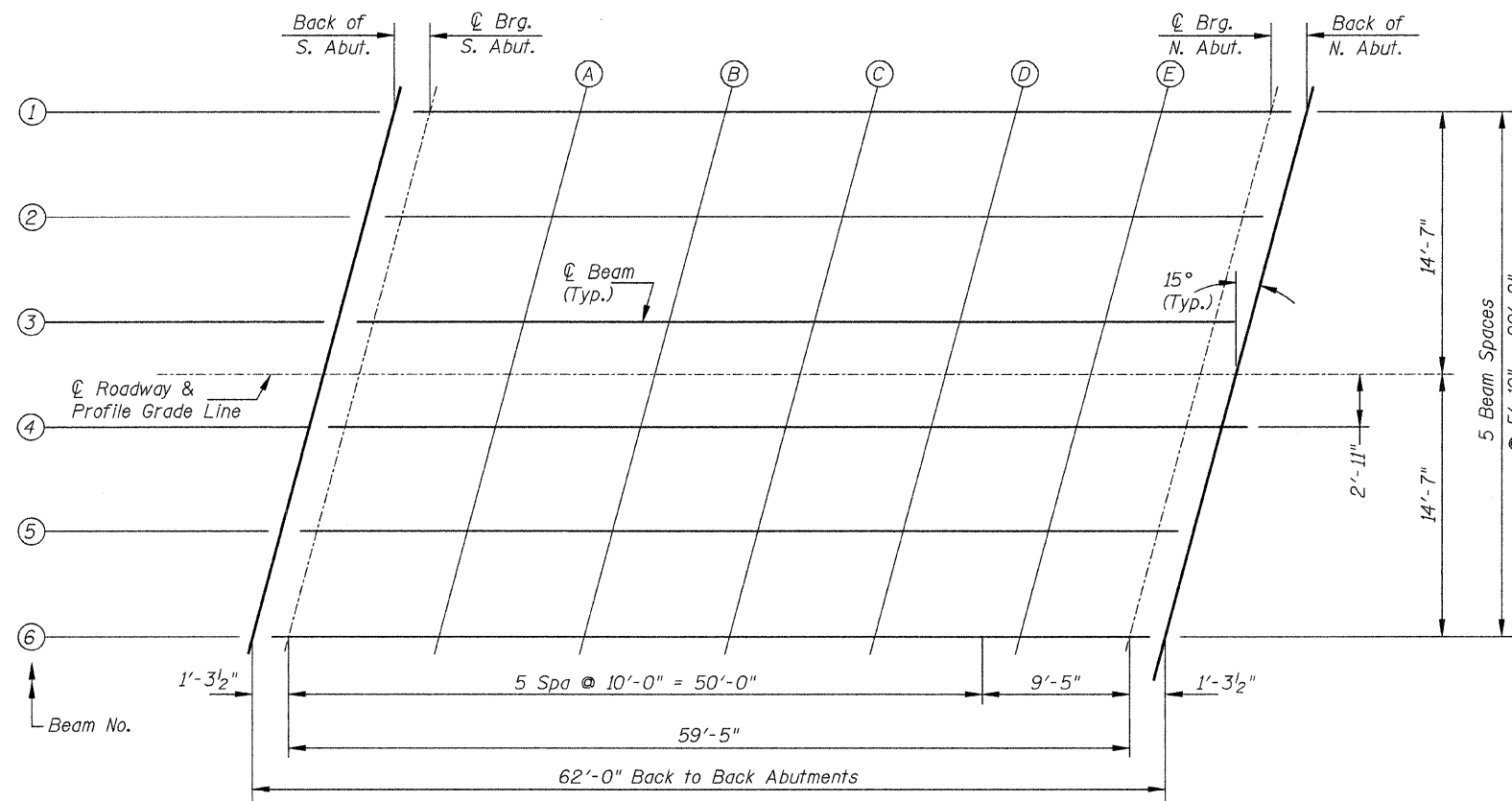

**PLAN (DECK ELEVATIONS)**

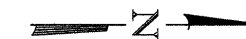

**TOP OF SLAB ELEVATIONS**

| SHEET NO. 3           | RTE.  | SECTION        | COUNTY                         | TOTAL SHEETS | SHEET NO. |
|-----------------------|-------|----------------|--------------------------------|--------------|-----------|
| 22 SHEETS             | CH 25 | 09-00658-00-BR | LASALLE                        | 39           | 10        |
| SN 050-3598           |       |                | CONTRACT NO. 87451             |              |           |
| FED. ROAD DIST. NO. 7 |       | ILLINOIS       | FED. AID PROJECT BRS-0271(103) |              |           |