

WEST CURB LINE OF APPROACH PAVEMENT

Location	Station	Offset	Theoretical Grade Elevations
End S. App. Pvm't.	1944.11	-16.00	656.18
A	1954.11	-16.00	656.18
B	1964.11	-16.00	656.17
Bk S. Abutment	1974.11	-16.00	656.17

WEST EDGE OF ROADWAY PAVEMENT

Location	Station	Offset	Theoretical Grade Elevations
End S. App. Pvm't.	1943.04	-12.00	656.27
A	1953.04	-12.00	656.26
B	1963.04	-12.00	656.26
Bk S. Abutment	1973.04	-12.00	656.25

Ⓞ ROADWAY & PROFILE GRADE

Location	Station	Offset	Theoretical Grade Elevations
End S. App. Pvm't.	1939.82	0.00	656.46
A	1949.82	0.00	656.45
B	1959.82	0.00	656.45
Bk S. Abutment	1969.82	0.00	656.44

EAST EDGE OF ROADWAY PAVEMENT

Location	Station	Offset	Theoretical Grade Elevations
End S. App. Pvm't.	1936.60	12.00	656.27
A	1946.60	12.00	656.27
B	1956.60	12.00	656.26
Bk S. Abutment	1966.60	12.00	656.25

EAST CURB LINE OF APPROACH PAVEMENT

Location	Station	Offset	Theoretical Grade Elevations
End S. App. Pvm't.	1935.53	16.00	656.19
A	1945.53	16.00	656.18
B	1955.53	16.00	656.18
Bk S. Abutment	1965.53	16.00	656.17

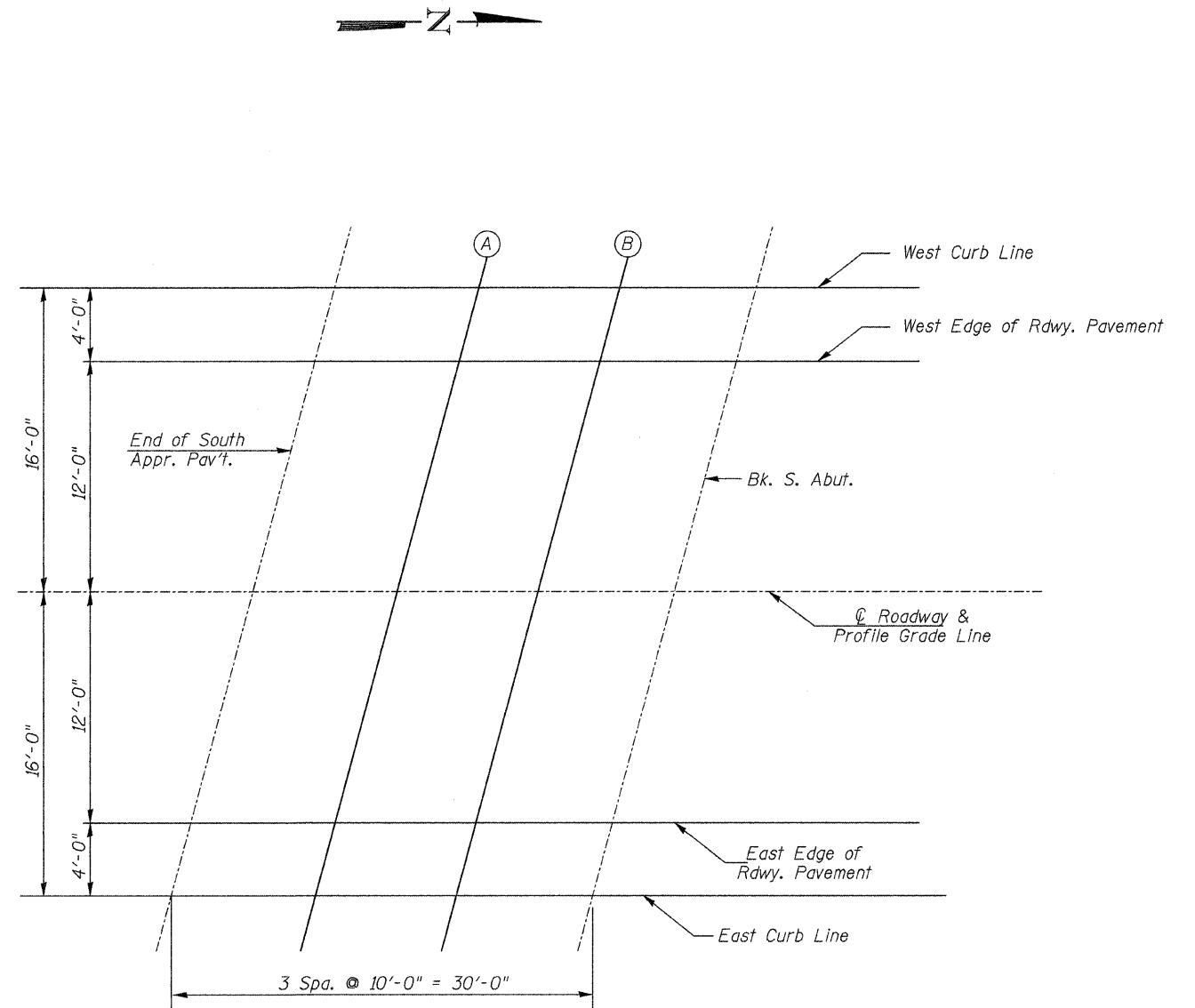

PLAN SOUTH APPROACH PAVEMENT

TOP OF SOUTH APPROACH PAVEMENT ELEVATIONS

SHEET NO. 5	RTE.	SECTION	COUNTY	TOTAL SHEETS	SHEET NO.
22 SHEETS	CH 25	09-00658-00-BR	LASALLE	39	12
SN 050-3598			CONTRACT NO. 87451		
FED. ROAD DIST. NO. 7 ILLINOIS			FED. AID PROJECT BRS-0271(103)		