

**INDEX OF SHEETS**

- SHEET 1. COVER SHEET
- SHEET 2. TYPICAL CROSS SECTION, SUMMARY OF QUANTITIES, BUTT JOINT DETAIL, BITUMINOUS MIXTURE TABLE
- SHEET 3. TYPICAL ENTRANCE DETAIL, MAILBOX DETAILS, SIDE ROAD RETURN, GENERAL NOTES

**STANDARDS**

- 701301-03 LANE CLOSURE 2 LANE, 2 WAY, SHORT TIME OPERATIONS
- 701306-02 LANE CLOSURE 2 LANE, 2 WAY, SLOW MOVING OPERATIONS - DAY ONLY FOR SPEEDS  $\geq$  45 MPH
- 701311-03 LANE CLOSURE 2 LANE, 2 WAY, MOVING OPERATIONS - DAY ONLY
- 701901-01 TRAFFIC CONTROL DEVICES
- 780001-02 TYPICAL PAVEMENT MARKINGS

STATE OF ILLINOIS  
DEPARTMENT OF TRANSPORTATION

**PLANS FOR  
PROPOSED LOCAL AGENCY IMPROVEMENT  
FEDERAL-AID SECONDARY PROJECT**

C.H. 26

F.A.S. ROUTE 340 SECTION 10-00112-00-RS FORD COUNTY  
PROJECT RS- 0340(104)  
JOB NO. C-93-085-10

FAS NO.	SECTION	COUNTY	TOTAL SHEETS	SHEET NO.
340	10-00112-00-RS		3	1
PROJECT RS - 0340(104) CONTRACT # 87454				

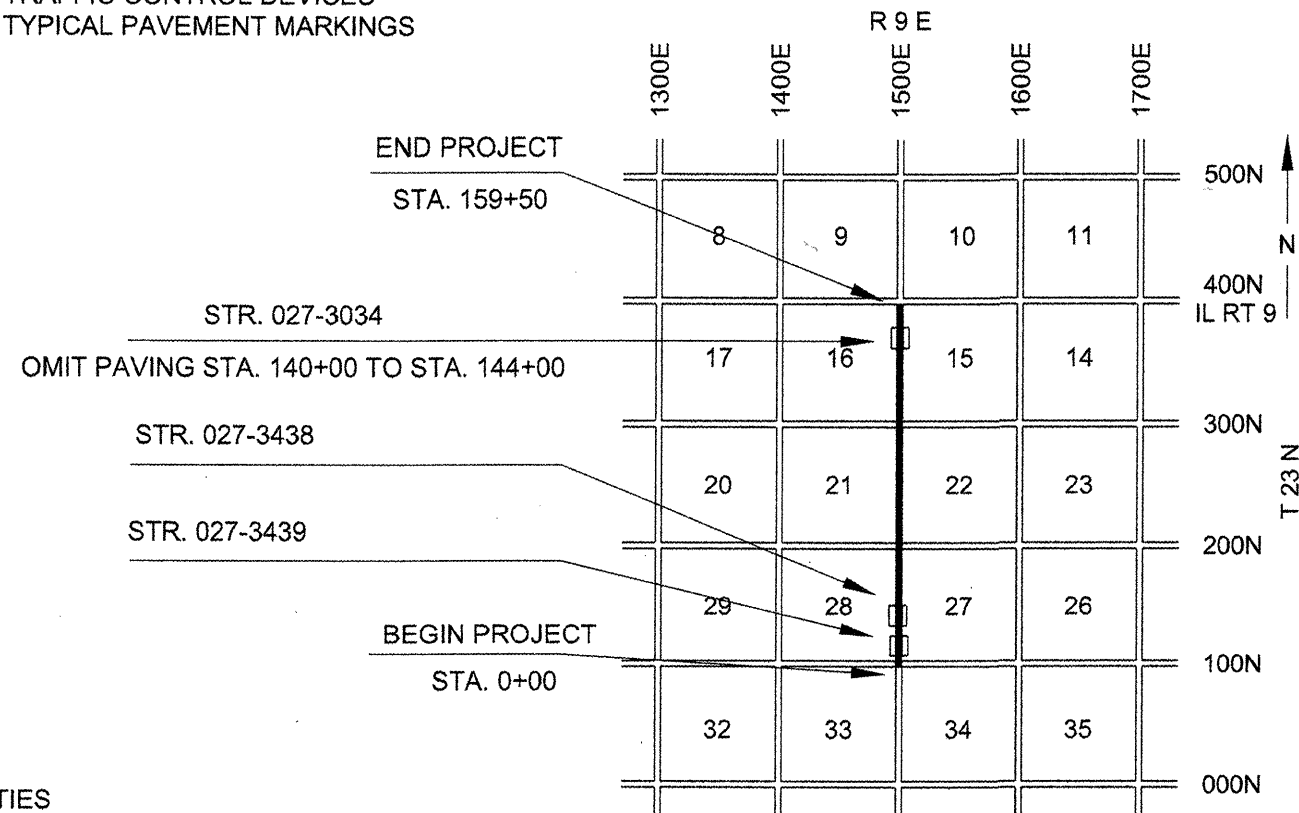

GROSS LENGTH = 15,950' = 3.02 MI.  
NET LENGTH = 15,550' = 2.95 MI.

THE PLANS FOR THIS SECTION WERE APPROVED BY THE DEPARTMENT  
AS SECTION 41-Q, SECTION 82-00041-00-RS,  
SECTION 10-00112-00-RS  
FUNCTIONAL CLASSIFICATION: MAJOR COLLECTOR

*Gregory L. Perkinson*  
ILLINOIS PROFESSIONAL NO. 062-035801

EXPIRES 11-30-2011

**UTILITIES**

UTILITIES ON THIS SECTION AT VARIOUS LOCATIONS INCLUDES TO THE BEST OF OUR KNOWLEDGE:

VERIZON TELEPHONE COMPANY (UNDERGROUND)  
OVERHEAD POWER - EASTERN ILLINI

CONTRACTORS OR SUBCONTRACTORS SHALL CONTACT J.U.L.I.E. (1-800-892-0123) AT LEAST 72 HOURS PRIOR TO ANY EXCAVATION OR DRIVING FOR UTILITIES LOCATION

JOB NO. C-93-085-10  
CONTRACT NO. 87454

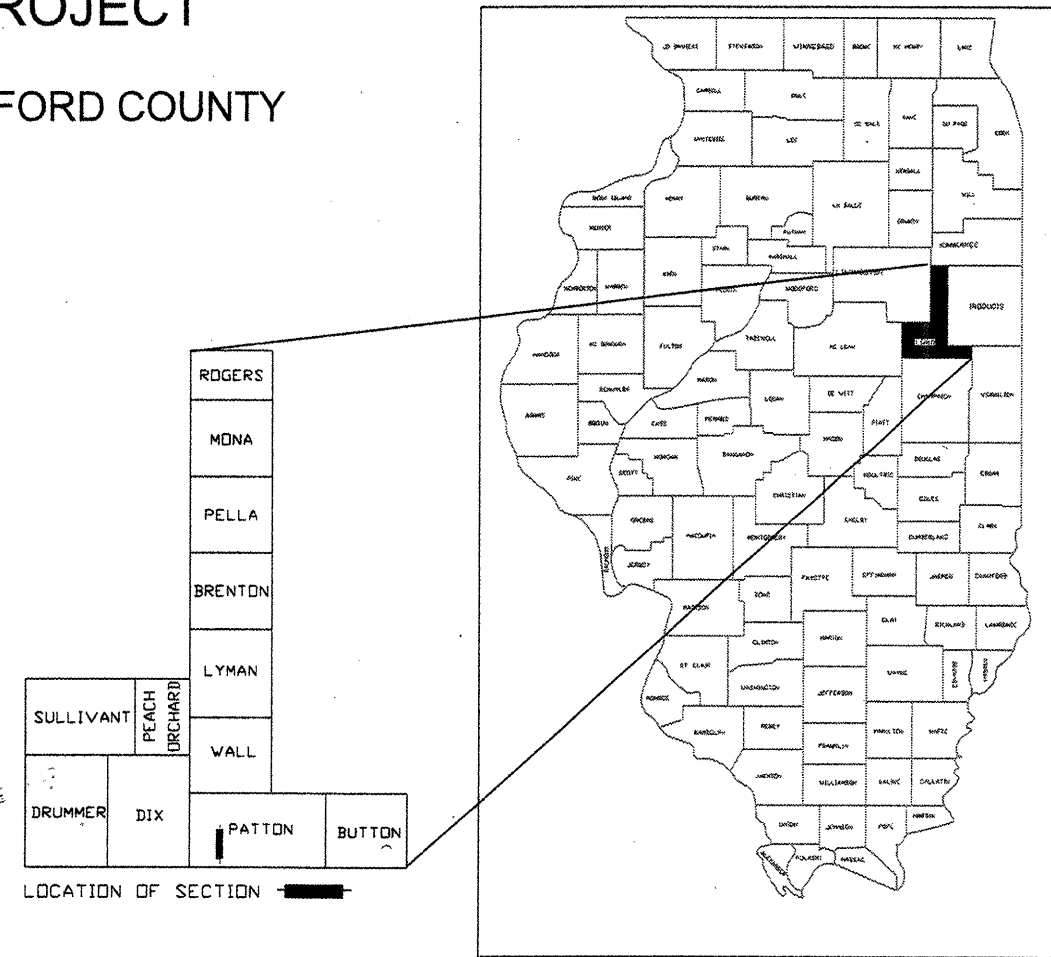

CURRENT (2010) ADT = 225 - 88% PC  
9% SU  
3% MU  
DESIGN ADT (2020) = 300  
DESIGN SPEED = 50 MPH

THE ACCEPTANCE OF THIS PROJECT IS BASED ON THE MINIMUM DESIGN CRITERIA UNDER 3R GUIDELINES.

APPROVED	<u>4/09/2010</u> <i>Gregory L. Perkinson</i> FORD COUNTY, COUNTY ENGINEER
PASSED	<u>4-9-10</u> <i>Gregory L. Perkinson</i> DISTRICT 3 IMPLEMENTATION ENGINEER
Releasing for Bid Based on Limited Review	<u>4-9-10</u> <i>Boye Myung</i> DEPUTY DIRECTOR OF HIGHWAYS, REGION 2 ENGINEER STATE OF ILLINOIS DEPARTMENT OF TRANSPORTATION

