

RAIL POST SPACING

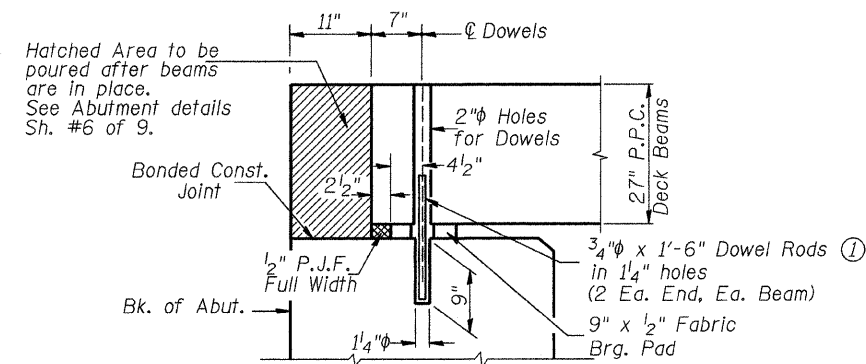

SECTION THRU ABUTMENT
(At Right Angles)

① Dowel Rods to be grouted after beams are in place and allowed to cure (Min. 24 hr.) prior to grouting the shear keys.

**SUPERSTRUCTURE DETAILS
AND RAIL POST SPACING
IROQUOIS COUNTY
SECTION 02-01122-00-BR
T.R. 14A OVER LOUIS CREEK**

| | | | | | |
|-----------------------------|---------------|----------------|---------------------------------|--------------|-----------|
| SHEET NO. 5 9 SHEETS | ROUTE NO. | SECTION | COUNTY | TOTAL SHEETS | SHEET NO. |
| | TR 14A | 02-01122-00-BR | IROQUOIS | 22 | 11 |
| | S.N. 038-3062 | | CONTRACT NO. 87460 | | |
| FED. ROAD DIST. NO. 7 | | ILLINOIS | FED. AID PROJECT BR05-0075(138) | | |