

F.A.P. RTE.	SECTION	COUNTY	TOTAL SHEETS	SHEET NO.
399	36R-1,37R-2	TAZEWELL	449	69
STA 7+663.000		TO STA 10+097.000		
FED. ROAD DIST. NO. 4		ILLINOIS FED. AID PROJECT		

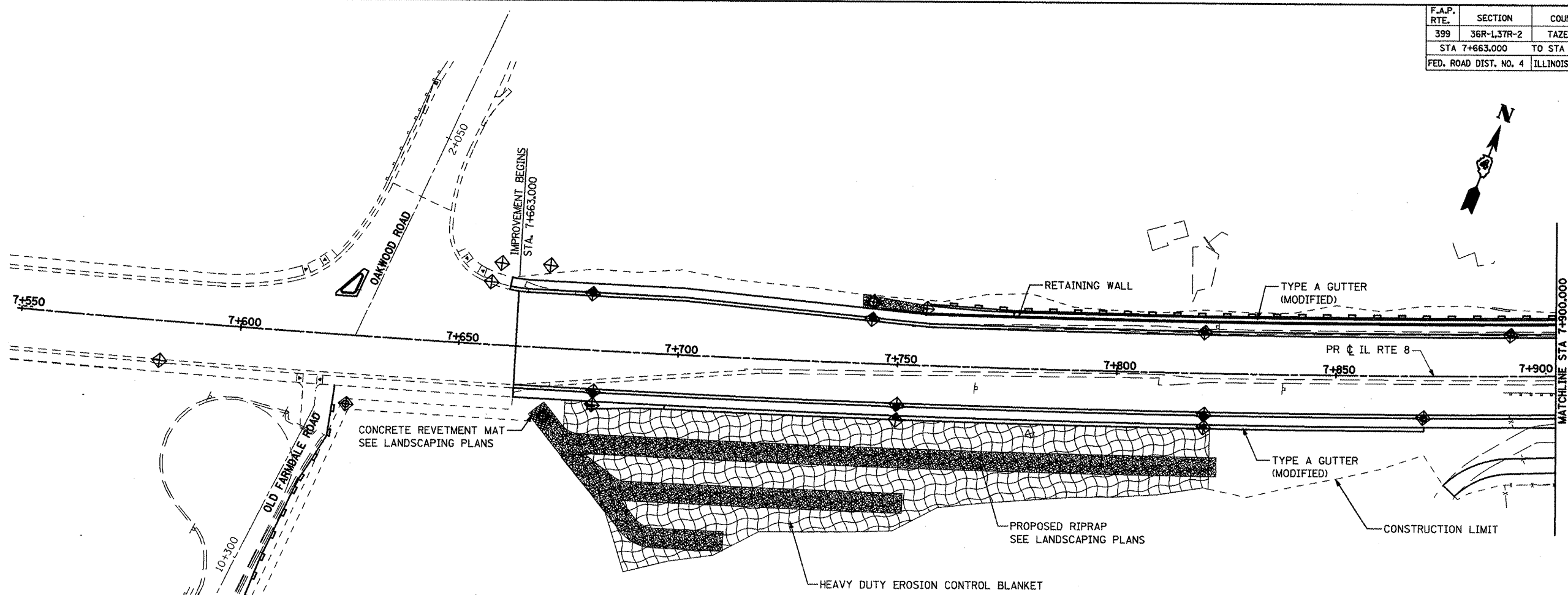

NOTES:

1. THE CONTRACTOR SHALL APPLY EROSION CONTROL MEASURES PRIOR TO ANY EARTH DISTURBING ACTIVITIES.
2. ALL EROSION CONTROL FEATURES SHALL REMAIN IN PLACE AND BE MAINTAINED FOR THE DURATION OF THE CONSTRUCTION PERIOD OR AS DIRECTED BY THE ENGINEER.
3. PERIMETER EROSION BARRIER OR SILT FENCE SHALL BE PLACED AT LOCATIONS SHOWN ON THE PLANS OR AS DIRECTED BY THE ENGINEER WHERE THE SLOPE IS SUCH THAT SOIL WILL WASH AWAY FROM THE PROJECT LIMITS.
4. TEMPORARY DITCH CHECKS SHALL BE PLACED IN ALL EXISTING AND PROPOSED DITCHES, AT EVERY 0.3m DROP IN ELEVATION.
5. PROPOSED INLETS AND PIPES SHOULD BE PROTECTED IMMEDIATELY AFTER THEY ARE CONSTRUCTED. THIS PROTECTION SHALL BE PLACED AS SHOWN ON THE PLANS OR AS DIRECTED BY ENGINEER.
6. ALL EXISTING INLETS AND PIPES WITHIN LIMITS OF CONSTRUCTION OR WHICH WILL RECEIVE RUNOFF FROM DISTURBED AREAS WILL BE PROTECTED AS SHOWN ON THE PLANS AND AS DIRECTED BY THE ENGINEER.
7. INLET AND PIPE PROTECTIONS SHALL STAY IN PLACE UNTIL SURFACES THAT DRAIN TO THEM ARE PAVED OR REVEGETATED.

8. THE CONTRACTOR SHALL ACQUIRE THE NPDES PERMIT BEFORE BEGINNING CONSTRUCTION.
9. ALL ITEMS SHALL BE CONSTRUCTED AS SHOWN ON STANDARD 280001 AND AS DIRECTED BY THE ENGINEER. MAINTENANCE AND CLEANING OF THE EROSION CONTROL ITEMS SHALL BE INCLUDED IN THE RESPECTIVE EROSION CONTROL PAY ITEM.
10. ALL CONSTRUCTION ACTIVITIES SHALL BE IN ACCORDANCE WITH THE NATIONAL POLLUTANT DISCHARGE ELIMINATION SYSTEM STORM WATER PERMIT.
11. THE CONTRACTOR SHALL TAKE ALL PRECAUTIONS TO PREVENT POLLUTION OF STORM WATER AND SHALL FOLLOW IEPA & IDOT CONSTRUCTION MEMORANDUM NO. 00-60.
12. EROSION CONTROL SHALL BE PROVIDED IN ACCORDANCE WITH THE SEQUENCE OF STAGE CONSTRUCTION.
13. FOR MORE INFO ON STAGE CONSTRUCTION, SEE MOT PLANS.
14. EXCAVATED AREAS AND EMBANKMENT SHALL BE PERMANENTLY SEEDED IMMEDIATELY AFTER FINAL GRADING. IF NOT, THEY SHALL BE TEMPORARILY SEEDED IF NO CONSTRUCTION ACTIVITY IN THE AREA IS PLANNED FOR 7 DAYS.

LEGEND:

- INLET AND PIPE PROTECTION
- PERIMETER EROSION BARRIER
- TEMPORARY DITCH CHECK
- DITCH FLOW
- SWALE
- CONSTRUCTION LIMITS

NOTES:

1. FOR MORE DRAINAGE INFORMATION SEE DRAINAGE AND UTILITIES PLANS.
2. PERIMETER EROSION BARRIER IS LOCATED ON TEMP. EASEMENT/PERM. EASEMENT/R.O.W. LINE ON THE NORTH AND SOUTH SIDES OF THE MAINLINE AS SHOWN ON THE PLANS.
3. FOR PERMANENT EROSION CONTROL INFORMATION SEE LANDSCAPING PLANS.

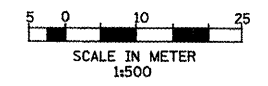

REVISIONS	
NAME	DATE
LCE	3-10-10

ILLINOIS DEPARTMENT OF TRANSPORTATION
ILLINOIS ROUTE 8 - SEGMENT 2
TEMPORARY EROSION CONTROL PLAN
STA 7+550 TO STA 7+900

SCALE: 1:500
DATE: DECEMBER, 2003

DRAWN BY: RDT
CHECKED BY: SAE