

F.A.P. RTE.	SECTION	COUNTY	TOTAL SHEETS	SHEET NO.
399	36R-1.37R-2	TAZEWELL	449	72
STA 7+663.000		TO STA 10+097.000		
FED. ROAD DIST. NO. 4		ILLINOIS FED. AID PROJECT		

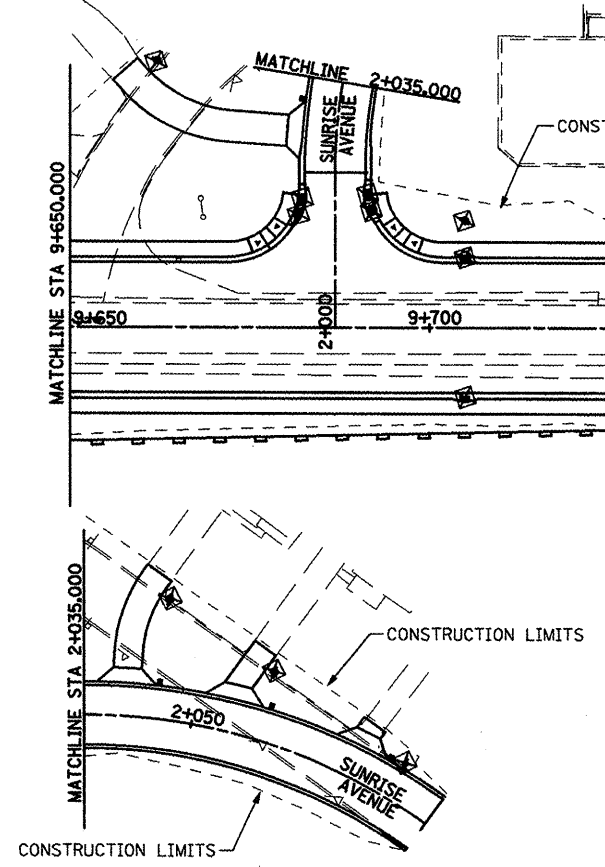
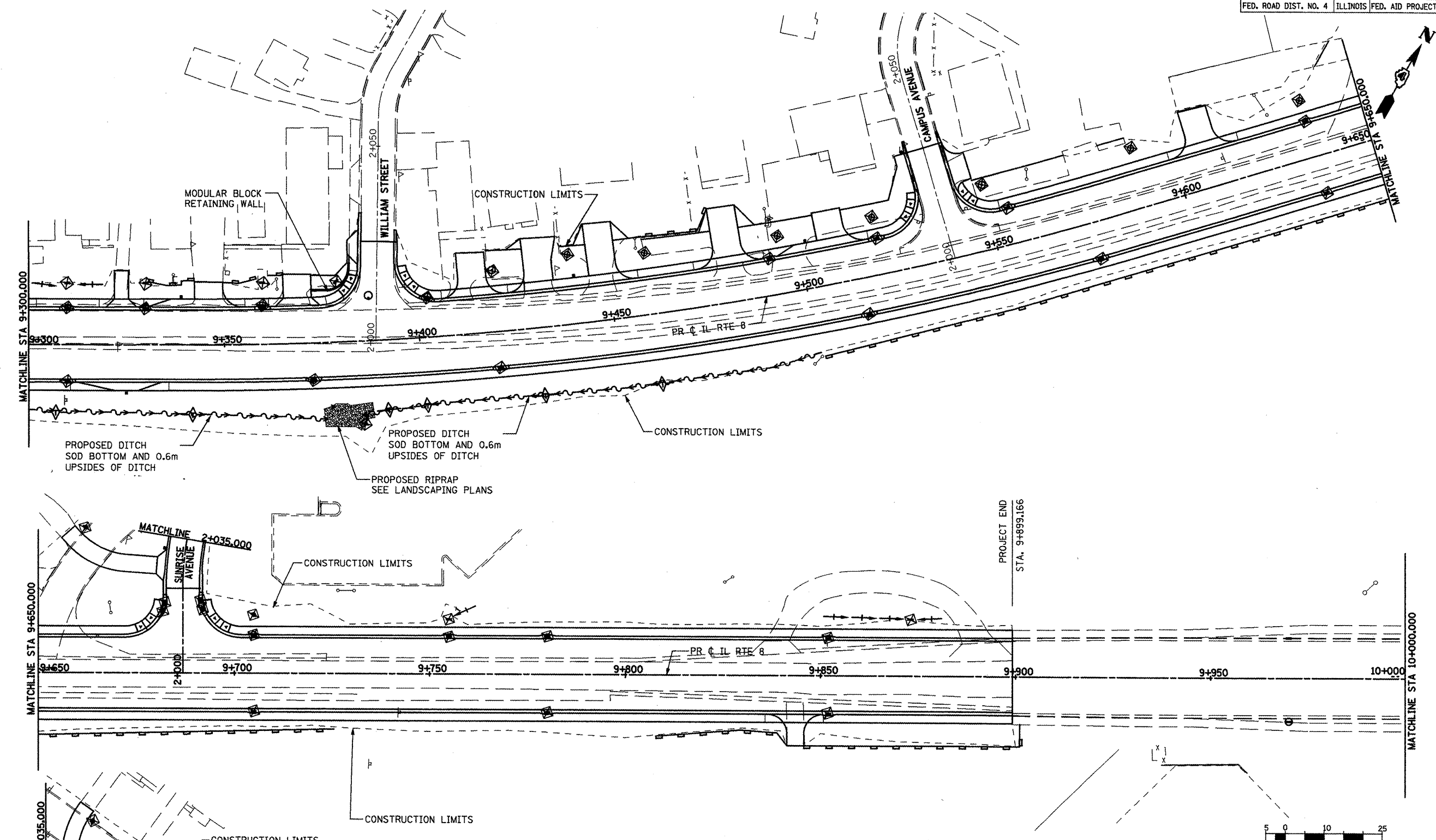

**NOTES:**

1. FOR MORE DRAINAGE INFORMATION SEE DRAINAGE AND UTILITIES PLANS.
2. PERIMETER EROSION BARRIER IS LOCATED ON TEMP. EASEMENT/PERM. EASEMENT/R.O.W. LINE ON THE NORTH AND SOUTH SIDES OF THE MAINLINE AS SHOWN ON THE PLANS.
3. FOR PERMANENT EROSION CONTROL INFORMATION SEE LANDSCAPING PLANS.

**LEGEND:**

- ◆ INLET AND PIPE PROTECTION
- ▬ PERIMETER EROSION BARRIER
- ◇ TEMPORARY DITCH CHECK
- DITCH FLOW
- SWALE
- - - CONSTRUCTION LIMITS

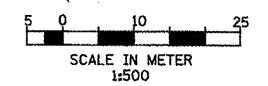

REVISIONS	
NAME	DATE
LCE	3-10-10

ILLINOIS DEPARTMENT OF TRANSPORTATION  
**ILLINOIS ROUTE 8 - SEGMENT 2**  
**TEMPORARY EROSION CONTROL PLAN**  
**STA 9+300 TO STA 10+000**

SCALE: 1:500  
DATE: DECEMBER, 2003

DRAWN BY: ROT  
CHECKED BY: SAE