

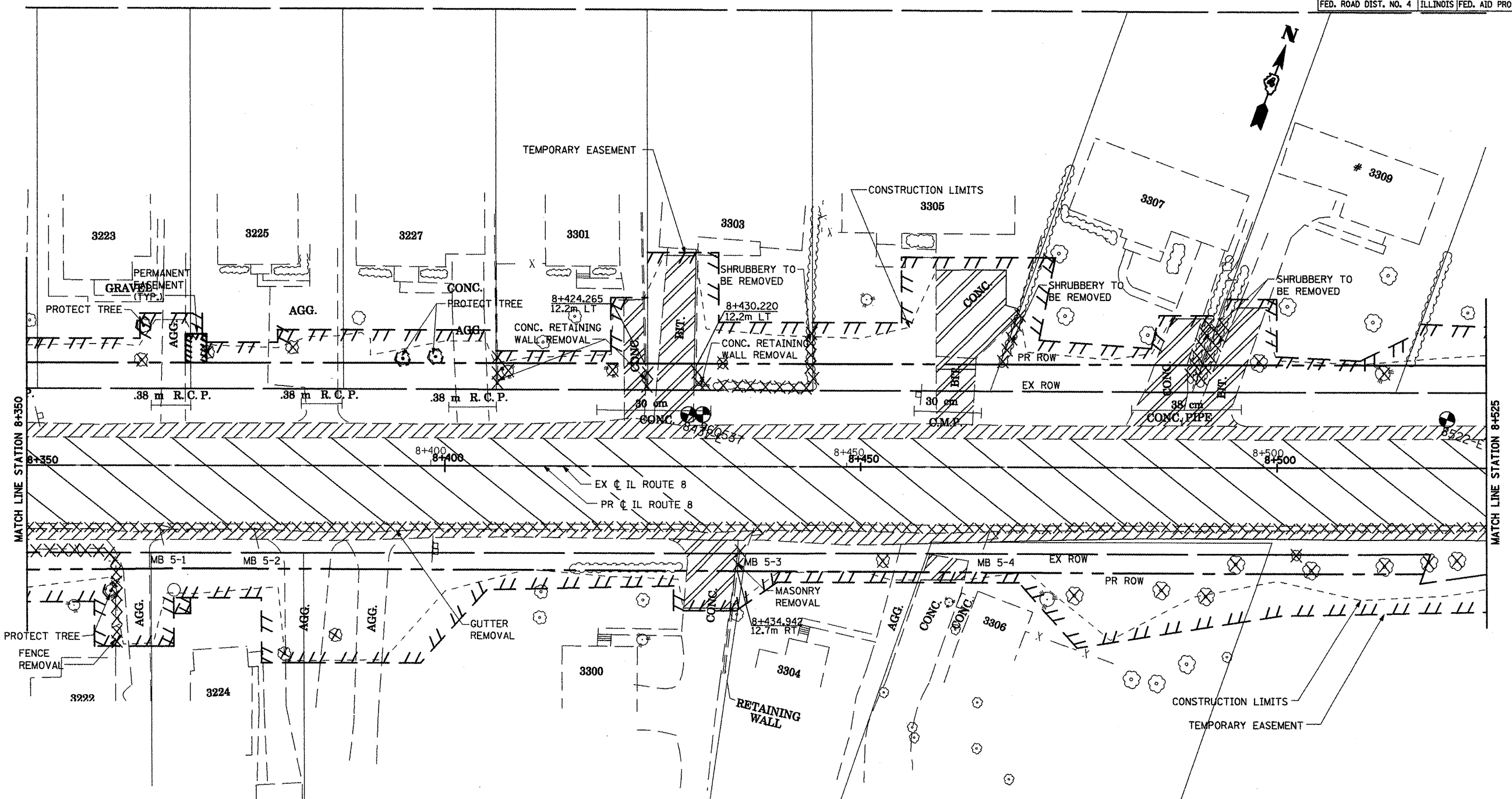

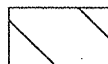

F.A.P. RTE.	SECTION	COUNTY	TOTAL SHEETS	SHEET NO.
399	36R-1,37R-2	TAZEWELL	449	81
STA 7+663.000		TO STA 10+097.000		
FED. ROAD DIST. NO. 4		ILLINOIS FED. AID PROJECT		

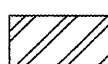
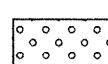
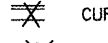

- LEGEND:**
-  PAVEMENT REMOVAL
 -  PAVED SHOULDER REMOVAL
 -  DRIVEWAY PAVEMENT REMOVAL
 -  REMOVAL AND DISPOSAL OF UNSUITABLE MATERIAL
 -  CURB AND GUTTER REMOVAL
 -  TREE REMOVAL
 -  SOIL BORING
 -  MAILBOX TO BE RELOCATED

NOTE:
 SEE DRAINAGE AND UTILITIES PLAN SHEETS
 FOR EXISTING PIPE, CULVERTS AND STRUCTURE
 REMOVALS AND FOR LOCATION OF EXISTING UTILITIES.

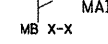
REVISIONS	
NAME	DATE

ILLINOIS DEPARTMENT OF TRANSPORTATION
 ILLINOIS ROUTE 8 - SEGMENT 2
 EXISTING PLAN AND REMOVALS
 STA. 8+350 TO STA. 8+525

SCALE: 1:250
 DATE: DECEMBER, 2003

DRAWN BY: RLK
 CHECKED BY: SAE

