

F.A.P. RTE.	SECTION	COUNTY	TOTAL SHEETS	SHEET NO.
399	36R-1.37R-2	TAZEWELL	449	82
STA 7+663.000		TO STA 10+097.000		
FED. ROAD DIST. NO. 4		ILLINOIS FED. AID PROJECT		

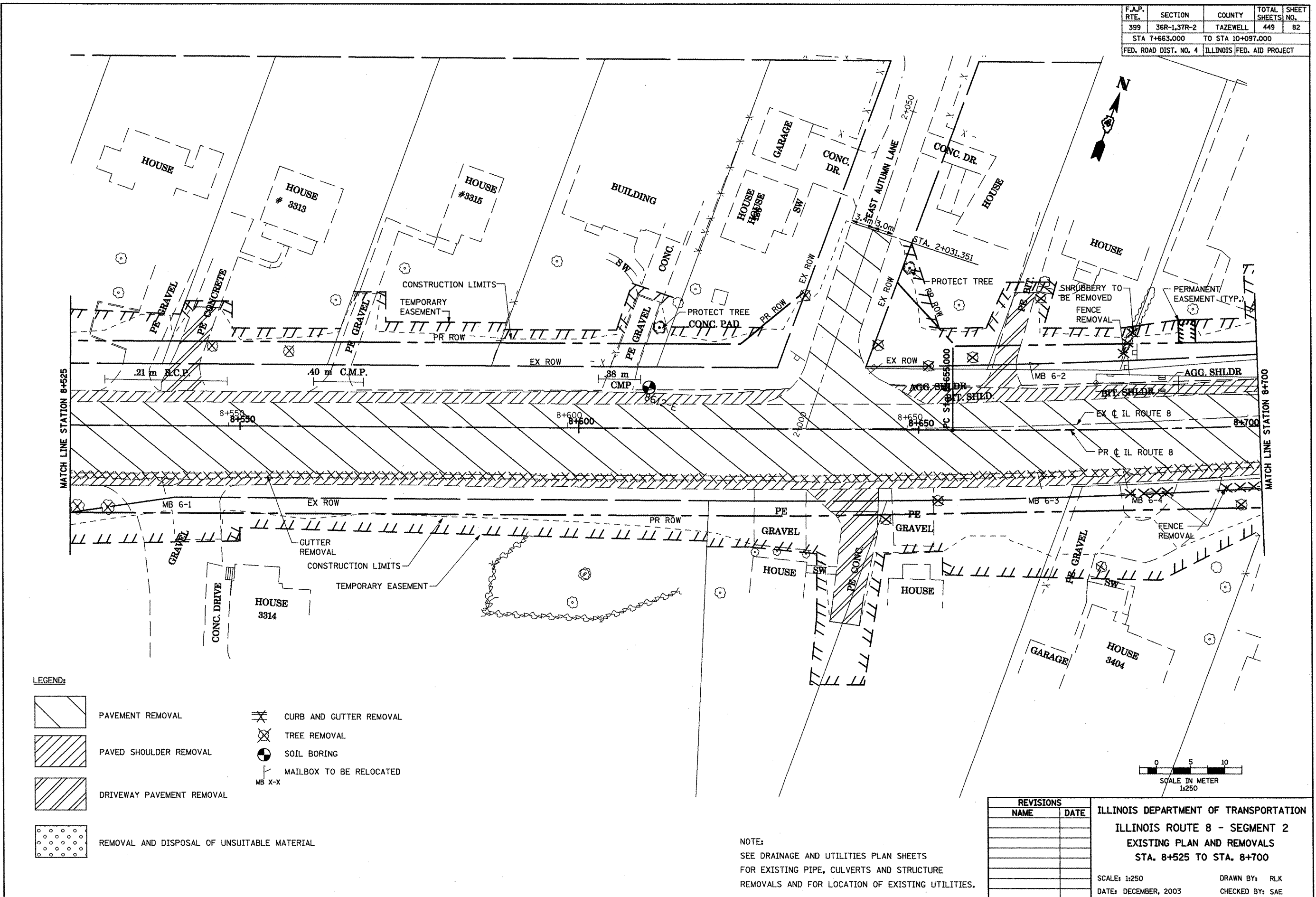

LEGEND:

	PAVEMENT REMOVAL		CURB AND GUTTER REMOVAL
	PAVED SHOULDER REMOVAL		TREE REMOVAL
	DRIVEWAY PAVEMENT REMOVAL		SOIL BORING
	REMOVAL AND DISPOSAL OF UNSUITABLE MATERIAL		MAILBOX TO BE RELOCATED

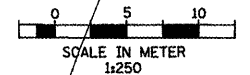

NOTE:  
 SEE DRAINAGE AND UTILITIES PLAN SHEETS  
 FOR EXISTING PIPE, CULVERTS AND STRUCTURE  
 REMOVALS AND FOR LOCATION OF EXISTING UTILITIES.

REVISIONS	
NAME	DATE

ILLINOIS DEPARTMENT OF TRANSPORTATION  
 ILLINOIS ROUTE 8 - SEGMENT 2  
 EXISTING PLAN AND REMOVALS  
 STA. 8+525 TO STA. 8+700  
 SCALE: 1:250  
 DATE: DECEMBER, 2003  
 DRAWN BY: RLK  
 CHECKED BY: SAE